



MYG General Series		D05	D07	D10	D14	D20
Page		P9~P29	P9~P29	P9~P29	P9~P29	P9~P29
Diameter	(mm)	5	7	10	14	20
Varistor Voltage	$V_N$ (V)	18~750	18~750	18~1800	18~1800	18~1800
Peak Current (8/20 $\mu$ s)	$I_{max}$ (kA)	0.1~0.8	0.25~1.75	0.5~3.5	1.0~6.0	2.0~10.0
Max Energy Absorption (2ms)	$W_{max}$ (J)	0.3~18	0.8~32	1.7~110	3.2~360	10~720
Max Power Rating	$P_{max}$ (W)	0.01~0.1	0.02~0.25	0.05~0.4	0.1~0.6	0.2~1.0



MYH High Performance Series		D14	D20	Q14	Q20
Page		P31~P36	P31~P36	P31~P36	P31~P36
Diameter	(mm)	14	20	14*14	20*20
Varistor Voltage	$V_N$ (V)	200~510	200~510	200~510	200~510
Peak Current (8/20 $\mu$ s)	$I_{max}$ (kA)	8.0	12.0	8.0	15.0
Max Energy Absorption (2ms)	$W_{max}$ (J)	45~130	90~220	75~185	100~255
Max Power Rating	$P_{max}$ (W)	0.6	1.0	0.6	1.0



MYL Lightning Protection Series		D25	D32	Q34	D40	D53
Page		P37~P56	P37~P56	P37~P56	P37~P56	P37~P56
Diameter	(mm)	25	32	34*34	40	53
Varistor Voltage	$V_N$ (V)	200~1600	200~1600	200~1600	200~1800	200~1600
Peak Current (8/20 $\mu$ s)	$I_{max}$ (kA)	15	25	40	40	70
Max Energy Absorption (2ms)	$W_{max}$ (J)	150~725	210~900	310~1400	310~1400	490~2278
Max Power Rating	$P_{max}$ (W)	1.0	1.2	1.4	1.4	1.5



MYE High Duty Series		E20	E30	E40	E70
Page		P57-P71	P57-P71	P57-P71	P57-P71
Diameter	(mm)	25	32	34*34	60
Varistor Voltage	$V_N$ (V)	200~1200	200~1200	200~1200	200~4700
Peak Current (8/20 $\mu$ s)	$I_{max}$ (kA)	20	30	40	70
Max Energy Absorption (2ms)	$W_{max}$ (J)	150~525	210~760	310~1100	490~1800
Max Power Rating	$P_{max}$ (W)	1.0	1.2	1.4	1.6



MYP High Energy Disc Varistor Series		Q34	D32	D40	D53
Page		P73-P82	P73-P82	P73-P82	P73-P82
Diameter	(mm)	34*34	32	40	53
Varistor Voltage	$V_N$ (V)	200~1600	200~1600	200~1600	200~1600
Peak Current (8/20 $\mu$ s)	$I_{max}$ (kA)	40	25	40	70
Max Energy Absorption (2ms)	$W_{max}$ (J)	310~1400	210~900	310~1400	490~2278
Max Power Rating	$P_{max}$ (W)	1.4	1.2	1.4	1.5



PA Series		D20
Page		P83-P87
Diameter	(mm)	20
Varistor Voltage	$V_N$ (V)	82~1800
Peak Current (8/20 $\mu$ s)	$I_{max}$ (kA)	10
Max Energy Absorption (2ms)	$W_{max}$ (J)	40~720
Max Power Rating	$P_{max}$ (W)	1.0

TMOV Thermo Cutoff Series		D20	D25	D32
Page		P89-P97	P89-P97	P89-P97
Diameter	(mm)	20	25	32
Varistor Voltage	$V_N$ (V)	82~1100	200~1100	200~1100
Peak Current (8/20 $\mu$ s)	$I_{max}$ (kA)	8	12	20
Max Energy Absorption (2ms)	$W_{max}$ (J)	40~440	150~525	220~760
Max Power Rating	$P_{max}$ (W)	1.0	1.0	1.2

## Products Description

MYG varistors are designed for electronic circuit, which has standard electrode lead mounted with PCB. With excellent surge protection ability, it is widely used in various fields of electric technology and electronic products, such as computer, power supply, household appliance, telecommunication, network and automobile, etc.

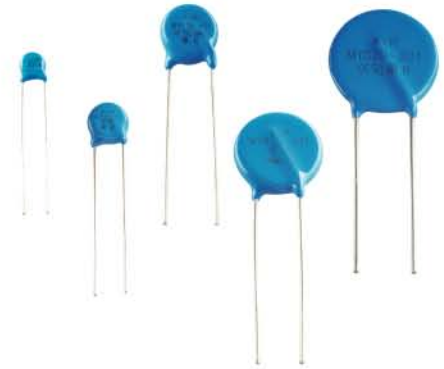

## Construction and Features

- Construction: Round varistors element, leaded and coated;
- Coating materials: Epoxy resin, flame retardant to UL94V-0;
- Terminals: Tinned copper wire;
- Package: Bulk, Reel or Ammopack.

## Approvals:

With safety certifications of UL, VDE, CSA, CE, etc.

## Key Characteristic Parameters:

Max AC Operating Voltage	$V_{RMS}(V)$	11~1000
Max Energy Absorption	$W_{max}(J)$	0.3~720
Peak Current (8/20 $\mu$ s)	$I_{max}(kA)$	0.1~10
MOV Diameter	D(mm)	5~20

## Technical Data:

Characteristics	Parameters:	Standards
Climatic Category LCT UCT	40/85/56 -40℃ +85℃	IEC68-2-3
Operating Temperature	-40℃ ~ +85℃	CECC 42 000
Storage Temperature	-40℃ ~ +125℃	
Electric Strength	≥ 2500V(AC)	CECC 42 000
Insulation Resistance	≥ 10MΩ	CECC 42 000
Response Time	<25 ns	

## Type Designation:

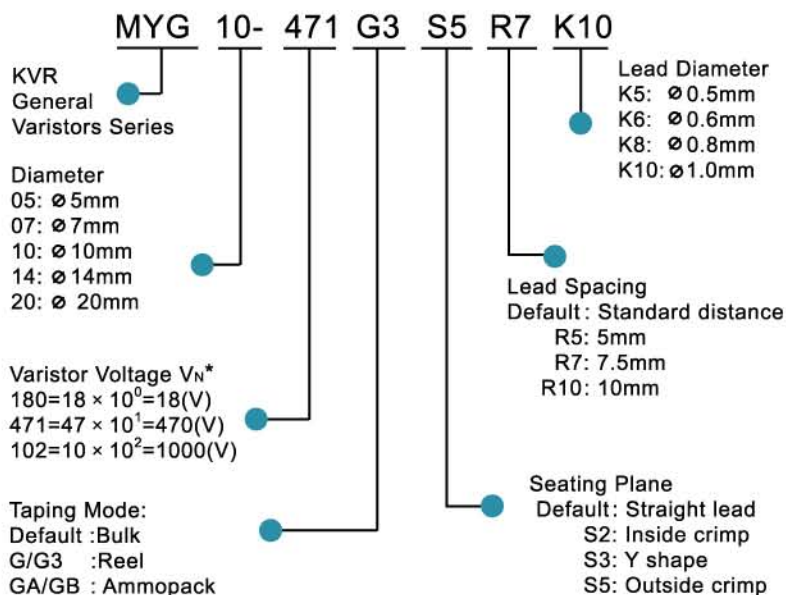

## Material Code Designation:

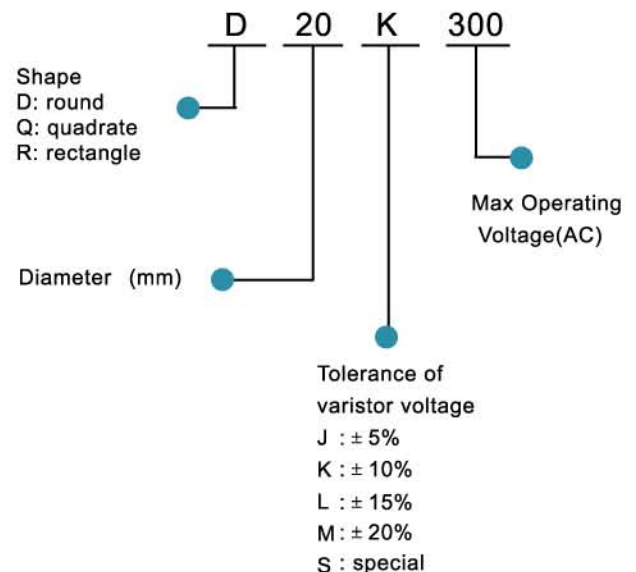

$V_N^*$  means  $\varnothing$  5mm are tested by constant current of 0.1mA.  
 $\varnothing$  7~20mm are tested by constant current of 1.0mA.



Type	Material code	Characteristics TA = +25 °C					Maximum ratings T =+85 C					V/I Characteristic curve	Derating Curve
		Varistor voltage	Tolerance	Clamping voltage at Ip (8/20µs)		Capacitance (1kHz)	Max continuous operating voltage		Max energy absorption (2ms)	Peak current (8/20µs)	Max power rating		
				VN* (V)	ΔVN (±%)		Vp (V)	Ip (A)				C (pF)	VRMS (V)
MYG05-180	D05K11	18	10	40	1.0	1600	11	14	0.3	125	0.01	18	23
MYG07-180	D07K11	18	10	36	2.0	3800	11	14	0.8	250	0.02	19	23
MYG10-180	D10K11	18	10	36	5.0	16000	11	14	1.7	500	0.05	20	24
MYG14-180	D14K11	18	10	36	10.0	25000	11	14	3.2	1000	0.10	21	24
MYG20-180	D20K11	18	10	36	20.0	40000	11	14	10.0	2000	0.20	22	25
MYG05-220	D05K14	22	10	48	1.0	1500	14	18	0.4	125	0.01	18	23
MYG07-220	D07K14	22	10	43	2.0	3600	14	18	0.9	250	0.02	19	23
MYG10-220	D10K14	22	10	43	5.0	11000	14	18	2.0	500	0.05	20	24
MYG14-220	D14K14	22	10	43	10.0	20000	14	18	4.0	1000	0.10	21	24
MYG20-220	D20K14	22	10	43	20.0	30000	14	18	12.0	2000	0.20	22	25
MYG05-270	D05K17	27	10	60	1.0	1450	17	22	0.5	125	0.01	18	23
MYG07-270	D07K17	27	10	53	2.0	3400	17	22	1.1	250	0.02	19	23
MYG10-270	D10K17	27	10	53	5.0	8000	17	22	2.5	500	0.05	20	24
MYG14-270	D14K17	27	10	53	10.0	16000	17	22	5.0	1000	0.10	21	24
MYG20-270	D20K17	27	10	53	20.0	24500	17	22	14.0	2000	0.20	22	25
MYG05-330	D05K20	33	10	73	1.0	1400	20	26	0.6	125	0.01	18	23
MYG07-330	D07K20	33	10	65	2.0	2900	20	26	1.3	250	0.02	19	23
MYG10-330	D10K20	33	10	65	5.0	6300	20	26	3.1	500	0.05	20	24
MYG14-330	D14K20	33	10	65	10.0	12200	20	26	6.0	1000	0.10	21	24
MYG20-330	D20K20	33	10	65	20.0	20000	20	26	18.0	2000	0.20	22	25
MYG05-390	D05K25	39	10	86	1.0	700	25	31	0.7	125	0.01	18	23
MYG07-390	D07K25	39	10	77	2.0	1600	25	31	1.6	250	0.02	19	23
MYG10-390	D10K25	39	10	77	5.0	5200	25	31	3.7	500	0.05	20	24
MYG14-390	D14K25	39	10	77	10.0	7000	25	31	7.0	1000	0.10	21	24
MYG20-390	D20K25	39	10	77	20.0	13800	25	31	22.0	2000	0.20	22	25
MYG05-470	D05K30	47	10	104	1.0	650	30	38	0.9	125	0.01	18	23
MYG07-470	D07K30	47	10	93	2.0	1550	30	38	2.0	250	0.02	19	23
MYG10-470	D10K30	47	10	93	5.0	4600	30	38	4.4	500	0.05	20	24
MYG14-470	D14K30	47	10	93	10.0	6750	30	38	9.0	1000	0.10	21	24
MYG20-470	D20K30	47	10	93	20.0	13500	30	38	26.0	2000	0.20	22	25
MYG05-560	D05K35	56	10	123	1.0	600	35	45	1.1	125	0.01	18	23
MYG07-560	D07K35	56	10	110	2.0	1500	35	45	2.5	250	0.02	19	23
MYG10-560	D10K35	56	10	110	5.0	3750	35	45	5.4	500	0.05	20	24
MYG14-560	D14K35	56	10	110	10.0	6500	35	45	10.0	1000	0.10	21	24
MYG20-560	D20K35	56	10	110	20.0	12200	35	45	33.0	2000	0.20	22	25
MYG05-680	D05K40	68	10	150	1.0	580	40	56	1.3	125	0.01	18	23
MYG07-680	D07K40	68	10	135	2.0	1200	40	56	3.0	250	0.02	19	23
MYG10-680	D10K40	68	10	135	5.0	2800	40	56	6.4	500	0.05	20	24
MYG14-680	D14K40	68	10	135	10.0	5500	40	56	13.0	1000	0.10	21	24
MYG20-680	D20K40	68	10	135	20.0	11500	40	56	37.0	2000	0.20	22	25
MYG05-820	D05K50	82	10	145	5.0	310	50	65	2.5	800	0.10	18	25
MYG07-820	D07K50	82	10	135	10.0	860	50	65	5.0	1750	0.25	19	26
MYG10-820	D10K50	82	10	135	25.0	1920	50	65	10.0	3500	0.40	20	26
MYG14-820	D14K50	82	10	135	50.0	4300	50	65	20.0	6000	0.60	21	27
MYG20-820	D20K50	82	10	135	100.0	8200	50	65	40.0	10000	1.00	22	27
MYG05-101	D05K60	100	10	175	5.0	290	60	81	3.0	800	0.10	18	25
MYG07-101	D07K60	100	10	165	10.0	750	60	81	6.0	1750	0.25	19	26

VN\* means ∅ 5mm are tested by constant current of 0.1mA  
 ∅ 7~20mm are tested by constant current of 1.0mA



Type	Dimensions								Certification			
	D <sub>max</sub> (mm)	H <sub>2max</sub> (mm)	H <sub>3max</sub> (mm)	T <sub>max</sub> (mm)	W $\pm$ 1.0 (mm)	L <sub>min</sub> (mm)	I <sub>max</sub> (mm)	d $\pm$ 0.05 (mm)	CE	UL	VDE	SP
MYG05-180	7.5	10.5	13.5	4.4	5.0	25.0	3.0	0.6	★	○		
MYG07-180	9.0	12.0	13.5	4.4	5.0	25.0	3.0	0.6	★	○		
MYG10-180	14.0	16.0	17.5	4.8	7.5	25.0	3.0	0.8	★	○	★	
MYG14-180	17.5	20.0	25.0	4.8	7.5	25.0	3.0	0.8	★	○	★	
MYG20-180	25.0	25.0	29.0	5.2	10.0	25.0	3.0	1.0	★	○		
MYG05-220	7.5	10.5	13.5	4.5	5.0	25.0	3.0	0.6	★	○		
MYG07-220	9.0	12.0	13.5	4.5	5.0	25.0	3.0	0.6	★	○		
MYG10-220	14.0	16.0	17.5	4.9	7.5	25.0	3.0	0.8	★	○	★	
MYG14-220	17.5	20.0	25.0	4.9	7.5	25.0	3.0	0.8	★	○	★	
MYG20-220	25.0	25.0	29.0	5.3	10.0	25.0	3.0	1.0	★	○		
MYG05-270	7.5	10.5	13.5	4.6	5.0	25.0	3.0	0.6	★	○		
MYG07-270	9.0	12.0	13.5	4.6	5.0	25.0	3.0	0.6	★	○		
MYG10-270	14.0	16.0	17.5	5.0	7.5	25.0	3.0	0.8	★	○	★	
MYG14-270	17.5	20.0	25.0	5.0	7.5	25.0	3.0	0.8	★	○	★	
MYG20-270	25.0	25.0	29.0	5.4	10.0	25.0	3.0	1.0	★	○		
MYG05-330	7.5	10.5	13.5	4.8	5.0	25.0	3.0	0.6	★	○		
MYG07-330	9.0	12.0	13.5	4.8	5.0	25.0	3.0	0.6	★	○		
MYG10-330	14.0	16.0	17.5	5.2	7.5	25.0	3.0	0.8	★	○	★	
MYG14-330	17.5	20.0	25.0	5.2	7.5	25.0	3.0	0.8	★	○	★	
MYG20-330	25.0	25.0	29.0	5.6	10.0	25.0	3.0	1.0	★	○		
MYG05-390	7.5	10.5	13.5	5.0	5.0	25.0	3.0	0.6	★	○		
MYG07-390	9.0	12.0	13.5	5.0	5.0	25.0	3.0	0.6	★	○		
MYG10-390	14.0	16.0	17.5	5.4	7.5	25.0	3.0	0.8	★	○	★	
MYG14-390	17.5	20.0	25.0	5.4	7.5	25.0	3.0	0.8	★	○	★	
MYG20-390	25.0	25.0	29.0	5.8	10.0	25.0	3.0	1.0	★	○		
MYG05-470	7.5	10.5	13.5	5.2	5.0	25.0	3.0	0.6	★	○		
MYG07-470	9.0	12.0	13.5	5.2	5.0	25.0	3.0	0.6	★	○		
MYG10-470	14.0	16.0	17.5	5.6	7.5	25.0	3.0	0.8	★	○	★	
MYG14-470	17.5	20.0	25.0	5.6	7.5	25.0	3.0	0.8	★	○	★	
MYG20-470	25.0	25.0	29.0	6.0	10.0	25.0	3.0	1.0	★	○		
MYG05-560	7.5	10.5	13.5	5.4	5.0	25.0	3.0	0.6	★	○		
MYG07-560	9.0	12.0	13.5	5.4	5.0	25.0	3.0	0.6	★	○		
MYG10-560	14.0	16.0	17.5	5.8	7.5	25.0	3.0	0.8	★	○	★	
MYG14-560	17.5	20.0	25.0	5.8	7.5	25.0	3.0	0.8	★	○	★	
MYG20-560	25.0	25.0	29.0	6.2	10.0	25.0	3.0	1.0	★	○		
MYG05-680	7.5	10.5	13.5	5.7	5.0	25.0	3.0	0.6	★	○		
MYG07-680	9.0	12.0	13.5	5.7	5.0	25.0	3.0	0.6	★	○		
MYG10-680	14.0	16.0	17.5	6.1	7.5	25.0	3.0	0.8	★	○	★	
MYG14-680	17.5	20.0	25.0	6.1	7.5	25.0	3.0	0.8	★	○	★	
MYG20-680	25.0	25.0	29.0	6.5	10.0	25.0	3.0	1.0	★	○		
MYG05-820	7.5	10.5	13.5	4.0	5.0	25.0	3.0	0.6	★	★		★
MYG07-820	9.0	12.0	13.5	4.0	5.0	25.0	3.0	0.6	★	★		★
MYG10-820	14.0	16.0	17.5	4.4	7.5	25.0	3.0	0.8	★	★	★	★
MYG14-820	17.5	20.0	25.0	4.4	7.5	25.0	3.0	0.8	★	★	★	★
MYG20-820	25.0	25.0	29.0	4.8	10.0	25.0	3.0	1.0	★	★		★
MYG05-101	7.5	10.5	13.5	4.4	5.0	25.0	3.0	0.6	★	★		★
MYG07-101	9.0	12.0	13.5	4.4	5.0	25.0	3.0	0.6	★	★		★

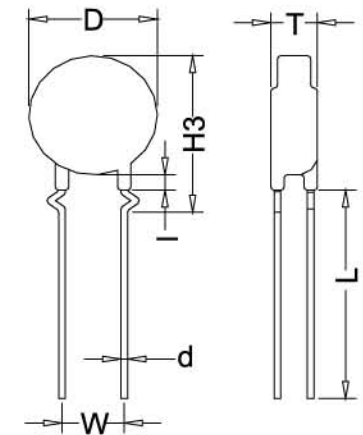
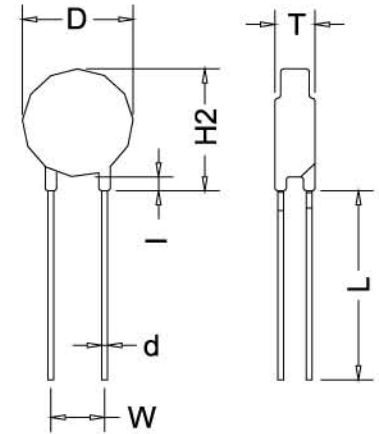

★ Means it has accredited safety certification

○ Means the safety certification is in process, Details please contact with our marketing department.

Type	Material code	Characteristics TA = +25 °C					Maximum ratings T =+85 C					V/I Characteristic curve	Pulse derating curve
		Varistor voltage	Tolerance	Clamping voltage at I <sub>p</sub> (8/20µs)		Capacitance (1kHz)	Max continuous operating voltage		Max energy absorption (2ms)	Peak current (8/20µs)	Max power rating		
				V <sub>N</sub> * (V)	ΔV <sub>N</sub> (±%)		V <sub>P</sub> (V)	I <sub>p</sub> (A)				C (pF)	V <sub>RMS</sub> (V)
MYG10-101	D10K60	100	10	165	25.0	1800	60	81	12.0	3500	0.40	20	26
MYG14-101	D14K60	100	10	165	50.0	3500	60	81	25.0	6000	0.60	21	27
MYG20-101	D20K60	100	10	165	100.0	8000	60	81	50.0	10000	1.00	22	27
MYG05-121	D05K75	120	10	210	5.0	270	75	100	3.5	800	0.10	18	25
MYG07-121	D07K75	120	10	200	10.0	530	75	100	7.0	1750	0.25	19	26
MYG10-121	D10K75	120	10	200	25.0	1500	75	100	14.5	3500	0.40	20	26
MYG14-121	D14K75	120	10	200	50.0	2500	75	100	30.0	6000	0.60	21	27
MYG20-121	D20K75	120	10	200	100.0	5500	75	100	60.0	10000	1.00	22	27
MYG05-151	D05K95	150	10	260	5.0	240	95	125	4.5	800	0.10	18	25
MYG07-151	D07K95	150	10	250	10.0	410	95	125	9.0	1750	0.25	19	26
MYG10-151	D10K95	150	10	250	25.0	1200	95	125	18.0	3500	0.40	20	26
MYG14-151	D14K95	150	10	250	50.0	2100	95	125	37.5	6000	0.60	21	27
MYG20-151	D20K95	150	10	250	100.0	4200	95	125	75.0	10000	1.00	22	27
MYG05-181	D05K115	180	10	325	5.0	140	115	150	5.2	800	0.10	18	25
MYG07-181	D07K115	180	10	300	10.0	300	115	150	10.4	1750	0.25	19	26
MYG10-181	D10K115	180	10	300	25.0	620	115	150	21.0	3500	0.40	20	26
MYG14-181	D14K115	180	10	300	50.0	1250	115	150	42.0	6000	0.60	21	27
MYG20-181	D20K115	180	10	300	100.0	2500	115	150	84.0	10000	1.00	22	27
MYG05-201	D05K130	205	10	355	5.0	120	130	170	6.0	800	0.10	18	25
MYG07-201	D07K130	205	10	340	10.0	250	130	170	12.5	1750	0.25	19	26
MYG10-201	D10K130	205	10	340	25.0	570	130	170	25.0	3500	0.40	20	26
MYG14-201	D14K130	205	10	340	50.0	1150	130	170	50.0	6000	0.60	21	27
MYG20-201	D20K130	205	10	340	100.0	2300	130	170	100.0	10000	1.00	22	27
MYG05-221	D05K140	220	10	380	5.0	110	140	180	6.5	800	0.10	18	25
MYG07-221	D07K140	220	10	360	10.0	250	140	180	13.5	1750	0.25	19	26
MYG10-221	D10K140	220	10	360	25.0	560	140	180	27.5	3500	0.40	20	26
MYG14-221	D14K140	220	10	360	50.0	1100	140	180	55.0	6000	0.60	21	27
MYG20-221	D20K140	220	10	360	100.0	2200	140	180	110.0	10000	1.00	22	27
MYG05-241	D05K150	240	10	415	5.0	110	150	200	7.5	800	0.10	18	25
MYG07-241	D07K150	240	10	395	10.0	240	150	200	15.0	1750	0.25	19	26
MYG10-241	D10K150	240	10	395	25.0	550	150	200	30.0	3500	0.40	20	26
MYG14-241	D14K150	240	10	395	50.0	1050	150	200	60.0	6000	0.60	21	27
MYG20-241	D20K150	240	10	395	100.0	2200	150	200	120.0	10000	1.00	22	27
MYG05-271	D05K175	270	10	475	5.0	100	175	225	8.0	800	0.10	18	25
MYG07-271	D07K175	270	10	455	10.0	220	175	225	17.0	1750	0.25	19	26
MYG10-271	D10K175	270	10	455	25.0	530	175	225	35.0	3500	0.40	20	26
MYG14-271	D14K175	270	10	455	50.0	1000	175	225	70.0	6000	0.60	21	27
MYG20-271	D20K175	270	10	455	100.0	2100	175	225	135.0	10000	1.00	22	27
MYG05-301	D05K195	300	10	505	5.0	100	195	250	8.8	800	0.10	18	25
MYG07-301	D07K195	300	10	500	10.0	190	195	250	18.5	1750	0.25	19	26
MYG10-301	D10K195	300	10	500	25.0	500	195	250	38.0	3500	0.40	20	26
MYG14-301	D14K195	300	10	500	50.0	900	195	250	78.0	6000	0.60	21	27
MYG20-301	D20K195	300	10	500	100.0	1800	195	250	148.0	10000	1.00	22	27
MYG05-331	D05K210	330	10	600	5.0	90	210	275	9.5	800	0.10	18	25
MYG07-331	D07K210	330	10	550	10.0	180	210	275	20.0	1750	0.25	19	26
MYG10-331	D10K210	330	10	550	25.0	450	210	275	42.0	3500	0.40	20	26
MYG14-331	D14K210	330	10	550	50.0	850	210	275	80.0	6000	0.60	21	27

V<sub>N</sub>\* means Ø5mm are tested by constant current of 0.1mA  
 Ø7~20mm are tested by constant current of 1.0mA



Type	Dimensions								Certification			
	D <sub>max</sub> (mm)	H <sub>2max</sub> (mm)	H <sub>3max</sub> (mm)	T <sub>max</sub> (mm)	W±1.0 (mm)	L <sub>min</sub> (mm)	l <sub>max</sub> (mm)	d±0.05 (mm)	CE	UL	VDE	SP
MYG10-101	14.0	16.0	17.5	4.8	7.5	25.0	3.0	0.8	★	★	★	★
MYG14-101	17.5	20.0	25.0	4.8	7.5	25.0	3.0	0.8	★	★	★	★
MYG20-101	25.0	25.0	29.0	5.2	10.0	25.0	3.0	1.0	★	★	★	★
MYG05-121	7.5	10.5	13.5	4.5	5.0	25.0	3.0	0.6	★	★		★
MYG07-121	9.0	12.0	13.5	4.5	5.0	25.0	3.0	0.6	★	★		★
MYG10-121	14.0	16.0	17.5	4.9	7.5	25.0	3.0	0.8	★	★	★	★
MYG14-121	17.5	20.0	25.0	4.9	7.5	25.0	3.0	0.8	★	★	★	★
MYG20-121	25.0	25.0	29.0	5.3	10.0	25.0	3.0	1.0	★	★		★
MYG05-151	7.5	10.5	13.5	4.5	5.0	25.0	3.0	0.6	★	★		★
MYG07-151	9.0	12.0	13.5	4.5	5.0	25.0	3.0	0.6	★	★		★
MYG10-151	14.0	16.0	17.5	4.9	7.5	25.0	3.0	0.8	★	★	★	★
MYG14-151	17.5	20.0	25.0	4.9	7.5	25.0	3.0	0.8	★	★	★	★
MYG20-151	25.0	25.0	29.0	5.3	10.0	25.0	3.0	1.0	★	★		★
MYG05-181	7.5	10.5	13.5	4.6	5.0	25.0	3.0	0.6	★	★		★
MYG07-181	9.0	12.0	13.5	4.6	5.0	25.0	3.0	0.6	★	★		★
MYG10-181	14.0	16.0	17.5	5.0	7.5	25.0	3.0	0.8	★	★	★	★
MYG14-181	17.5	20.0	25.0	5.0	7.5	25.0	3.0	0.8	★	★	★	★
MYG20-181	25.0	25.0	29.0	5.4	10.0	25.0	3.0	1.0	★	★		★
MYG05-201	7.5	10.5	13.5	4.7	5.0	25.0	3.0	0.6	★	★		★
MYG07-201	9.0	12.0	13.5	4.7	5.0	25.0	3.0	0.6	★	★		★
MYG10-201	14.0	16.0	17.5	5.1	7.5	25.0	3.0	0.8	★	★	★	★
MYG14-201	17.5	20.0	25.0	5.1	7.5	25.0	3.0	0.8	★	★	★	★
MYG20-201	25.0	25.0	29.0	5.5	10.0	25.0	3.0	1.0	★	★		★
MYG05-221	7.5	10.5	13.5	4.7	5.0	25.0	3.0	0.6	★	★		★
MYG07-221	9.0	12.0	13.5	4.7	5.0	25.0	3.0	0.6	★	★		★
MYG10-221	14.0	16.0	17.5	5.1	7.5	25.0	3.0	0.8	★	★	★	★
MYG14-221	17.5	20.0	25.0	5.1	7.5	25.0	3.0	0.8	★	★	★	★
MYG20-221	25.0	25.0	29.0	5.5	10.0	25.0	3.0	1.0	★	★		★
MYG05-241	7.5	10.5	13.5	4.7	5.0	25.0	3.0	0.6	★	★		★
MYG07-241	9.0	12.0	13.5	4.7	5.0	25.0	3.0	0.6	★	★		★
MYG10-241	14.0	16.0	17.5	5.1	7.5	25.0	3.0	0.8	★	★	★	★
MYG14-241	17.5	20.0	25.0	5.1	7.5	25.0	3.0	0.8	★	★	★	★
MYG20-241	25.0	25.0	29.0	5.5	10.0	25.0	3.0	1.0	★	★		★
MYG05-271	7.5	10.5	13.5	4.8	5.0	25.0	3.0	0.6	★	★		★
MYG07-271	9.0	12.0	13.5	4.8	5.0	25.0	3.0	0.6	★	★		★
MYG10-271	14.0	16.0	17.5	5.2	7.5	25.0	3.0	0.8	★	★	★	★
MYG14-271	17.5	20.0	25.0	5.2	7.5	25.0	3.0	0.8	★	★	★	★
MYG20-271	25.0	25.0	29.0	5.6	10.0	25.0	3.0	1.0	★	★		★
MYG05-301	7.5	10.5	13.5	4.8	5.0	25.0	3.0	0.6	★	★		★
MYG07-301	9.0	12.0	13.5	4.8	5.0	25.0	3.0	0.6	★	★		★
MYG10-301	14.0	16.0	17.5	5.2	7.5	25.0	3.0	0.8	★	★	★	★
MYG14-301	17.5	20.0	25.0	5.2	7.5	25.0	3.0	0.8	★	★	★	★
MYG20-301	25.0	25.0	29.0	5.6	10.0	25.0	3.0	1.0	★	★		★
MYG05-331	7.5	10.5	13.5	4.9	5.0	25.0	3.0	0.6	★	★		★
MYG07-331	9.0	12.0	13.5	4.9	5.0	25.0	3.0	0.6	★	★		★
MYG10-331	14.0	16.0	17.5	5.3	7.5	25.0	3.0	0.8	★	★	★	★
MYG14-331	17.5	20.0	25.0	5.3	7.5	25.0	3.0	0.8	★	★	★	★

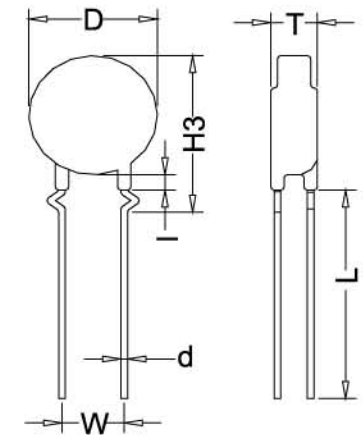
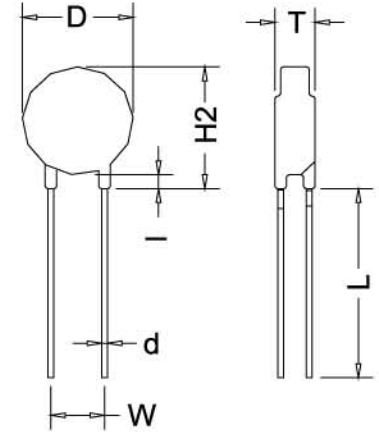

★ Means it has accerded safety certification  
 ○ Means the safety certification is in process, Details please contact with our marketing department.



Type	Material code	Characteristics TA = +25 °C					Maximum ratings T =+85 C					V/I Characteristic curve	Derating curve
		Varistor voltage	Tolerance	Clamping voltage at I <sub>p</sub> (8/20 μs)		Capacitance (1kHz)	Max continuous operating voltage		Max energy absorption (2ms)	Peak current (8/20 μs)	Max power rating		
		V <sub>N</sub> * (V)	ΔV <sub>N</sub> (±%)	V <sub>P</sub> (V)	I <sub>p</sub> (A)	C (pF)	V <sub>RMS</sub> (V)	V <sub>Dc</sub> (V)	W <sub>max</sub> (J)	I <sub>max</sub> (A)	P <sub>max</sub> (W)	Page	Page
MYG20-331	D20K210	330	10	550	100.0	1750	210	275	160.0	10000	1.00	22	27
MYG05-361	D05K230	360	10	620	5.0	80	230	300	11.0	800	0.10	18	25
MYG07-361	D07K230	360	10	595	10.0	170	230	300	23.0	1750	0.25	19	26
MYG10-361	D10K230	360	10	595	25.0	450	230	300	45.0	3500	0.40	20	26
MYG14-361	D14K230	360	10	595	50.0	850	230	300	90.0	6000	0.60	21	27
MYG20-361	D20K230	360	10	595	100.0	1700	230	300	180.0	10000	1.00	22	27
MYG05-391	D05K250	390	10	675	5.0	80	250	320	12.0	800	0.10	18	25
MYG07-391	D07K250	390	10	650	10.0	160	250	320	25.0	1750	0.25	19	26
MYG10-391	D10K250	390	10	650	25.0	430	250	320	50.0	3500	0.40	20	26
MYG14-391	D14K250	390	10	650	50.0	800	250	320	100.0	6000	0.60	21	27
MYG20-391	D20K250	390	10	650	100.0	1400	250	320	195.0	10000	1.00	22	27
MYG05-431	D05K275	430	10	745	5.0	70	275	350	13.5	800	0.10	18	25
MYG07-431	D07K275	430	10	710	10.0	150	275	350	27.5	1750	0.25	19	26
MYG10-431	D10K275	430	10	710	25.0	400	275	350	55.0	3500	0.40	20	26
MYG14-431	D14K275	430	10	710	50.0	650	275	350	110.0	6000	0.60	21	27
MYG20-431	D20K275	430	10	710	100.0	1350	275	350	215.0	10000	1.00	22	27
MYG05-471	D05K300	470	10	810	5.0	70	300	385	15.0	800	0.10	18	25
MYG07-471	D07K300	470	10	775	10.0	130	300	385	30.0	1750	0.25	19	26
MYG10-471	D10K300	470	10	775	25.0	300	300	385	60.0	3500	0.40	20	26
MYG14-471	D14K300	470	10	775	50.0	550	300	385	125.0	6000	0.60	21	27
MYG20-471	D20K300	470	10	775	100.0	1200	300	385	250.0	10000	1.00	22	27
MYG05-511	D05K320	510	10	845	5.0	60	320	410	11.0	400	0.10	18	28
MYG07-511	D07K320	510	10	845	10.0	120	320	410	32.0	1750	0.25	19	26
MYG10-511	D10K320	510	10	845	25.0	260	320	410	67.0	3500	0.40	20	26
MYG14-511	D14K320	510	10	845	50.0	450	320	410	136.0	6000	0.60	21	27
MYG20-511	D20K320	510	10	845	100.0	1050	320	410	273.0	10000	1.00	22	27
MYG05-561	D05K350	560	10	915	5.0	50	350	460	12.0	400	0.10	18	28
MYG07-561	D07K350	560	10	915	10.0	120	350	460	32.0	1750	0.25	19	26
MYG10-561	D10K350	560	10	915	25.0	200	350	460	67.0	3500	0.40	20	26
MYG14-561	D14K350	560	10	915	50.0	400	350	460	136.0	6000	0.60	21	27
MYG20-561	D20K350	560	10	915	100.0	850	350	460	273.0	10000	1.00	22	27
MYG05-621	D05K385	620	10	1025	5.0	40	385	505	13.0	400	0.10	18	28
MYG07-621	D07K385	620	10	1025	10.0	120	385	505	32.0	1750	0.25	19	26
MYG10-621	D10K385	620	10	1025	25.0	170	385	505	67.0	3500	0.40	20	26
MYG14-621	D14K385	620	10	1025	50.0	350	385	505	136.0	6000	0.60	21	27
MYG20-621	D20K385	620	10	1025	100.0	570	385	505	273.0	10000	1.00	22	27
MYG05-681	D05K420	680	10	1120	5.0	35	420	560	14.0	400	0.10	18	28
MYG07-681	D07K420	680	10	1120	10.0	120	420	560	32.0	1750	0.25	19	26
MYG10-681	D10K420	680	10	1120	25.0	160	420	560	67.0	3500	0.40	20	26
MYG14-681	D14K420	680	10	1120	50.0	350	420	560	136.0	6000	0.60	21	27
MYG20-681	D20K420	680	10	1120	100.0	550	420	560	273.0	10000	1.00	22	27
MYG05-751	D05K460	750	10	1240	5.0	30	460	615	18.0	400	0.10	18	28
MYG07-751	D07K460	750	10	1240	10.0	120	460	615	32.0	1750	0.25	19	26
MYG10-751	D10K460	750	10	1240	25.0	150	460	615	70.0	3500	0.40	20	26
MYG14-751	D14K460	750	10	1240	50.0	330	460	615	150.0	6000	0.60	21	27
MYG20-751	D20K460	750	10	1240	100.0	530	460	615	300.0	10000	1.00	22	27
MYG10-781	D10K485	780	10	1290	25.0	150	485	640	75.0	3500	0.40	18	26

V<sub>N</sub>\* means ∅ 5mm are tested by constant current of 0.1mA  
 ∅ 7~20mm are tested by constant current of 1.0mA

Type	Dimensions								Certification			
	D <sub>max</sub> (mm)	H <sub>2max</sub> (mm)	H <sub>3max</sub> (mm)	T <sub>max</sub> (mm)	W $\pm$ 1.0 (mm)	L <sub>min</sub> (mm)	l <sub>max</sub> (mm)	d $\pm$ 0.05 (mm)	CE	UL	VDE	SP
MYG20-331	25.0	25.0	29.0	5.7	10.0	25.0	3.0	1.0	★	★		★
MYG05-361	7.5	10.5	13.5	4.9	5.0	25.0	3.0	0.6	★	★		★
MYG07-361	9.0	12.0	13.5	4.9	5.0	25.0	3.0	0.6	★	★		★
MYG10-361	14.0	16.0	17.5	5.3	7.5	25.0	3.0	0.8	★	★	★	★
MYG14-361	17.5	20.0	25.0	5.3	7.5	25.0	3.0	0.8	★	★	★	★
MYG20-361	25.0	25.0	29.0	5.7	10.0	25.0	3.0	1.0	★	★		★
MYG05-391	7.5	10.5	13.5	5.1	5.0	25.0	3.0	0.6	★	★		★
MYG07-391	9.0	12.0	13.5	5.1	5.0	25.0	3.0	0.6	★	★		★
MYG10-391	14.0	16.0	17.5	5.5	7.5	25.0	3.0	0.8	★	★	★	★
MYG14-391	17.5	20.0	25.0	5.5	7.5	25.0	3.0	0.8	★	★	★	★
MYG20-391	25.0	25.0	29.0	5.9	10.0	25.0	3.0	1.0	★	★		★
MYG05-431	7.5	10.5	13.5	5.3	5.0	25.0	3.0	0.6	★	★		★
MYG07-431	9.0	12.0	13.5	5.3	5.0	25.0	3.0	0.6	★	★		★
MYG10-431	14.0	16.0	17.5	5.7	7.5	25.0	3.0	0.8	★	★	★	★
MYG14-431	17.5	20.0	25.0	5.7	7.5	25.0	3.0	0.8	★	★	★	★
MYG20-431	25.0	25.0	29.0	6.1	10.0	25.0	3.0	1.0	★	★		★
MYG05-471	7.5	10.5	13.5	5.5	5.0	25.0	3.0	0.6	★	★		★
MYG07-471	9.0	12.0	13.5	5.5	5.0	25.0	3.0	0.6	★	★		★
MYG10-471	14.0	16.0	17.5	5.9	7.5	25.0	3.0	0.8	★	★	★	★
MYG14-471	17.5	20.0	25.0	5.9	7.5	25.0	3.0	0.8	★	★	★	★
MYG20-471	25.0	25.0	29.0	6.3	10.0	25.0	3.0	1.0	★	★		★
MYG05-511	7.5	10.5	13.5	5.1	5.0	25.0	3.0	0.6	★			★
MYG07-511	9.0	12.0	13.5	5.7	5.0	25.0	3.0	0.6	★	★		★
MYG10-511	14.0	16.0	17.5	6.1	7.5	25.0	3.0	0.8	★	★	★	★
MYG14-511	17.5	20.0	25.0	6.1	7.5	25.0	3.0	0.8	★	★	★	★
MYG20-511	25.0	25.0	29.0	6.5	10.0	25.0	3.0	1.0	★	★		★
MYG05-561	7.5	10.5	13.5	5.1	5.0	25.0	3.0	0.6	★			★
MYG07-561	9.0	12.0	13.5	6.0	5.0	25.0	3.0	0.6	★	★		★
MYG10-561	14.0	16.0	17.5	6.4	7.5	25.0	3.0	0.8	★	★	★	★
MYG14-561	17.5	20.0	25.0	6.4	7.5	25.0	3.0	0.8	★	★	★	★
MYG20-561	25.0	25.0	29.0	6.8	10.0	25.0	3.0	1.0	★	★		★
MYG05-621	7.5	10.5	13.5	5.1	5.0	25.0	3.0	0.6	★			★
MYG07-621	9.0	12.0	13.5	6.3	5.0	25.0	3.0	0.6	★	★		★
MYG10-621	14.0	16.0	17.5	6.7	7.5	25.0	3.0	0.8	★	★	★	★
MYG14-621	17.5	20.0	25.0	6.7	7.5	25.0	3.0	0.8	★	★	★	★
MYG20-621	25.0	25.0	29.0	7.1	10.0	25.0	3.0	1.0	★	★		★
MYG05-681	7.5	10.5	13.5	5.4	5.0	25.0	3.0	0.6	★			★
MYG07-681	9.0	12.0	13.5	6.6	5.0	25.0	3.0	0.6	★			★
MYG10-681	14.0	16.0	17.5	7.0	7.5	25.0	3.0	0.8	★	★	★	★
MYG14-681	17.5	20.0	25.0	7.0	7.5	25.0	3.0	0.8	★	★	★	★
MYG20-681	25.0	25.0	29.0	7.4	10.0	25.0	3.0	1.0	★	★		★
MYG05-751	7.5	10.5	13.5	5.7	5.0	25.0	3.0	0.6	★			★
MYG07-751	9.0	12.0	13.5	7.0	5.0	25.0	3.0	0.6	★			★
MYG10-751	14.0	16.0	17.5	7.4	7.5	25.0	3.0	0.8	★	★	★	★
MYG14-751	17.5	20.0	25.0	7.4	7.5	25.0	3.0	0.8	★	★	★	★
MYG20-751	25.0	25.0	29.0	7.8	10.0	25.0	3.0	1.0	★	★		★
MYG10-781	14.0	16.0	17.5	7.4	7.5	25.0	3.0	0.8	★		★	★

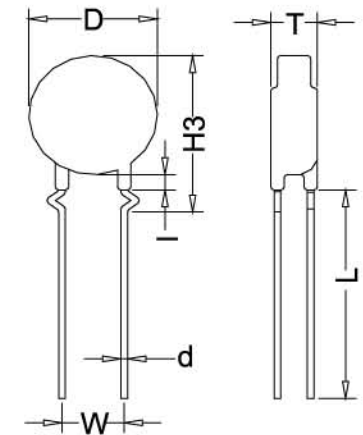
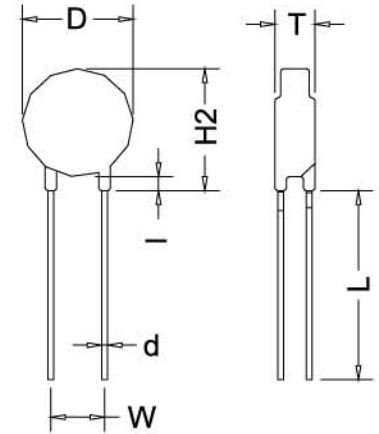

★ Means it has accredited safety certification

○ Means the safety certification is in process, Details please contact with our marketing department.



Type	Material code	Characteristics TA = +25 °C					Maximum ratings T =+85 C					V/I Characteristic curve	Derating curve
		Varistor voltage	Tolerance	Clamping voltage at Ip (8/20µs)		Capacitance (1kHz)	Max continuous operating voltage		Max energy absorption (2ms)	Peak current (8/20µs)	Max power rating		
				VN* (V)	ΔVN (±%)		VP (V)	IP (A)				C (pF)	VRMS (V)
MYG14-781	D14K485	780	10	1290	50.0	330	485	640	160.0	6000	0.60	21	27
MYG20-781	D20K485	780	10	1290	100.0	530	485	640	315.0	10000	1.00	22	27
MYG10-821	D10K510	820	10	1355	25.0	150	510	670	80.0	3500	0.40	20	26
MYG14-821	D14K510	820	10	1355	50.0	330	510	670	165.0	6000	0.60	21	27
MYG20-821	D20K510	820	10	1355	100.0	530	510	670	325.0	10000	1.00	22	27
MYG10-911	D10K550	910	10	1500	25.0	140	550	745	90.0	3500	0.40	20	26
MYG14-911	D14K550	910	10	1500	50.0	300	550	745	180.0	6000	0.60	21	27
MYG20-911	D20K550	910	10	1500	100.0	480	550	745	360.0	10000	1.00	22	27
MYG10-102	D10K625	1000	10	1650	25.0	140	625	825	100.0	3500	0.40	20	26
MYG14-102	D14K625	1000	10	1650	50.0	300	625	825	200.0	5000	0.60	21	28
MYG20-102	D20K625	1000	10	1650	100.0	480	625	825	400.0	7500	1.00	22	29
MYG10-112	D10K680	1100	10	1815	25.0	130	680	895	110.0	3500	0.40	20	26
MYG14-112	D14K680	1100	10	1815	50.0	200	680	895	220.0	5000	0.60	21	28
MYG20-112	D20K680	1100	10	1815	100.0	400	680	895	440.0	7500	1.00	22	29
MYG14-182	D14K1000	1800	10	2970	50.0	150	1000	1465	360.0	5000	0.60	21	28
MYG20-182	D20K1000	1800	10	2970	100.0	250	1000	1465	720.0	7500	1.00	22	29

VN\* means  $\varnothing 5\text{mm}$  are tested by constant current of 0.1mA  
 $\varnothing 7\text{--}20\text{mm}$  are tested by constant current of 1.0mA

Type	Dimensions								Certification				
	Dmax (mm)	H2max (mm)	H3max (mm)	Tmax (mm)	W±1.0 (mm)	Lmin (mm)	Imax (mm)	d±0.05 (mm)	CE	UL	VDE	SP	
MYG14-781	17.5	20.0	25.0	7.4	7.5	25.0	3.0	0.8	★		★	★	
MYG20-781	25.0	25.0	29.0	7.8	10.0	25.0	3.0	1.0	★			★	
MYG10-821	14.0	16.0	17.5	7.8	7.5	25.0	3.0	0.8	★	★	★	★	
MYG14-821	17.5	20.0	25.0	7.8	7.5	25.0	3.0	0.8	★	★	★	★	
MYG20-821	25.0	25.0	29.0	8.2	10.0	25.0	3.0	1.0	★	★		★	
MYG10-911	14.0	16.0	17.5	8.2	7.5	25.0	3.0	0.8	★	★	★	★	
MYG14-911	17.5	20.0	25.0	8.2	7.5	25.0	3.0	0.8	★	★	★	★	
MYG20-911	25.0	25.0	29.0	8.6	10.0	25.0	3.0	1.0	★	★		★	
MYG10-102	14.0	16.0	17.5	8.7	7.5	25.0	3.0	0.8	★	★	★	★	
MYG14-102	17.5	20.0	25.0	8.7	7.5	25.0	3.0	0.8	★	★	★	★	
MYG20-102	25.0	25.0	29.0	9.1	10.0	25.0	3.0	1.0	★	★		★	
MYG10-112	14.0	16.0	17.5	9.2	7.5	25.0	3.0	0.8	★	★	★	★	
MYG14-112	17.5	20.0	25.0	9.2	7.5	25.0	3.0	0.8	★	★	★	★	
MYG20-112	25.0	25.0	29.0	9.6	10.0	25.0	3.0	1.0	★	★		★	
MYG14-182	17.5	20.0	25.0	13.9	7.5	25.0	3.0	0.8	★	★	★	★	
MYG20-182	25.0	25.0	29.0	14.3	10.0	25.0	3.0	1.0	★	★		★	

★ Means it has accredited safety certification

○ Means the safety certification is in process, Details please contact with our marketing department.



**Taping Drawings**

**D10 Taping Drawings (Reel)**

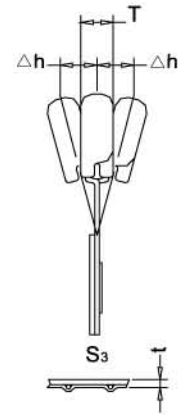
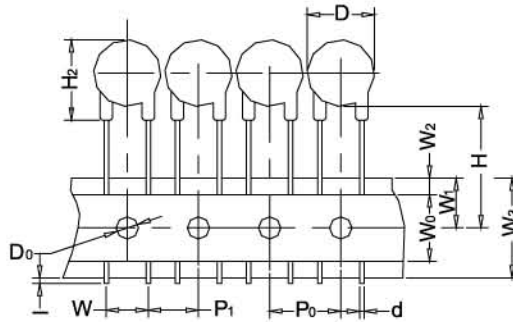
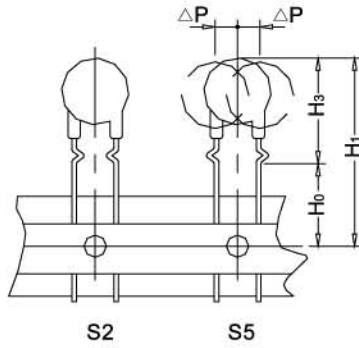

**D14 Taping Drawings (Reel and Ammopack)**

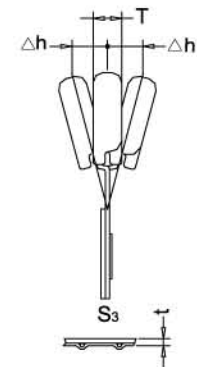
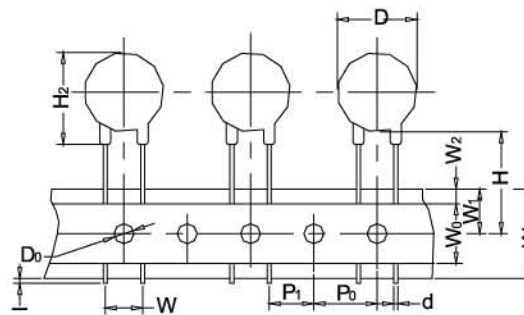
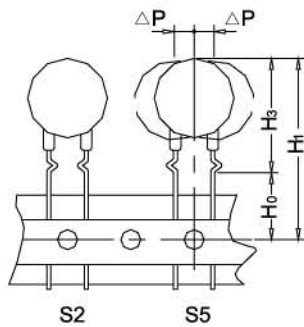

Item	W=5.0	Tolerance	W=5.0	Tolerance	W=7.5	Tolerance	W=7.5	Tolerance	W=10.0	Tolerance
Type	D05		D07		D10		D14		D20	
P <sub>0</sub>	12.7	± 0.3	12.7	± 0.3	12.7	± 0.3	12.7	± 0.3	12.7	± 0.3
P <sub>1</sub>	3.85	± 0.8	3.85	± 0.8	8.95	± 0.8	8.95	± 0.8	7.7	± 0.8
Δ h	0	± 2.0	0	± 2.0	Accord T to confirm					
Δ p	0	± 1.3	0	± 1.3	0	± 2.0	0	± 2.0	0	± 2.0
W <sub>3</sub>	18	± 0.5	18	± 0.5	18	± 0.5	18	± 0.5	18	± 0.5
W <sub>0</sub>	11	min	11	min	11	min	11	min	11	min
W <sub>1</sub>	9	± 0.7	9	± 0.7	9	± 0.7	9	± 0.7	9	± 0.7
W <sub>2</sub>	3	max	3	max	3	max	3	max	3	max
H	18	+2/-0	18	+2/-0	18	+2/-0	18	+2/-0	18	+2/-0
H <sub>0</sub>	16	± 0.8	16	± 0.8	16	± 0.8	16	± 0.8	16	± 0.8
H <sub>1</sub>	32.2	max	32.2	max	45	max	45	max	45	max
H <sub>3</sub>	13.5	max	13.5	max	17.5	max	25	max	29	max
D <sub>0</sub>	4.0	± 0.2	4.0	± 0.2	4.0	± 0.2	4.0	± 0.2	4.0	± 0.2
t	0.9	max	0.9	max	0.9	max	0.9	max	0.9	max
1	1.0	max	1.0	max	1.0	max	1.0	max	1.0	max

## Products Description

MYH varistors are designed for electronic circuit for high surge withstanding capacity, which have standard electrode with PCB. With the same product dimensions, it can handle greater surge than MYG series. It is widely used in various fields of computer, power supply, communication, network, railway, generator control, etc.

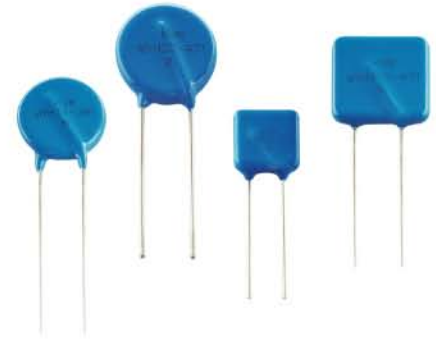

## Construction and Features:

- Construction: Round or quadrate varistors element, Leaded and coated;
- Coating materials: Epoxy resin, flame retardant to UL94V-0;
- Terminals: Tinned copper wire;
- Package: Bulk, Reel or Ammopack.

## Key Characteristic Parameters:

Max AC Operating Voltage	$V_{RMS}(V)$	130~320
Max Energy Absorption	$W_{max}(J)$	45~255
Peak Current (8/20 $\mu$ s)	$I_{max}(kA)$	8~15
MOV Diameter	$D(mm)$	14~20

## Technical Data:

Characteristics	Parameters	Standards
Climatic Category	40/85/56	
LCT	-40 $^{\circ}C$	
UCT	+85 $^{\circ}C$	IEC68-2-3
Operating Temperature	-40 $^{\circ}C$ ~ +85 $^{\circ}C$	CECC 42 000
Storage Temperature	-40 $^{\circ}C$ ~ +125 $^{\circ}C$	
Electric Strength	> 2500V(AC)	CECC 42 000
Insulation Resistance	> 10M $\Omega$	CECC 42 000
Response Time	<25 ns	

## Type Designation:

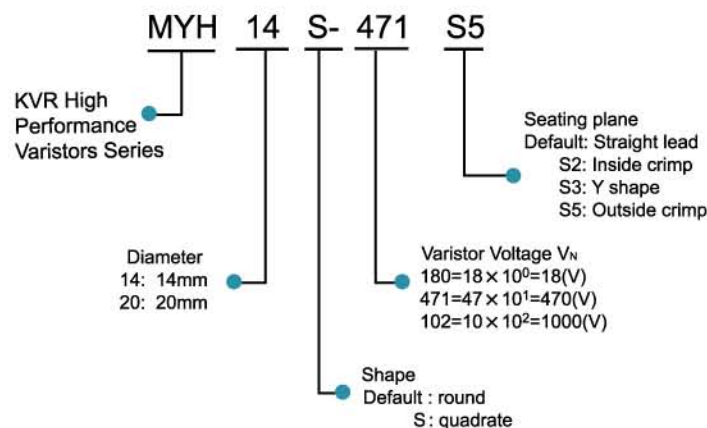

## Material Code Designation:

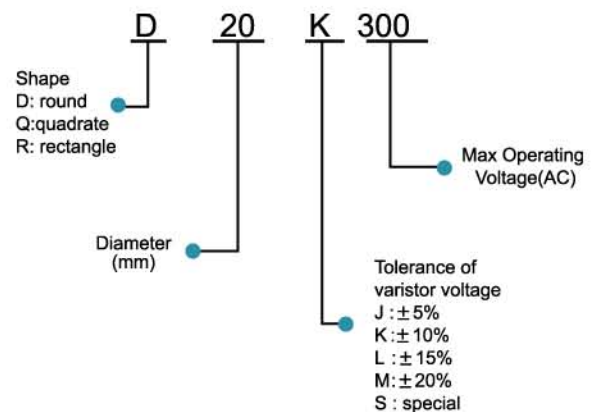

Type	Material code	Characteristics TA = +25 °C					Maximum ratings T =+85 C					V/I Characteristic curve	Derating Curve
		Varistor voltage	Tolerance	Clamping voltage at Ip (8/20µs)		Capacitance (1kHz)	Max continuous operating voltage		Max energy absorption (2ms)	Peak current (8/20µs)	Max power rating		
				VN (V)	ΔVN (± %)		VP (V)	Ip (A)				C (pF)	VRMS (V)
MYH14-201	D14K130	205	10	340	50.0	1150	130	170	45	8000	0.6	34	35
MYH20-201	D20K130	205	10	340	100.0	2300	130	170	90	12000	1.0	34	35
MYH14S-201	Q14K130	205	10	340	65.0	980	130	170	75	8000	0.6	34	35
MYH20S-201	Q20K130	205	10	340	130.0	1950	130	170	100	15000	1.0	34	36
MYH14-221	D14K140	220	10	360	50.0	1100	140	180	50	8000	0.6	34	35
MYH20-221	D20K140	220	10	360	100.0	2200	140	180	100	12000	1.0	34	35
MYH14S-221	Q14K140	220	10	360	65.0	900	140	180	80	8000	0.6	34	35
MYH20S-221	Q20K140	220	10	360	130.0	1800	140	180	110	15000	1.0	34	36
MYH14-241	D14K150	240	10	395	50.0	1050	150	200	55	8000	0.6	34	35
MYH20-241	D20K150	240	10	395	100.0	2200	150	200	110	12000	1.0	34	35
MYH14S-241	Q14K150	240	10	395	65.0	830	150	200	85	8000	0.6	34	35
MYH20S-241	Q20K150	240	10	395	130.0	1650	150	200	120	15000	1.0	34	36
MYH14-271	D14K175	270	10	455	50.0	1000	175	225	60	8000	0.6	34	35
MYH20-271	D20K175	270	10	455	100.0	2100	175	225	120	12000	1.0	34	35
MYH14S-271	Q14K175	270	10	455	65.0	750	175	225	100	8000	0.6	34	35
MYH20S-271	Q20K175	270	10	455	130.0	1500	175	225	135	15000	1.0	34	36
MYH14-331	D14K210	330	10	550	50.0	850	210	275	70	8000	0.6	34	35
MYH20-331	D20K210	330	10	550	100.0	1750	210	275	140	12000	1.0	34	35
MYH14S-331	Q14K210	330	10	550	65.0	600	210	275	115	8000	0.6	34	35
MYH20S-331	Q20K210	330	10	550	130.0	1200	210	275	165	15000	1.0	34	36
MYH14-361	D14K230	360	10	595	50.0	850	230	300	80	8000	0.6	34	35
MYH20-361	D20K230	360	10	595	100.0	1700	230	300	160	12000	1.0	34	35
MYH14S-361	Q14K230	360	10	595	65.0	550	230	300	130	8000	0.6	34	35
MYH20S-361	Q20K230	360	10	595	130.0	1100	230	300	180	15000	1.0	34	36
MYH14-391	D14K250	390	10	650	50.0	800	250	320	100	8000	0.6	34	35
MYH20-391	D20K250	390	10	650	100.0	1400	250	320	170	12000	1.0	34	35
MYH14S-391	Q14K250	390	10	650	65.0	500	250	320	140	8000	0.6	34	35
MYH20S-391	Q20K250	390	10	650	130.0	1000	250	320	195	15000	1.0	34	36
MYH14-431	D14K275	430	10	710	50.0	650	275	350	110	8000	0.6	34	35
MYH20-431	D20K275	430	10	710	100.0	1350	275	350	190	12000	1.0	34	35
MYH14S-431	Q14K275	430	10	710	65.0	470	275	350	150	8000	0.6	34	35
MYH20S-431	Q20K275	430	10	710	130.0	930	275	350	215	15000	1.0	34	36
MYH14-471	D14K300	470	10	775	50.0	550	300	385	120	8000	0.6	34	35
MYH20-471	D20K300	470	10	775	100.0	1200	300	385	210	12000	1.0	34	35
MYH14S-471	Q14K300	470	10	775	65.0	430	300	385	175	8000	0.6	34	35
MYH20S-471	Q20K300	470	10	775	130.0	850	300	385	235	15000	1.0	34	36
MYH14-511	D14K320	510	10	840	50.0	450	320	410	130	8000	0.6	34	35
MYH20-511	D20K320	510	10	840	100.0	1050	320	410	220	12000	1.0	34	35
MYH14S-511	Q14K320	510	10	840	65.0	390	320	410	185	8000	0.6	34	35
MYH20S-511	Q20K320	510	10	840	130.0	780	320	410	255	15000	1.0	34	36



Type	Dimensions							Certification				
	D <sub>max</sub> (mm)	H2 <sub>max</sub> (mm)	T <sub>max</sub> (mm)	W±1.0 (mm)	L <sub>min</sub> (mm)	l <sub>max</sub> (mm)	d±0.05 (mm)	CE	UL	VDE	SP	
MYH14-201	17.5	20	4.6	7.5	25.0	3.0	0.8					
MYH20-201	25.0	25	5.0	10.0	25.0	3.0	1.0					
MYH14S-201	17.5	20	5.0	7.5	25.0	3.0	0.8					
MYH20S-201	23.5	25	5.0	10.0	25.0	3.0	1.0					
MYH14-221	17.5	20	4.7	7.5	25.0	3.0	0.8					
MYH20-221	25.0	25	5.1	10.0	25.0	3.0	1.0					
MYH14S-221	17.5	20	5.1	7.5	25.0	3.0	0.8					
MYH20S-221	23.5	25	5.1	10.0	25.0	3.0	1.0					
MYH14-241	17.5	20	4.8	7.5	25.0	3.0	0.8					
MYH20-241	25.0	25	5.2	10.0	25.0	3.0	1.0					
MYH14S-241	17.5	20	5.2	7.5	25.0	3.0	0.8					
MYH20S-241	23.5	25	5.2	10.0	25.0	3.0	1.0					
MYH14-271	17.5	20	4.9	7.5	25.0	3.0	0.8					
MYH20-271	25.0	25	5.3	10.0	25.0	3.0	1.0					
MYH14S-271	17.5	20	5.3	7.5	25.0	3.0	0.8					
MYH20S-271	23.5	25	5.3	10.0	25.0	3.0	1.0					
MYH14-331	17.5	20	5.0	7.5	25.0	3.0	0.8					
MYH20-331	25.0	25	5.4	10.0	25.0	3.0	1.0					
MYH14S-331	17.5	20	5.4	7.5	25.0	3.0	0.8					
MYH20S-331	23.5	25	5.4	10.0	25.0	3.0	1.0					
MYH14-361	17.5	20	5.5	7.5	25.0	3.0	0.8					
MYH20-361	25.0	25	5.9	10.0	25.0	3.0	1.0					
MYH14S-361	17.5	20	5.9	7.5	25.0	3.0	0.8					
MYH20S-361	23.5	25	5.9	10.0	25.0	3.0	1.0					
MYH14-391	17.5	20	5.7	7.5	25.0	3.0	0.8					
MYH20-391	25.0	25	6.1	10.0	25.0	3.0	1.0					
MYH14S-391	17.5	20	6.1	7.5	25.0	3.0	0.8					
MYH20S-391	23.5	25	6.1	10.0	25.0	3.0	1.0					
MYH14-431	17.5	20	5.9	7.5	25.0	3.0	0.8					
MYH20-431	25.0	25	6.3	10.0	25.0	3.0	1.0					
MYH14S-431	17.5	20	6.3	7.5	25.0	3.0	0.8					
MYH20S-431	23.5	25	6.3	10.0	25.0	3.0	1.0					
MYH14-471	17.5	20	6.2	7.5	25.0	3.0	0.8					
MYH20-471	25.0	25	6.6	10.0	25.0	3.0	1.0					
MYH14S-471	17.5	20	6.6	7.5	25.0	3.0	0.8					
MYH20S-471	23.5	25	6.6	10.0	25.0	3.0	1.0					
MYH14-511	17.5	20	6.4	7.5	25.0	3.0	0.8					
MYH20-511	25.0	25	6.8	10.0	25.0	3.0	1.0					
MYH14S-511	17.5	20	6.8	7.5	25.0	3.0	0.8					
MYH20S-511	23.5	25	6.8	10.0	25.0	3.0	1.0					

## Products Description

MYL varistors are designed for heavy industrial electric products of extremely high demand on surge withstanding capacity. Providing excellent surge protection performance. The terminals are tinned copper wire or plate. It is widely used in building outdoor leading-in wires(such as: switchboard), mining, petrolatum equipments, power supply control, power transmission, telecommunication, networks, railway, motor control, etc.



## Construction and Features:

- Construction: Round or quadrate varistors element, Leaded or tinned copper plate;
- Coating materials: Epoxy resin, flame retardant to UL94V-0;
- Terminals: Tinned copper wire or plate;
- Package: Box.

## Approvals:

With safety certifications of UL, CE, etc.

## Key Characteristic Parameters:

Max AC Operating Voltage	$V_{RMS}(V)$	130~1000
Max Energy Absorption	$W_{max}(J)$	150~2278
Peak Current (8/20 $\mu$ s)	$I_{max}(kA)$	15~70
MOV Diameter	D (mm)	25~53

## Technical Data:

Characteristics	Parameters	Standards
Climatic Category	25/85/56	
LCT	-25 $^{\circ}C$	
UCT	+85 $^{\circ}C$	IEC68-2-3
Operating Temperature	-25 $^{\circ}C$ ~+85 $^{\circ}C$	CECC 42 000
Storage Temperature	-25 $^{\circ}C$ ~+110 $^{\circ}C$	
Electric Strength	$\geq 2500V(AC)$	CECC 42 000
Insulation Resistance	$\geq 10M\Omega$	CECC 42 000
Response Time	<25 ns	

## Type Designation:

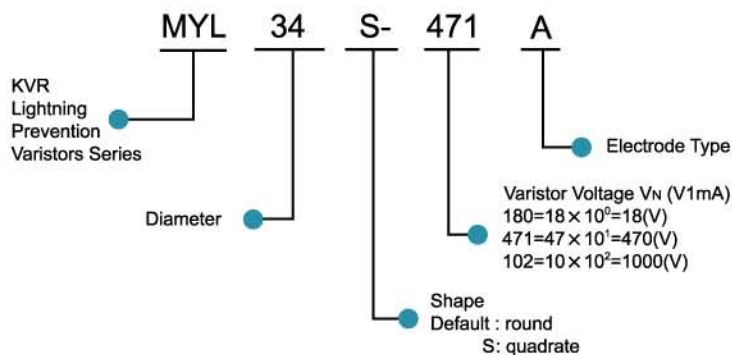

## Material Code Designation:

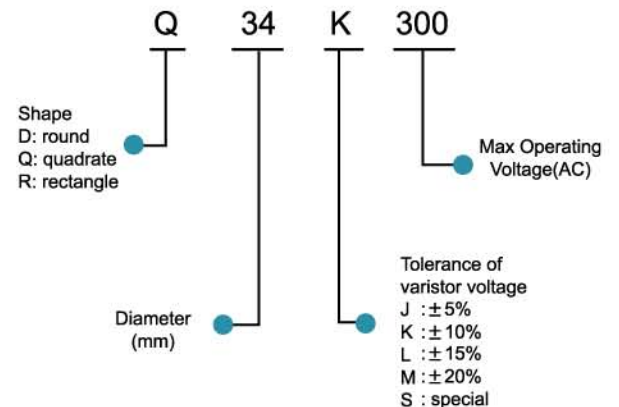



Type	Material code	Characteristics TA = +25 °C					Maximum ratings T =+85 C					V/I Characteristic curve	Derating Curve
		Varistor voltage	Tolerance	Clamping voltage at Ip (8/20µs)		Capacitance (1kHz)	Max continuous operating voltage		Max energy absorption (2ms)	Peak current (8/20µs)	Max power rating		
				VN (V)	ΔVN (±%)		Vp (V)	Ip (A)				C (pF)	VRMS (V)
MYL25-201	D25K130	205	10	340	150	3700	130	170	150	15000	1.0	51	55
MYL32-201	D32K130	205	10	340	200	4100	130	170	210	25000	1.2	52	55
MYL34S-201	Q34K130	205	10	340	300	7900	130	170	310	40000	1.4	53	56
MYL40-201	D40K130	205	10	340	300	8600	130	170	310	40000	1.4	53	56
MYL53-201	D53K130	205	10	340	500	14000	130	170	490	70000	1.5	54	56
MYL25-221	D25K140	220	10	360	150	3400	140	180	155	15000	1.0	51	55
MYL32-221	D32K140	220	10	360	200	3700	140	180	225	25000	1.2	52	55
MYL34S-221	Q34K140	220	10	360	300	7200	140	180	340	40000	1.4	53	56
MYL40-221	D40K140	220	10	360	300	7800	140	180	340	40000	1.4	53	56
MYL53-221	D53K140	220	10	360	500	12000	140	180	500	70000	1.5	54	56
MYL25-241	D25K150	240	10	395	150	3100	150	200	160	15000	1.0	51	55
MYL32-241	D32K150	240	10	395	200	3400	150	200	240	25000	1.2	52	55
MYL34S-241	Q34K150	240	10	395	300	6600	150	200	360	40000	1.4	53	56
MYL40-241	D40K150	240	10	395	300	7200	150	200	360	40000	1.4	53	56
MYL53-241	D53K150	240	10	395	500	11000	150	200	570	70000	1.5	54	56
MYL25-271	D25K175	270	10	455	150	2600	175	225	170	15000	1.0	51	55
MYL32-271	D32K175	270	10	455	200	2900	175	225	250	25000	1.2	52	55
MYL34S-271	Q34K175	270	10	455	300	5600	175	225	390	40000	1.4	53	56
MYL40-271	D40K175	270	10	455	300	6000	175	225	390	40000	1.4	53	56
MYL53-271	D53K175	270	10	455	500	10000	175	225	630	70000	1.5	54	56
MYL25-331	D25K210	330	10	550	150	2200	210	275	180	15000	1.0	51	55
MYL32-331	D32K210	330	10	550	200	2600	210	275	270	25000	1.2	52	55
MYL34S-331	Q34K210	330	10	550	300	5000	210	275	430	40000	1.4	53	56
MYL40-331	D40K210	330	10	550	300	5400	210	275	430	40000	1.4	53	56
MYL53-331	D53K210	330	10	550	500	8500	210	275	670	70000	1.5	54	56
MYL25-361	D25K230	360	10	595	150	2100	230	300	190	15000	1.0	51	55
MYL32-361	D32K230	360	10	595	200	2300	230	300	300	25000	1.2	52	55
MYL34S-361	Q34K230	360	10	595	300	4400	230	300	460	40000	1.4	53	56
MYL40-361	D40K230	360	10	595	300	4800	230	300	460	40000	1.4	53	56
MYL53-361	D53K230	360	10	595	500	7700	230	300	730	70000	1.5	54	56
MYL25-391	D25K250	390	10	650	150	1900	250	320	210	15000	1.0	51	55
MYL32-391	D32K250	390	10	650	200	2100	250	320	330	25000	1.2	52	55
MYL34S-391	Q34K250	390	10	650	300	4100	250	320	490	40000	1.4	53	56
MYL40-391	D40K250	390	10	650	300	4400	250	320	490	40000	1.4	53	56
MYL53-391	D53K250	390	10	650	500	7100	250	320	800	70000	1.5	54	56
MYL25-431	D25K275	430	10	710	150	1800	275	350	230	15000	1.0	51	56
MYL32-431	D32K275	430	10	710	200	2000	275	350	360	25000	1.2	52	56
MYL34S-431	Q34K275	430	10	710	300	3800	275	350	550	40000	1.4	53	56
MYL40-431	D40K275	430	10	710	300	4100	275	350	550	40000	1.4	53	56
MYL53-431	D53K275	430	10	710	500	6600	275	350	860	70000	1.5	54	56
MYL25-471	D25K300	470	10	775	150	1600	300	385	240	15000	1.0	51	55
MYL32-471	D32K300	470	10	775	200	1700	300	385	380	25000	1.2	52	55
MYL34S-471	Q34K300	470	10	775	300	3400	300	385	600	40000	1.4	53	56
MYL40-471	D40K300	470	10	775	300	3600	300	385	600	40000	1.4	53	56
MYL53-471	D53K300	470	10	775	500	5900	300	385	910	70000	1.5	54	56
MYL25-511	D25K320	510	10	840	150	1500	320	410	275	15000	1.0	51	55
MYL32-511	D32K320	510	10	840	200	1600	320	410	430	25000	1.2	52	55



Type	Material code	Characteristics TA = +25 °C					Maximum ratings T =+85 C					V/I Characteristic curve	Derating Curve
		Varistor voltage	Tolerance	Clamping voltage at Ip (8/20µs)		Capacitance (1kHz)	Max continuous operating voltage		Max energy absorption (2ms)	Peak current (8/20µs)	Max power rating		
				VN (V)	ΔVN (±%)		VP (V)	Ip (A)				C (pF)	VRMS (V)
MYL34S-511	Q34K320	510	10	840	300	3200	320	410	640	40000	1.4	53	56
MYL40-511	D40K320	510	10	840	300	3400	320	410	640	40000	1.4	53	56
MYL53-511	D53K320	510	10	840	500	5700	320	410	1000	70000	1.5	54	56
MYL25-561	D25K350	560	10	915	150	1300	350	460	300	15000	1.0	51	55
MYL32-561	D32K350	560	10	915	200	1400	350	460	490	25000	1.2	52	55
MYL34S-561	Q34K350	560	10	915	300	2900	350	460	710	40000	1.4	53	56
MYL40-561	D40K350	560	10	915	300	3100	350	460	710	40000	1.4	53	56
MYL53-561	D53K350	560	10	915	500	5000	350	460	1045	70000	1.5	54	56
MYL25-621	D25K385	620	10	1025	150	1200	385	505	320	15000	1.0	51	55
MYL32-621	D32K385	620	10	1025	200	1300	385	505	550	25000	1.2	52	55
MYL34S-621	Q34K385	620	10	1025	300	2600	385	505	800	40000	1.4	53	56
MYL40-621	D40K385	620	10	1025	300	2800	385	505	800	40000	1.4	53	56
MYL53-621	D53K385	620	10	1025	500	4600	385	505	1200	70000	1.5	54	56
MYL25-681	D25K420	680	10	1120	150	1100	420	560	360	15000	1.0	51	55
MYL32-681	D32K420	680	10	1120	200	1300	420	560	600	25000	1.2	52	55
MYL34S-681	Q34K420	680	10	1120	300	2400	420	560	910	40000	1.4	53	56
MYL40-681	D40K420	680	10	1120	300	2600	420	560	910	40000	1.4	53	56
MYL53-681	D53K420	680	10	1120	500	4400	420	560	1500	70000	1.5	54	56
MYL25-751	D25K460	750	10	1240	150	1000	460	615	390	15000	1.0	51	55
MYL32-751	D32K460	750	10	1240	200	1100	460	615	520	25000	1.2	52	55
MYL34S-751	Q34K460	750	10	1240	300	2200	460	615	960	40000	1.4	53	56
MYL40-751	D40K460	750	10	1240	300	2400	460	615	960	40000	1.4	53	56
MYL53-751	D53K460	750	10	1240	500	3900	460	615	1650	70000	1.5	54	56
MYL25-781	D25K485	780	10	1290	150	990	485	640	397	15000	1.0	51	55
MYL32-781	D32K485	780	10	1290	200	1100	485	640	550	25000	1.2	52	55
MYL34S-781	Q34K485	780	10	1290	300	2100	485	640	930	40000	1.4	53	56
MYL40-781	D40K485	780	10	1290	300	2270	485	640	930	40000	1.4	53	56
MYL53-781	D53K485	780	10	1290	500	3800	485	640	1248	70000	1.5	54	56
MYL25-821	D25K510	820	10	1355	150	930	510	670	410	15000	1.0	51	55
MYL32-821	D32K510	820	10	1355	200	1000	510	670	580	25000	1.2	52	55
MYL34S-821	Q34K510	820	10	1355	300	2000	510	670	940	40000	1.4	53	56
MYL40-821	D40K510	820	10	1355	300	2160	510	670	940	40000	1.4	53	56
MYL53-821	D53K510	820	10	1355	500	3500	510	670	1312	70000	1.5	54	56
MYL25-911	D25K550	910	10	1500	150	860	550	745	425	15000	1.0	51	55
MYL32-911	D32K550	910	10	1500	200	950	550	745	620	25000	1.2	52	55
MYL34S-911	Q34K550	910	10	1500	300	1800	550	745	960	40000	1.4	53	56
MYL40-911	D40K550	910	10	1500	300	1940	550	745	960	40000	1.4	53	56
MYL53-911	D53K550	910	10	1500	500	3300	550	745	1500	70000	1.5	54	56
MYL25-951	D25K580	950	10	1500	150	820	580	760	450	15000	1.0	51	55
MYL32-951	D32K580	950	10	1500	200	900	580	760	650	25000	1.2	52	55
MYL34S-951	Q34K580	950	10	1500	300	1700	580	760	1000	40000	1.4	53	56
MYL40-951	D40K580	950	10	1500	300	1800	580	760	1000	40000	1.4	53	56
MYL53-951	D53K580	950	10	1500	500	3100	580	760	1548	70000	1.5	54	56
MYL25-102	D25K625	1000	10	1650	150	760	625	825	480	15000	1.0	51	55
MYL32-102	D32K625	1000	10	1650	200	840	625	825	680	25000	1.2	52	55
MYL34S-102	Q34K625	1000	10	1650	300	1600	625	825	1040	40000	1.4	53	56
MYL40-102	D40K625	1000	10	1650	300	1730	625	825	1040	40000	1.4	53	56

Type	Material code	Characteristics TA = +25 °C					Maximum ratings T =+85 C					V/I Characteristic curve	Derating Curve
		Varistor voltage	Tolerance	Clamping voltage at I <sub>p</sub> (8/20µs)		Capacitance (1kHz)	Max continuous operating voltage		Max energy absorption (2ms)	Peak current (8/20µs)	Max power rating		
		V <sub>N</sub> (V)	ΔV <sub>N</sub> (±%)	V <sub>P</sub> (V)	I <sub>p</sub> (A)	C (pF)	V <sub>RMS</sub> (V)	V <sub>DC</sub> (V)	W <sub>max</sub> (J)	I <sub>max</sub> (A)	P <sub>max</sub> (W)	Page	Page
MYL53-102	D53K625	1000	10	1650	500	2900	625	825	1630	70000	1.5	54	56
MYL25-112	D25K680	1100	10	1815	150	690	680	895	525	15000	1.0	51	55
MYL32-112	D32K680	1100	10	1815	200	770	680	895	760	25000	1.2	52	55
MYL34S-112	Q34K680	1100	10	1815	300	1500	680	895	1100	40000	1.4	53	56
MYL40-112	D40K680	1100	10	1815	300	1620	680	895	1100	40000	1.4	53	56
MYL53-112	D53K680	1100	10	1815	500	2700	680	895	1800	70000	1.5	54	56
MYL25-122	D25K750	1200	10	2000	150	620	750	970	580	15000	1.0	51	55
MYL32-122	D32K750	1200	10	2000	200	690	750	970	800	25000	1.2	52	55
MYL34S-122	Q34K750	1200	10	2000	300	1300	750	970	1200	40000	1.4	53	56
MYL40-122	D40K750	1200	10	2000	300	1400	750	970	1200	40000	1.4	53	56
MYL53-122	D53K750	1200	10	2000	500	2400	750	970	1963	70000	1.5	54	56
MYL25-142	D25K880	1400	10	2290	150	540	880	1150	645	15000	1.0	51	55
MYL32-142	D32K880	1400	10	2290	200	590	880	1150	850	25000	1.2	52	55
MYL34S-142	Q34K880	1400	10	2290	300	1100	880	1150	1300	40000	1.4	53	56
MYL40-142	D40K880	1400	10	2290	300	1200	880	1150	1300	40000	1.4	53	56
MYL53-142	D53K880	1400	10	2290	500	2100	880	1150	2000	70000	1.5	54	56
MYL25-162	D25K900	1600	10	2550	150	470	900	1200	725	15000	1.0	51	55
MYL32-162	D32K900	1600	10	2550	200	520	900	1200	900	25000	1.2	52	55
MYL34S-162	Q34K900	1600	10	2550	300	1000	900	1200	1400	40000	1.4	53	56
MYL40-162	D40K900	1600	10	2550	300	1080	900	1200	1400	40000	1.4	53	56
MYL53-162	D53K900	1600	10	2550	500	1800	900	1200	2278	70000	1.5	54	56



Type	Dimensions (A type lead)								Certification			
	D <sub>max</sub> (mm)	H <sub>max</sub> (mm)	T <sub>max</sub> (mm)	W $\pm$ 1.0 (mm)	L $\pm$ 2.0 (mm)	l <sub>max</sub> (mm)	d $\pm$ 0.05 (mm)	e $\pm$ 1.0 (mm)	CE	RU	VDE	SP
MYL25-201A	29	30	8.2	12	35	3	1.2	3.7	★	★		
MYL32-201A	36	37	8.8	18	35	3	1.5	4.9	★	★		
MYL40-201A	45	46	8.8	20	35	3	1.5	4.9	★	★		
MYL25-221A	29	30	8.2	12	35	3	1.2	3.7	★	★		
MYL32-221A	36	37	8.8	18	35	3	1.5	4.9	★			
MYL40-221A	45	46	8.8	20	35	3	1.5	4.9	★	★		
MYL25-241A	29	30	8.4	12	35	3	1.2	3.9	★	★		
MYL32-241A	36	37	9.0	18	35	3	1.5	5.1	★	★		
MYL40-241A	45	46	9.0	20	35	3	1.5	5.1	★	★		
MYL25-271A	29	30	8.5	12	35	3	1.2	4.2	★	★		
MYL32-271A	36	37	9.1	18	35	3	1.5	5.2	★	★		
MYL40-271A	45	46	9.1	20	35	3	1.5	5.2	★	★		
MYL25-331A	29	30	8.7	12	35	3	1.2	4.3	★	★		
MYL32-331A	36	37	9.3	18	35	3	1.5	5.4	★	★		
MYL40-331A	45	46	9.3	20	35	3	1.5	5.4	★	★		
MYL25-361A	29	30	8.9	12	35	3	1.2	4.5	★	★		
MYL32-361A	36	37	9.5	18	35	3	1.5	5.6	★	★		
MYL40-361A	45	46	9.5	20	35	3	1.5	5.6	★	★		
MYL25-391A	29	30	9.1	12	35	3	1.2	4.7	★	★		
MYL32-391A	36	37	9.7	18	35	3	1.5	5.8	★	★		
MYL40-391A	45	46	9.7	20	35	3	1.5	5.8	★	★		
MYL25-431A	29	30	9.3	12	35	3	1.2	5.0	★	★		
MYL32-431A	36	37	9.9	18	35	3	1.5	6.0	★	★		
MYL40-431A	45	46	9.9	20	35	3	1.5	6.0	★	★		
MYL25-471A	29	30	9.5	12	35	3	1.2	5.2	★	★		
MYL32-471A	36	37	10.1	18	35	3	1.5	6.2	★	★		
MYL40-471A	45	46	10.1	20	35	3	1.5	6.2	★	★		
MYL25-511A	29	30	9.8	12	35	3	1.2	5.5	★	★		
MYL32-511A	36	37	10.4	18	35	3	1.5	6.5	★	★		
MYL40-511A	45	46	10.4	20	35	3	1.5	6.5	★	★		
MYL25-561A	29	30	10.1	12	35	3	1.2	5.8	★	★		
MYL32-561A	36	37	10.7	18	35	3	1.5	6.8	★			
MYL40-561A	45	46	10.7	20	35	3	1.5	6.8	★	★		
MYL25-621A	29	30	10.4	12	35	3	1.2	6.2	★			
MYL32-621A	36	37	11.0	18	35	3	1.5	7.1	★	★		
MYL40-621A	45	46	11.0	20	35	3	1.5	7.1	★	★		
MYL25-681A	29	30	10.8	12	35	3	1.2	6.6	★	★		
MYL32-681A	36	37	11.4	18	35	3	1.5	7.5	★	★		
MYL40-681A	45	46	11.4	20	35	3	1.5	7.5	★	★		
MYL25-751A	29	30	11.2	12	35	3	1.2	6.8	★	★		
MYL32-751A	36	37	11.8	18	35	3	1.5	7.9	★	★		
MYL40-751A	45	46	11.8	20	35	3	1.5	7.9	★	★		
MYL25-781A	29	30	11.4	12	35	3	1.2	7.0	★	★		
MYL32-781A	36	37	12.0	18	35	3	1.5	8.0	★	★		
MYL40-781A	45	46	12.0	20	35	3	1.5	8.0	★	★		
MYL25-821A	29	30	11.6	12	35	3	1.2	7.6	★	★		
MYL32-821A	36	37	12.2	18	35	3	1.5	8.3	★	★		

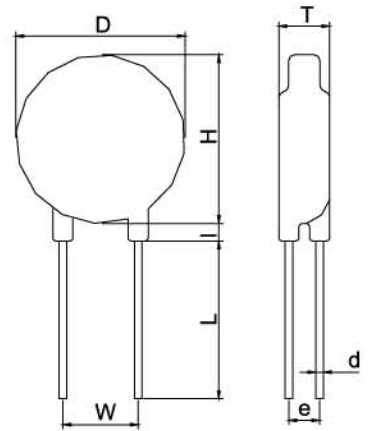



Type	Dimensions (A type lead)								Certification			
	D <sub>max</sub> (mm)	H <sub>max</sub> (mm)	T <sub>max</sub> (mm)	W±1.0 (mm)	L±2.0 (mm)	l <sub>max</sub> (mm)	d±0.05 (mm)	e±1.0 (mm)	CE	UL	VDE	SP
MYL40-821A	45	46	12.2	20	35	3	1.5	8.3	★	★		
MYL25-911A	29	30	12.1	12	35	3	1.2	7.8	★	★		
MYL32-911A	36	37	12.7	18	35	3	1.5	8.8	★	★		
MYL40-911A	45	46	12.7	20	35	3	1.5	8.8	★	★		
MYL25-951A	29	30	12.4	12	35	3	1.2	8.1	★			
MYL32-951A	36	37	12.9	18	35	3	1.5	9.0	★	★		
MYL40-951A	45	46	12.9	20	35	3	1.5	9.0	★	★		
MYL25-102A	29	30	12.6	12	35	3	1.2	8.7	★	★		
MYL32-102A	36	37	13.2	18	35	3	1.5	9.3	★	★		
MYL40-102A	45	46	13.2	20	35	3	1.5	9.3	★	★		
MYL25-112A	29	30	13.1	12	35	3	1.2	9.3	★	★		
MYL32-112A	36	37	13.7	18	35	3	1.5	9.8	★	★		
MYL40-112A	45	46	13.7	20	35	3	1.5	9.8	★	★		
MYL25-122A	29	30	14.2	12	35	3	1.2	10.4	★	★		
MYL32-122A	36	37	14.8	18	35	3	1.5	10.9	★	★		
MYL40-122A	45	46	14.8	20	35	3	1.5	10.9	★	★		
MYL25-142A	29	30	15.2	12	35	3	1.2	11.6	★	★		
MYL32-142A	36	37	15.8	18	35	3	1.5	11.9	★	★		
MYL40-142A	45	46	15.8	20	35	3	1.5	11.9	★			
MYL25-162A	29	30	16.3	12	35	3	1.2	12.8	★	★		
MYL32-162A	36	37	16.9	18	35	3	1.5	13.0	★	★		
MYL40-162A	45	46	16.9	20	35	3	1.5	13.0	★			

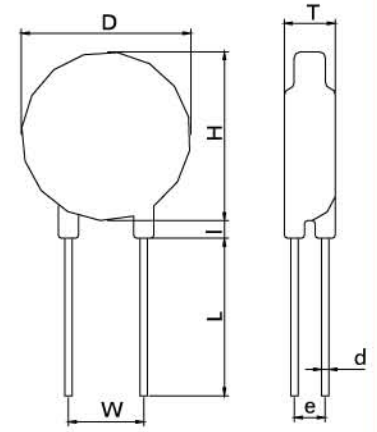

Type	Dimensions (B type lead)										Certification			
	D <sub>max</sub> (mm)	H <sub>max</sub> (mm)	T <sub>max</sub> (mm)	W $\pm$ 1.0 (mm)	B $\pm$ 0.1 (mm)	L <sub>min</sub> (mm)	l <sub>max</sub> (mm)	d $\pm$ 0.1 (mm)	A $\pm$ 1.0 (mm)	e $\pm$ 1.0 (mm)	CE	UL	VDE	SP
MYL25-201B	29	52	6.8	25.4	7.1	12.7	3.0	3.8	0.5	4.9	★	★		
MYL32-201B	36	53	6.8	25.4	7.1	12.7	3.0	3.8	0.5	4.9	★	★		
MYL34S-201B	37	56	6.8	25.4	7.1	12.7	6.0	3.8	0.5	4.9	★	★		
MYL40-201B	45	60	6.8	25.4	7.1	12.0	3.0	3.8	0.5	4.9	★	★		
MYL53-201B	60	78	6.8	25.4	9.5	8.5	3.0	3.8	0.5	4.9		★		
MYL25-221B	29	52	6.8	25.4	7.1	12.7	3.0	3.8	0.5	4.9	★	★		
MYL32-221B	36	53	6.8	25.4	7.1	12.7	3.0	3.8	0.5	4.9	★			
MYL34S-221B	37	56	6.8	25.4	7.1	12.7	6.0	3.8	0.5	5.0	★	★		
MYL40-221B	45	60	6.8	25.4	7.1	12.0	3.0	3.8	0.5	4.9	★	★		
MYL53-221B	60	78	6.8	25.4	9.5	8.5	3.0	3.8	0.5	4.9				
MYL25-241B	29	52	7.0	25.4	7.1	12.7	3.0	3.8	0.5	5.1	★	★		
MYL32-241B	36	53	7.0	25.4	7.1	12.7	3.0	3.8	0.5	5.1	★	★		
MYL34S-241B	37	56	7.0	25.4	7.1	12.7	6.0	3.8	0.5	5.1	★	★		
MYL40-241B	45	60	7.0	25.4	7.1	12.0	3.0	3.8	0.5	5.1	★	★		
MYL53-241B	60	78	7.0	25.4	9.5	8.5	3.0	3.8	0.5	5.1				★
MYL25-271B	29	52	7.1	25.4	7.1	12.7	3.0	3.8	0.5	5.2	★	★		
MYL32-271B	36	53	7.1	25.4	7.1	12.7	3.0	3.8	0.5	5.2	★	★		
MYL34S-271B	37	56	7.1	25.4	7.1	12.7	6.0	3.8	0.5	5.2	★	★		
MYL40-271B	45	60	7.1	25.4	7.1	12.0	3.0	3.8	0.5	5.2	★	★		
MYL53-271B	60	78	7.1	25.4	9.5	8.5	3.0	3.8	0.5	5.2				★
MYL25-331B	29	52	7.3	25.4	7.1	12.7	3.0	3.8	0.5	5.4	★	★		
MYL32-331B	36	53	7.3	25.4	7.1	12.7	3.0	3.8	0.5	5.4	★	★		
MYL34S-331B	37	56	7.3	25.4	7.1	12.7	6.0	3.8	0.5	5.4	★	★		
MYL40-331B	45	60	7.3	25.4	7.1	12.0	3.0	3.8	0.5	5.4	★	★		
MYL53-331B	60	78	7.3	25.4	9.5	8.5	3.0	3.8	0.5	5.4				★
MYL25-361B	29	52	7.5	25.4	7.1	12.7	3.0	3.8	0.5	5.6	★	★		
MYL32-361B	36	53	7.5	25.4	7.1	12.7	3.0	3.8	0.5	5.6	★	★		
MYL34S-361B	37	56	7.5	25.4	7.1	12.7	6.0	3.8	0.5	5.6	★	★		
MYL40-361B	45	60	7.5	25.4	7.1	12.0	3.0	3.8	0.5	5.6	★	★		
MYL53-361B	60	78	7.5	25.4	9.5	8.5	3.0	3.8	0.5	5.6				★
MYL25-391B	29	52	7.7	25.4	7.1	12.7	3.0	3.8	0.5	5.8	★	★		
MYL32-391B	36	53	7.7	25.4	7.1	12.7	3.0	3.8	0.5	5.8	★	★		
MYL34S-391B	37	56	7.7	25.4	7.1	12.7	6.0	3.8	0.5	5.8	★	★		
MYL40-391B	45	60	7.7	25.4	7.1	12.0	3.0	3.8	0.5	5.8	★	★		
MYL53-391B	60	78	7.7	25.4	9.5	8.5	3.0	3.8	0.5	5.8				★
MYL25-431B	29	52	7.9	25.4	7.1	12.7	3.0	3.8	0.5	6.0	★	★		
MYL32-431B	36	53	7.9	25.4	7.1	12.7	3.0	3.8	0.5	6.0	★	★		
MYL34S-431B	37	56	7.9	25.4	7.1	12.7	6.0	3.8	0.5	6.0	★	★		
MYL40-431B	45	60	7.9	25.4	7.1	12.0	3.0	3.8	0.5	6.0	★	★		
MYL53-431B	60	78	7.9	25.4	9.5	8.5	3.0	3.8	0.5	6.0				★
MYL25-471B	29	52	8.1	25.4	7.1	12.7	3.0	3.8	0.5	6.2	★	★		
MYL32-471B	36	53	8.1	25.4	7.1	12.7	3.0	3.8	0.5	6.2	★	★		
MYL34S-471B	37	56	8.1	25.4	7.1	12.7	6.0	3.8	0.5	6.2	★	★		
MYL40-471B	45	60	8.1	25.4	7.1	12.0	3.0	3.8	0.5	6.2	★	★		
MYL53-471B	60	78	8.1	25.4	9.5	8.5	3.0	3.8	0.5	6.2				★
MYL25-511B	29	52	8.4	25.4	7.1	12.7	3.0	3.8	0.5	6.5	★	★		
MYL32-511B	36	53	8.4	25.4	7.1	12.7	3.0	3.8	0.5	6.5	★	★		

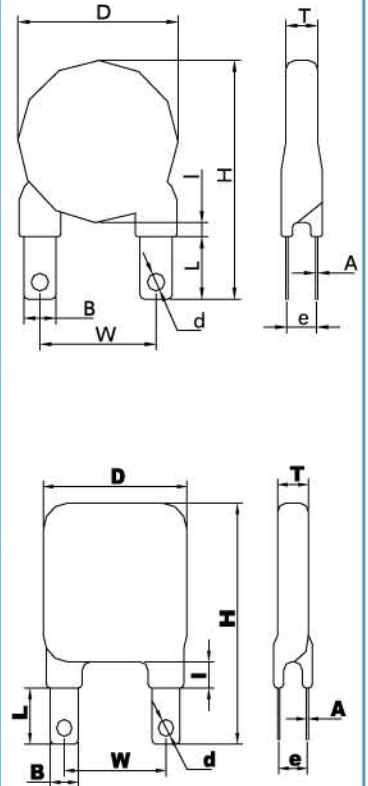



Type	Dimensions (B type lead)										Certification			
	D <sub>max</sub> (mm)	H <sub>max</sub> (mm)	T <sub>max</sub> (mm)	W±1.0 (mm)	B±0.1 (mm)	L <sub>min</sub> (mm)	l <sub>max</sub> (mm)	d±0.1 (mm)	A±1.0 (mm)	e±1.0 (mm)	CE	UL	VDE	SP
MYL34S-511B	37	56	8.4	25.4	7.1	12.7	6.0	3.8	0.5	6.5	★	★		
MYL40-511B	45	60	8.4	25.4	7.1	12.0	3.0	3.8	0.5	6.5	★	★		
MYL53-511B	60	78	8.4	25.4	9.5	8.5	3.0	3.8	0.5	6.5		★		
MYL25-561B	29	52	8.7	25.4	7.1	12.7	3.0	3.8	0.5	6.8	★	★		
MYL32-561B	36	53	8.7	25.4	7.1	12.7	3.0	3.8	0.5	6.8	★			
MYL34S-561B	37	56	8.7	25.4	7.1	12.7	6.0	3.8	0.5	6.8	★	★		
MYL40-561B	45	60	8.7	25.4	7.1	12.0	3.0	3.8	0.5	6.8	★	★		
MYL53-561B	60	78	8.7	25.4	9.5	8.5	3.0	3.8	0.5	6.8		★		
MYL25-621B	29	52	9.0	25.4	7.1	12.7	3.0	3.8	0.5	7.1	★			
MYL32-621B	36	53	9.0	25.4	7.1	12.7	3.0	3.8	0.5	7.1	★	★		
MYL34S-621B	37	56	9.0	25.4	7.1	12.7	6.0	3.8	0.5	7.1	★	★		
MYL40-621B	45	60	9.0	25.4	7.1	12.0	3.0	3.8	0.5	7.1	★	★		
MYL53-621B	60	78	9.0	25.4	9.5	8.5	3.0	3.8	0.5	7.1		★		
MYL25-681B	29	52	9.4	25.4	7.1	12.7	3.0	3.8	0.5	7.5	★	★		
MYL32-681B	36	53	9.4	25.4	7.1	12.7	3.0	3.8	0.5	7.5	★	★		
MYL34S-681B	37	56	9.4	25.4	7.1	12.7	6.0	3.8	0.5	7.5	★	★		
MYL40-681B	45	60	9.4	25.4	7.1	12.0	3.0	3.8	0.5	7.5	★	★		
MYL53-681B	60	78	9.4	25.4	9.5	8.5	3.0	3.8	0.5	7.5		★		
MYL25-751B	29	52	9.8	25.4	7.1	12.7	3.0	3.8	0.5	7.9	★	★		
MYL32-751B	36	53	9.8	25.4	7.1	12.7	3.0	3.8	0.5	7.9	★	★		
MYL34S-751B	37	56	9.8	25.4	7.1	12.7	6.0	3.8	0.5	7.9	★	★		
MYL40-751B	45	60	9.8	25.4	7.1	12.0	3.0	3.8	0.5	7.9	★	★		
MYL53-751B	60	78	9.8	25.4	9.5	8.5	3.0	3.8	0.5	7.9		★		
MYL25-781B	29	52	9.8	25.4	7.1	12.7	3.0	3.8	0.5	8.0	★	★		
MYL32-781B	36	53	9.9	25.4	7.1	12.7	3.0	3.8	0.5	8.0	★	★		
MYL34S-781B	37	56	10.0	25.4	7.1	12.7	6.0	3.8	0.5	8.0	★	★		
MYL40-781B	45	60	9.9	25.4	7.1	12.0	3.0	3.8	0.5	8.0	★	★		
MYL53-781B	60	78	10.0	25.4	9.5	8.5	3.0	3.8	0.5	8.0		★		
MYL25-821B	29	52	10.2	25.4	7.1	12.7	3.0	3.8	0.5	8.3	★	★		
MYL32-821B	36	53	10.2	25.4	7.1	12.7	3.0	3.8	0.5	8.3	★	★		
MYL34S-821B	37	56	10.2	25.4	7.1	12.7	6.0	3.8	0.5	8.3	★	★		
MYL40-821B	45	60	10.2	25.4	7.1	12.0	3.0	3.8	0.5	8.3	★	★		
MYL53-821B	60	78	10.2	25.4	9.5	8.5	3.0	3.8	0.5	8.3		★		
MYL25-911B	29	52	10.7	25.4	7.1	12.7	3.0	3.8	0.5	8.8	★	★		
MYL32-911B	36	53	10.7	25.4	7.1	12.7	3.0	3.8	0.5	8.8	★	★		
MYL34S-911B	37	56	10.7	25.4	7.1	12.7	6.0	3.8	0.5	8.8	★	★		
MYL40-911B	45	60	10.7	25.4	7.1	12.0	3.0	3.8	0.5	8.8	★	★		
MYL53-911B	60	78	10.7	25.4	9.5	8.5	3.0	3.8	0.5	8.8		★		
MYL25-951B	29	52	10.8	25.4	7.1	12.7	3.0	3.8	0.5	8.9	★			
MYL32-951B	36	53	10.8	25.4	7.1	12.7	3.0	3.8	0.5	8.9	★	★		
MYL34S-951B	37	56	11.0	25.4	7.1	12.7	6.0	3.8	0.5	9.0	★	★		
MYL40-951B	45	60	10.8	25.4	7.1	12.0	3.0	3.8	0.5	8.9	★	★		
MYL53-951B	60	78	10.9	25.4	9.5	8.5	3.0	3.8	0.5	9.0		★		
MYL25-102B	29	52	11.2	25.4	7.1	12.7	3.0	3.8	0.5	9.3	★	★		
MYL32-102B	36	53	11.2	25.4	7.1	12.7	3.0	3.8	0.5	9.3	★	★		
MYL34S-102B	37	56	11.2	25.4	7.1	12.7	6.0	3.8	0.5	9.3	★	★		
MYL40-102B	45	60	11.2	25.4	7.1	12.0	3.0	3.8	0.5	9.3	★	★		

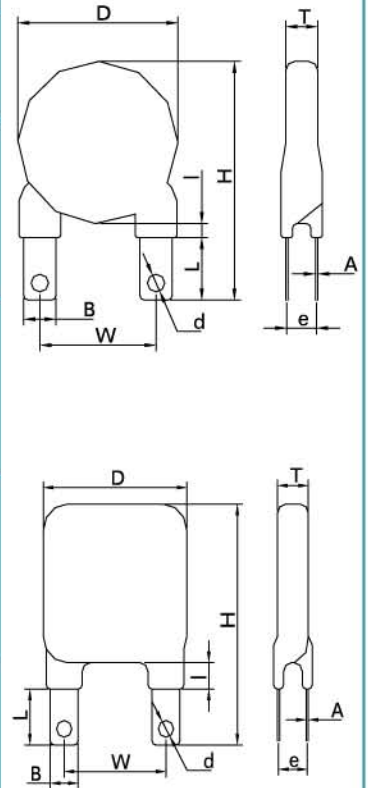

Type	Dimensions (B type lead)										Certification			
	D <sub>max</sub> (mm)	H <sub>max</sub> (mm)	T <sub>max</sub> (mm)	W $\pm$ 1.0 (mm)	B $\pm$ 0.1 (mm)	L <sub>min</sub> (mm)	l <sub>max</sub> (mm)	d $\pm$ 0.1 (mm)	A $\pm$ 1.0 (mm)	e $\pm$ 1.0 (mm)	CE	UL	VDE	CS
MYL53-102B	60	78	11.2	25.4	9.5	8.5	3.0	3.8	0.5	9.3	★	★	★	★
MYL25-112B	29	52	11.7	25.4	7.1	12.7	3.0	3.8	0.5	9.8	★	★	★	★
MYL32-112B	36	53	11.7	25.4	7.1	12.7	3.0	3.8	0.5	9.8	★	★	★	★
MYL34S-112B	37	56	11.7	25.4	7.1	12.7	6.0	3.8	0.5	9.8	★	★	★	★
MYL40-112B	45	60	11.7	25.4	7.1	12.0	3.0	3.8	0.5	9.8	★	★	★	★
MYL53-112B	60	78	11.7	25.4	9.5	8.5	3.0	3.8	0.5	9.8	★	★	★	★
MYL25-122B	29	52	12.8	25.4	7.1	12.7	3.0	3.8	0.5	10.9	★	★	★	★
MYL32-122B	36	53	12.8	25.4	7.1	12.7	3.0	3.8	0.5	10.9	★	★	★	★
MYL34S-122B	37	56	12.8	25.4	7.1	12.7	6.0	3.8	0.5	10.9	★	★	★	★
MYL40-122B	45	60	12.8	25.4	7.1	12.0	3.0	3.8	0.5	10.9	★	★	★	★
MYL53-122B	60	78	12.8	25.4	9.5	8.5	3.0	3.8	0.5	10.9	★	★	★	★
MYL25-142B	29	52	13.8	25.4	7.1	12.7	3.0	3.8	0.5	11.9	★	★	★	★
MYL32-142B	36	53	13.8	25.4	7.1	12.7	3.0	3.8	0.5	11.9	★	★	★	★
MYL34S-142B	37	56	13.8	25.4	7.1	12.7	6.0	3.8	0.5	11.9	★	★	★	★
MYL40-142B	45	60	13.8	25.4	7.1	12.0	3.0	3.8	0.5	11.9	★	★	★	★
MYL53-142B	60	78	13.8	25.4	9.5	8.5	3.0	3.8	0.5	11.9	★	★	★	★
MYL25-162B	29	52	14.9	25.4	7.1	12.7	3.0	3.8	0.5	13.0	★	★	★	★
MYL32-162B	36	53	14.9	25.4	7.1	12.7	3.0	3.8	0.5	13.0	★	★	★	★
MYL34S-162B	37	56	14.9	25.4	7.1	12.7	6.0	3.8	0.5	13.0	★	★	★	★
MYL40-162B	45	60	14.9	25.4	7.1	12.0	3.0	3.8	0.5	13.0	★	★	★	★
MYL53-162B	60	78	14.9	25.4	9.5	8.5	3.0	3.8	0.5	13.0	★	★	★	★

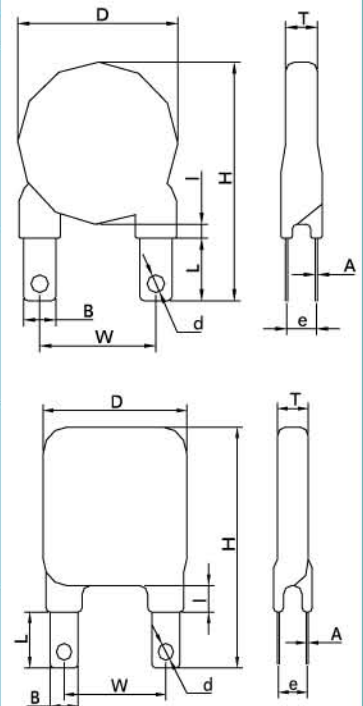



Type	Dimensions (D type lead)								Certification			
	D <sub>max</sub> (mm)	H <sub>max</sub> (mm)	T <sub>max</sub> (mm)	W $\pm$ 1.0 (mm)	B $\pm$ 0.1 (mm)	L <sub>max</sub> (mm)	e $\pm$ 1.0 (mm)	A $\pm$ 0.1 (mm)	CE	UL	VDE	SP
MYL34S-201D	37	47.5	6.8	22	6	5	6.7	0.5	★	★		
MYL34S-221D	37	47.5	6.8	22	6	5	6.8	0.5	★	★		
MYL34S-241D	37	47.5	7.0	22	6	5	7.0	0.5	★	★		
MYL34S-271D	37	47.5	7.1	22	6	5	7.2	0.5	★	★		
MYL34S-331D	37	47.5	7.3	22	6	5	7.4	0.5	★	★		
MYL34S-361D	37	47.5	7.5	22	6	5	7.5	0.5	★	★		
MYL34S-391D	37	47.5	7.7	22	6	5	7.9	0.5	★	★		
MYL34S-431D	37	47.5	7.9	22	6	5	8.2	0.5	★	★		
MYL34S-471D	37	47.5	8.1	22	6	5	8.4	0.5	★	★		
MYL34S-511D	37	47.5	8.4	22	6	5	8.7	0.5	★	★		
MYL34S-561D	37	47.5	8.7	22	6	5	9.0	0.5	★	★		
MYL34S-621D	37	47.5	9.0	22	6	5	9.4	0.5	★	★		
MYL34S-681D	37	47.5	9.4	22	6	5	9.5	0.5	★	★		
MYL34S-751D	37	47.5	9.8	22	6	5	9.9	0.5	★	★		
MYL34S-781D	37	47.5	10.0	22	6	5	10.2	0.5	★	★		
MYL34S-821D	37	47.5	10.2	22	6	5	10.7	0.5	★	★		
MYL34S-911D	37	47.5	10.7	22	6	5	10.9	0.5	★	★		
MYL34S-951D	37	47.5	11.0	22	6	5	11.2	0.5	★	★		
MYL34S-102D	37	47.5	11.2	22	6	5	11.8	0.5	★	★		
MYL34S-112D	37	47.5	11.7	22	6	5	12.3	0.5	★	★		
MYL34S-122D	37	47.5	12.8	22	6	5	13.5	0.5	★	★		
MYL34S-142D	37	47.5	13.8	22	6	5	14.6	0.5	★	★		
MYL34S-162D	37	47.5	14.9	22	6	5	15.7	0.5	★	★		

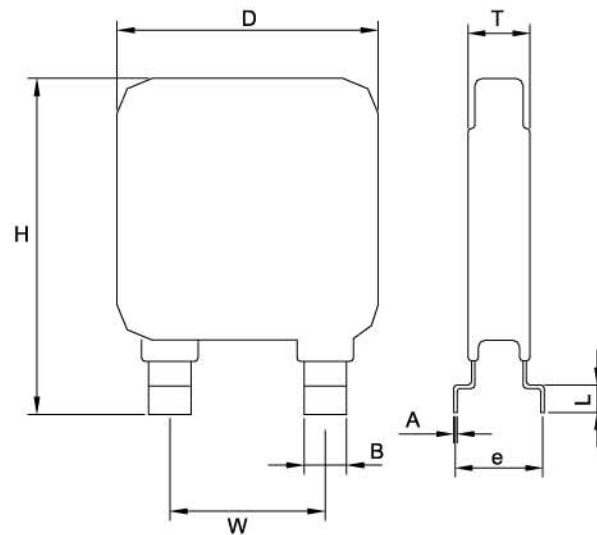

Type	Dimensions (E type lead)									Certification			
	D <sub>max</sub> (mm)	H <sub>max</sub> (mm)	T <sub>max</sub> (mm)	W±1.0 (mm)	B±0.1 (mm)	l <sub>max</sub> (mm)	d±0.1 (mm)	A±0.1 (mm)	Y±1.0 (mm)	CE	UL	VDE	SP
MYL34S-201E	37	49	6.8	25.4	7.06	6	3.8	0.5	5.2	★	★		
MYL40-201E	45	55	6.8	25.4	7.06	6	3.8	0.5	5.2	★	★		
MYL34S-221E	37	49	6.8	25.4	7.06	6	3.8	0.5	5.2	★	★		
MYL40-221E	45	55	6.8	25.4	7.06	6	3.8	0.5	5.2	★	★		
MYL34S-241E	37	49	7.0	25.4	7.06	6	3.8	0.5	5.1	★	★		
MYL40-241E	45	55	7.0	25.4	7.06	6	3.8	0.5	5.1	★	★		
MYL34S-271E	37	49	7.1	25.4	7.06	6	3.8	0.5	4.8	★	★		
MYL40-271E	45	55	7.1	25.4	7.06	6	3.8	0.5	4.8	★	★		
MYL34S-331E	37	49	7.3	25.4	7.06	6	3.8	0.5	4.6	★	★		
MYL40-331E	45	55	7.3	25.4	7.06	6	3.8	0.5	4.6	★	★		
MYL34S-361E	37	49	7.5	25.4	7.06	6	3.8	0.5	4.5	★	★		
MYL40-361E	45	55	7.5	25.4	7.06	6	3.8	0.5	4.5	★	★		
MYL34S-391E	37	49	7.7	25.4	7.06	6	3.8	0.5	4.3	★	★		
MYL40-391E	45	55	7.7	25.4	7.06	6	3.8	0.5	4.3	★	★		
MYL34S-431E	37	49	7.9	25.4	7.06	6	3.8	0.5	4.2	★	★		
MYL40-431E	45	55	7.9	25.4	7.06	6	3.8	0.5	4.2	★	★		
MYL34S-471E	37	49	8.1	25.4	7.06	6	3.8	0.5	3.9	★	★		
MYL40-471E	45	55	8.1	25.4	7.06	6	3.8	0.5	3.9	★	★		
MYL34S-511E	37	49	8.4	25.4	7.06	6	3.8	0.5	3.8	★	★		
MYL40-511E	45	55	8.4	25.4	7.06	6	3.8	0.5	3.8	★	★		
MYL34S-561E	37	49	8.7	25.4	7.06	6	3.8	0.5	3.5	★	★		
MYL40-561E	45	55	8.7	25.4	7.06	6	3.8	0.5	3.5	★	★		
MYL34S-621E	37	49	9.0	25.4	7.06	6	3.8	0.5	3.5	★	★		
MYL40-621E	45	55	9.0	25.4	7.06	6	3.8	0.5	3.5	★	★		
MYL34S-681E	37	49	9.4	25.4	7.06	6	3.8	0.5	3.3	★	★		
MYL40-681E	45	55	9.4	25.4	7.06	6	3.8	0.5	3.3	★	★		
MYL34S-751E	37	49	9.8	25.4	7.06	6	3.8	0.5	2.8	★	★		
MYL40-751E	45	55	9.8	25.4	7.06	6	3.8	0.5	2.8	★	★		
MYL34S-781E	37	49	10.0	25.4	7.06	6	3.8	0.5	2.7	★	★		
MYL40-781E	45	55	10.0	25.4	7.06	6	3.8	0.5	2.7	★	★		
MYL34S-821E	37	49	10.2	25.4	7.06	6	3.8	0.5	2.5	★	★		
MYL40-821E	45	55	10.2	25.4	7.06	6	3.8	0.5	2.5	★	★		
MYL34S-911E	37	49	10.7	25.4	7.06	6	3.8	0.5	2.3	★	★		
MYL40-911E	45	55	10.7	25.4	7.06	6	3.8	0.5	2.3	★	★		
MYL34S-951E	37	49	11.0	25.4	7.06	6	3.8	0.5	2.0	★	★		
MYL40-951E	45	55	11.0	25.4	7.06	6	3.8	0.5	2.0	★	★		
MYL34S-102E	37	49	11.2	25.4	7.06	6	3.8	0.5	1.7	★	★		
MYL40-102E	45	55	11.2	25.4	7.06	6	3.8	0.5	1.7	★	★		
MYL34S-112E	37	49	11.7	25.4	7.06	6	3.8	0.5	1.3	★	★		
MYL40-112E	45	55	11.7	25.4	7.06	6	3.8	0.5	1.3	★	★		
MYL34S-122E	37	49	12.8	25.4	7.06	6	3.8	0.5	0.6	★	★		
MYL40-122E	45	55	12.8	25.4	7.06	6	3.8	0.5	0.6	★	★		
MYL34S-142E	37	49	13.8	25.4	7.06	6	3.8	0.5	-0.3	★	★		
MYL40-142E	45	55	13.8	25.4	7.06	6	3.8	0.5	-0.3	★	★		
MYL34S-162E	37	49	14.9	25.4	7.06	6	3.8	0.5	-1.2	★	★		
MYL40-162E	45	55	14.9	25.4	7.06	6	3.8	0.5	-1.2	★	★		

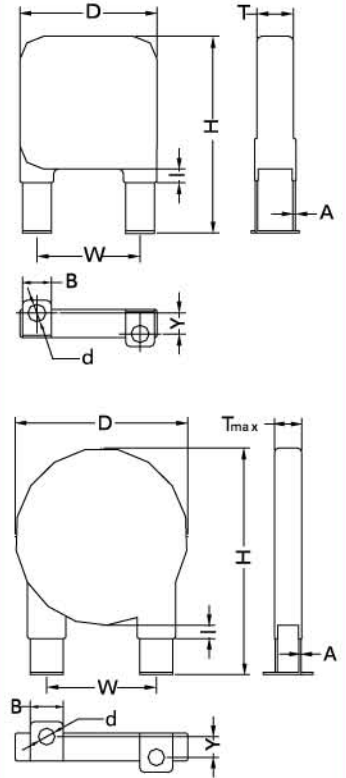



Type	Dimensions (F type lead)											Certification			
	D <sub>max</sub> (mm)	H <sub>max</sub> (mm)	T <sub>max</sub> (mm)	W±1.0 (mm)	B±0.1 (mm)	L <sub>min</sub> (mm)	l <sub>max</sub> (mm)	d±0.1 (mm)	A±0.1 (mm)	Y±1.0 (mm)	Y1±1.0 (mm)	CE	UL	VDE	SP
MYL34S-201F	37	56	8.3	25.4	7.06	12.0	6	3.8	0.5	4.7	2.35				
MYL40-201F	45	60	8.3	25.4	7.06	8.0	6	3.8	0.5	4.7	2.35				
MYL34S-221F	37	56	8.4	25.4	7.06	12.0	6	3.8	0.5	4.9	2.45				
MYL40-221F	45	60	8.4	25.4	7.06	8.0	6	3.8	0.5	4.9	2.45				
MYL34S-241F	37	56	8.7	25.4	7.06	12.0	6	3.8	0.5	5.1	2.55				
MYL40-241F	45	60	8.7	25.4	7.06	8.0	6	3.8	0.5	5.1	2.55				
MYL34S-271F	37	56	9.1	25.4	7.06	12.0	6	3.8	0.5	5.5	2.75				
MYL40-271F	45	60	9.1	25.4	7.06	8.0	6	3.8	0.5	5.5	2.75				
MYL34S-331F	37	56	10.0	25.4	7.06	12.0	6	3.8	0.5	6.2	3.10				
MYL40-331F	45	60	10.0	25.4	7.06	8.0	6	3.8	0.5	6.2	3.10				
MYL34S-361F	37	56	10.4	25.4	7.06	12.0	6	3.8	0.5	6.5	3.25				
MYL40-361F	45	60	10.4	25.4	7.06	8.0	6	3.8	0.5	6.5	3.25				
MYL34S-391F	37	56	10.8	25.4	7.06	12.0	6	3.8	0.5	6.9	3.45				
MYL40-391F	45	60	10.8	25.4	7.06	8.0	6	3.8	0.5	6.9	3.45				
MYL34S-431F	37	56	11.4	25.4	7.06	12.0	6	3.8	0.5	7.3	3.65				
MYL40-431F	45	60	11.4	25.4	7.06	8.0	6	3.8	0.5	7.3	3.65				
MYL34S-471F	37	56	12.1	25.4	7.06	12.0	6	3.8	0.5	7.8	3.90				
MYL40-471F	45	60	12.1	25.4	7.06	8.0	6	3.8	0.5	7.8	3.90				
MYL34S-511F	37	56	13.0	25.4	7.06	12.0	6	3.8	0.5	8.3	4.15				
MYL40-511F	45	60	13.0	25.4	7.06	8.0	6	3.8	0.5	8.3	4.15				
MYL34S-561F	37	56	13.4	25.4	7.06	12.0	6	3.8	0.5	8.8	4.40				
MYL40-561F	45	60	13.4	25.4	7.06	8.0	6	3.8	0.5	8.8	4.40				
MYL34S-621F	37	56	14.4	25.4	7.06	12.0	6	3.8	0.5	9.5	4.75				
MYL40-621F	45	60	14.4	25.4	7.06	8.0	6	3.8	0.5	9.5	4.75				
MYL34S-681F	37	56	15.3	25.4	7.06	12.0	6	3.8	0.5	10.2	5.10				
MYL40-681F	45	60	15.3	25.4	7.06	8.0	6	3.8	0.5	10.2	5.10				
MYL34S-751F	37	56	16.3	25.4	7.06	12.0	6	3.8	0.5	11.0	5.50				
MYL40-751F	45	60	16.3	25.4	7.06	8.0	6	3.8	0.5	11.0	5.50				
MYL34S-781F	37	56	16.7	25.4	7.06	12.0	6	3.8	0.5	11.3	5.65				
MYL40-781F	45	60	16.7	25.4	7.06	8.0	6	3.8	0.5	11.3	5.65				
MYL34S-821F	37	56	17.3	25.4	7.06	12.0	6	3.8	0.5	11.8	5.90				
MYL40-821F	45	60	17.3	25.4	7.06	8.0	6	3.8	0.5	11.8	5.90				
MYL34S-911F	37	56	18.6	25.4	7.06	12.0	6	3.8	0.5	12.8	6.40				
MYL40-911F	45	60	18.6	25.4	7.06	8.0	6	3.8	0.5	12.8	6.40				
MYL34S-951F	37	56	19.2	25.4	7.06	12.0	6	3.8	0.5	13.3	6.65				
MYL40-951F	45	60	19.2	25.4	7.06	8.0	6	3.8	0.5	13.3	6.65				
MYL34S-102F	37	56	19.9	25.4	7.06	12.0	6	3.8	0.5	13.9	6.95				
MYL40-102F	45	60	19.9	25.4	7.06	8.0	6	3.8	0.5	13.9	6.95				
MYL34S-112F	37	56	21.3	25.4	7.06	12.0	6	3.8	0.5	15.0	7.50				
MYL40-112F	45	60	21.3	25.4	7.06	8.0	6	3.8	0.5	15.0	7.50				
MYL34S-122F	37	56	22.5	25.4	7.06	12.0	6	3.8	0.5	16.1	8.05				
MYL40-122F	45	60	22.5	25.4	7.06	8.0	6	3.8	0.5	16.1	8.05				
MYL34S-142F	37	56	25.5	25.4	7.06	12.0	6	3.8	0.5	18.4	9.20				
MYL40-142F	45	60	25.5	25.4	7.06	8.0	6	3.8	0.5	18.4	9.20				
MYL34S-162F	37	56	28.1	25.4	7.06	12.0	6	3.8	0.5	20.7	10.35				
MYL40-162F	45	60	28.1	25.4	7.06	8.0	6	3.8	0.5	20.7	10.35				

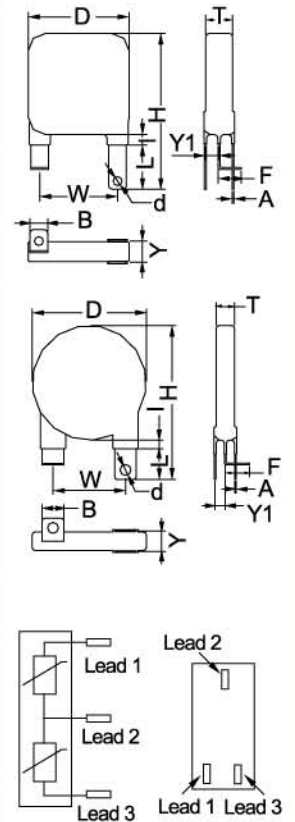

Type	Dimensions (G type lead)												Certification				
	D <sub>max</sub> (mm)	H <sub>max</sub> (mm)	T <sub>max</sub> (mm)	W±1.0 (mm)	B±0.1 (mm)	L <sub>min</sub> (mm)	l <sub>max</sub> (mm)	d±0.1 (mm)	A±0.1 (mm)	Y±1.0 (mm)	Y1±1.0 (mm)	F±1.0 (mm)	CE	UL	VDE	CCC	
MYL34S-201G	37	56	8.3	25.4	7.06	12.0	6	3.8	0.5	4.7	2.35	8.5					
MYL40-201G	45	60	8.3	25.4	7.06	8.0	6	3.8	0.5	4.7	2.35	8.5					
MYL34S-221G	37	56	8.4	25.4	7.06	12.0	6	3.8	0.5	4.9	2.45	8.5					
MYL40-221G	45	60	8.4	25.4	7.06	8.0	6	3.8	0.5	4.9	2.45	8.5					
MYL34S-241G	37	56	8.7	25.4	7.06	12.0	6	3.8	0.5	5.1	2.55	8.5					
MYL40-241G	45	60	8.7	25.4	7.06	8.0	6	3.8	0.5	5.1	2.55	8.5					
MYL34S-271G	37	56	9.1	25.4	7.06	12.0	6	3.8	0.5	5.5	2.75	8.5					
MYL40-271G	45	60	9.1	25.4	7.06	8.0	6	3.8	0.5	5.5	2.75	8.5					
MYL34S-331G	37	56	10.0	25.4	7.06	12.0	6	3.8	0.5	6.2	3.10	8.5					
MYL40-331G	45	60	10.0	25.4	7.06	8.0	6	3.8	0.5	6.2	3.10	8.5					
MYL34S-361G	37	56	10.4	25.4	7.06	12.0	6	3.8	0.5	6.5	3.25	8.5					
MYL40-361G	45	60	10.4	25.4	7.06	8.0	6	3.8	0.5	6.5	3.25	8.5					
MYL34S-391G	37	56	10.8	25.4	7.06	12.0	6	3.8	0.5	6.9	3.45	8.5					
MYL40-391G	45	60	10.8	25.4	7.06	8.0	6	3.8	0.5	6.9	3.45	8.5					
MYL34S-431G	37	56	11.4	25.4	7.06	12.0	6	3.8	0.5	7.3	3.65	8.5					
MYL40-431G	45	60	11.4	25.4	7.06	8.0	6	3.8	0.5	7.3	3.65	8.5					
MYL34S-471G	37	56	12.1	25.4	7.06	12.0	6	3.8	0.5	7.8	3.90	8.5					
MYL40-471G	45	60	12.1	25.4	7.06	8.0	6	3.8	0.5	7.8	3.90	8.5					
MYL34S-511G	37	56	13.0	25.4	7.06	12.0	6	3.8	0.5	8.3	4.15	8.5					
MYL40-511G	45	60	13.0	25.4	7.06	8.0	6	3.8	0.5	8.3	4.15	8.5					
MYL34S-561G	37	56	13.4	25.4	7.06	12.0	6	3.8	0.5	8.8	4.40	8.5					
MYL40-561G	45	60	13.4	25.4	7.06	8.0	6	3.8	0.5	8.8	4.40	8.5					
MYL34S-621G	37	56	14.4	25.4	7.06	12.0	6	3.8	0.5	9.5	4.75	8.5					
MYL40-621G	45	60	14.4	25.4	7.06	8.0	6	3.8	0.5	9.5	4.75	8.5					
MYL34S-681G	37	56	15.3	25.4	7.06	12.0	6	3.8	0.5	10.2	5.10	8.5					
MYL40-681G	45	60	15.3	25.4	7.06	8.0	6	3.8	0.5	10.2	5.10	8.5					
MYL34S-751G	37	56	16.3	25.4	7.06	12.0	6	3.8	0.5	11.0	5.50	8.5					
MYL40-751G	45	60	16.3	25.4	7.06	8.0	6	3.8	0.5	11.0	5.50	8.5					
MYL34S-781G	37	56	16.7	25.4	7.06	12.0	6	3.8	0.5	11.3	5.65	8.5					
MYL40-781G	45	60	16.7	25.4	7.06	8.0	6	3.8	0.5	11.3	5.65	8.5					
MYL34S-821G	37	56	17.3	25.4	7.06	12.0	6	3.8	0.5	11.8	5.90	8.5					
MYL40-821G	45	60	17.3	25.4	7.06	8.0	6	3.8	0.5	11.8	5.90	8.5					
MYL34S-911G	37	56	18.6	25.4	7.06	12.0	6	3.8	0.5	12.8	6.40	8.5					
MYL40-911G	45	60	18.6	25.4	7.06	8.0	6	3.8	0.5	12.8	6.40	8.5					
MYL34S-951G	37	56	19.2	25.4	7.06	12.0	6	3.8	0.5	13.3	6.65	8.5					
MYL40-951G	45	60	19.2	25.4	7.06	8.0	6	3.8	0.5	13.3	6.65	8.5					
MYL34S-102G	37	56	19.9	25.4	7.06	12.0	6	3.8	0.5	13.9	6.95	8.5					
MYL40-102G	45	60	19.9	25.4	7.06	8.0	6	3.8	0.5	13.9	6.95	8.5					
MYL34S-112G	37	56	21.3	25.4	7.06	12.0	6	3.8	0.5	15.0	7.50	8.5					
MYL40-112G	45	60	21.3	25.4	7.06	8.0	6	3.8	0.5	15.0	7.50	8.5					
MYL34S-122G	37	56	22.5	25.4	7.06	12.0	6	3.8	0.5	16.1	8.05	8.5					
MYL40-122G	45	60	22.5	25.4	7.06	8.0	6	3.8	0.5	16.1	8.05	8.5					
MYL34S-142G	37	56	25.5	25.4	7.06	12.0	6	3.8	0.5	18.4	9.20	8.5					
MYL40-142G	45	60	25.5	25.4	7.06	8.0	6	3.8	0.5	18.4	9.20	8.5					
MYL34S-162G	37	56	28.1	25.4	7.06	12.0	6	3.8	0.5	20.7	10.35	8.5					
MYL40-162G	45	60	28.1	25.4	7.06	8.0	6	3.8	0.5	20.7	10.35	8.5					



Type	Dimensions (H type lead)											Certification			
	D1±0.8 (mm)	D2±0.8 (mm)	H1±0.8 (mm)	H2±0.8 (mm)	H±0.5 (mm)	T <sub>max</sub> (mm)	Y±0.5 (mm)	W±0.5 (mm)	B±0.1 (mm)	L±0.5 (mm)	A±0.1 (mm)	CE	FU	VDE	SB
MYL34S-201H	5.2	14.4	29.8	21	3.8	5.8	32.0	18.55	5	5.3	0.5	★	★		
MYL34S-221H	5.2	14.4	29.8	21	4.0	5.8	32.0	18.55	5	5.3	0.5	★	★		
MYL34S-241H	5.2	14.4	29.8	21	4.0	5.9	32.0	18.55	5	5.3	0.5	★	★		
MYL34S-271H	5.2	14.4	29.8	21	4.5	6.3	32.0	18.55	5	5.3	0.5	★	★		
MYL34S-331H	5.2	14.4	29.8	21	4.9	6.5	32.0	18.55	5	5.3	0.5	★	★		
MYL34S-361H	5.2	14.4	29.8	21	5.1	6.7	32.0	18.55	5	5.3	0.5	★	★		
MYL34S-391H	5.2	14.4	29.8	21	5.2	6.9	32.0	18.55	5	5.3	0.5	★	★		
MYL34S-431H	5.2	14.4	29.8	21	5.2	7.1	33.2	18.55	5	5.3	0.5	★	★		
MYL34S-471H	5.2	14.4	29.8	21	5.7	7.4	33.2	18.55	5	5.3	0.5	★	★		
MYL34S-511H	5.2	14.4	29.8	21	5.7	7.6	33.2	18.55	5	5.3	0.5	★	★		
MYL34S-561H	5.2	14.4	29.8	21	6.3	8.0	33.2	18.55	5	5.3	0.5	★	★		
MYL34S-621H	5.2	14.4	29.8	21	6.3	8.2	35.0	18.55	5	5.3	0.5	★	★		
MYL34S-681H	5.2	14.4	29.8	21	7.0	8.9	35.0	18.55	5	5.3	0.5	★	★		
MYL34S-751H	5.2	14.4	29.8	21	7.5	8.9	35.0	18.55	5	5.3	0.5	★	★		
MYL34S-781H	5.2	14.4	29.8	21	7.5	9.0	35.0	18.55	5	5.3	0.5	★	★		
MYL34S-821H	5.2	14.4	29.8	21	7.6	9.0	35.0	18.55	5	5.3	0.5	★	★		
MYL34S-911H	5.2	14.4	29.8	21	7.7	9.7	35.0	18.55	5	5.3	0.5	★	★		
MYL34S-951H	5.2	14.4	29.8	21	7.8	9.7	35.0	18.55	5	5.3	0.5	★	★		
MYL34S-102H	5.2	14.4	29.8	21	8.0	10.0	35.0	18.55	5	5.3	0.5	★	★		
MYL34S-112H	5.2	14.4	29.8	21	8.0	10.5	35.0	18.55	5	5.3	0.5	★	★		
MYL34S-122H	5.2	14.4	29.8	21	8.6	11.6	35.0	18.55	5	5.3	0.5	★	★		
MYL34S-142H	5.2	14.4	29.8	21	9.9	12.6	35.0	18.55	5	5.3	0.5	★	★		
MYL34S-162H	5.2	14.4	29.8	21	11.0	13.7	35.0	18.55	5	5.3	0.5	★	★		

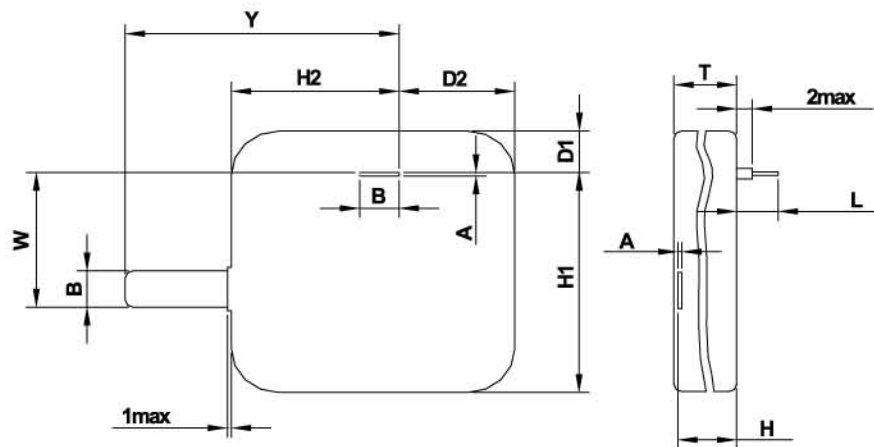

## Products Description:

MYE varistors are designed for heavy industrial electric products of extremely high demand on surge withstanding capacity, as well as poor working environments. They are made of big diameter ZnO varistor and non-flammable housing, sealing with non-flammable, insulating and explosion protection material. MYE can provide excellent surge protection capacity. With reliable terminals, it is widely used in automatic industrial equipments, power supply control, electric power transmission, communication equipments, water supply system, petrolatum equipments, mining equipments, railway signal system, etc.



## Construction and Features:

- Construction: High strength terminal MOV potted in non-flammable plastic housing;
- Potting materials: Potting with non-flammable, insulation and explosion protection potting resin-retardant to UL 94 V-0;
- Terminals: Tin-plated copper plate;
- Package: Box.

## Approvals:

With safety certifications of UL, CE, etc.

## Key Characteristic Parameters:

Max AC Operating Voltage	$V_{RMS}(V)$	130~2800
Max Energy Absorption	$W_{max}(J)$	180~10000
Peak Current (8/20 $\mu$ s)	$I_{max}(kA)$	20~70
MOV Diameter	D(mm)	25~60

## Technical Data:

Characteristics	Parameters	Standards
Climatic category	40/85/56	IEC68-2-3
LCT	-40 $^{\circ}$ C	
UCT	+85 $^{\circ}$ C	
Operating Temperature	-40 $^{\circ}$ C ~ +85 $^{\circ}$ C	CECC 42 000
Storage Temperature	-40 $^{\circ}$ C ~ +110 $^{\circ}$ C	
Electric Strength	> 2500V(AC)	CECC 42 000
Insulation Resistance	> 10M $\Omega$	CECC 42 000
Response Time	<25 ns	

## Type Designation:

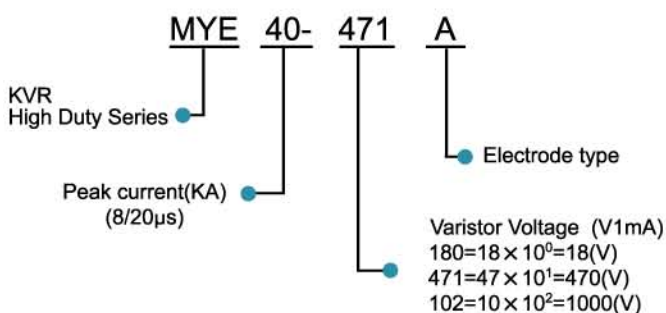

## Material Code Designation:

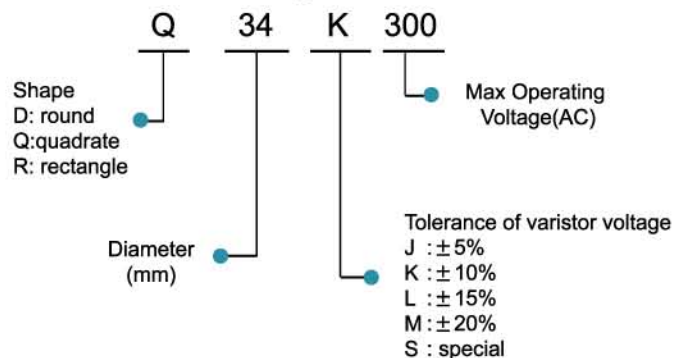



Type	Material code	Characteristics TA = +25 °C					Maximum ratings T =+85 C					V/I Characteristic curve	Derating Curve
		Varistor voltage	Tolerance	Clamping voltage at I <sub>p</sub> (8/20µs)		Capacitance (1kHz)	Max continuous operating voltage		Max energy absorption (2ms)	Peak current (8/20µs)	Max power rating		
				V <sub>N</sub> (V)	ΔV <sub>N</sub> (±%)		V <sub>P</sub> (V)	I <sub>p</sub> (A)				C (pF)	V <sub>RMS</sub> (V)
MYE20-201	D25K130	205	10	340	150	3700	130	170	150	20000	1.0	66	70
MYE30-201	D32K130	205	10	340	200	4100	130	170	210	30000	1.2	67	70
MYE40-201	Q34K130	205	10	340	300	7900	130	170	310	40000	1.4	68	71
MYE70-201	D60K130	205	10	340	500	14000	130	170	490	70000	1.6	69	71
MYE20-221	D25K140	220	10	360	150	3400	140	180	155	20000	1.0	66	70
MYE30-221	D32K140	220	10	360	200	3700	140	180	225	30000	1.2	67	70
MYE40-221	Q34K140	220	10	360	300	7200	140	180	340	40000	1.4	68	71
MYE70-221	D60K140	220	10	360	500	11000	140	180	500	70000	1.6	69	71
MYE20-241	D25K150	240	10	395	150	3100	150	200	160	20000	1.0	66	70
MYE30-241	D32K150	240	10	395	200	3400	150	200	240	30000	1.2	67	70
MYE40-241	Q34K150	240	10	395	300	6600	150	200	360	40000	1.4	68	71
MYE70-241	D60K150	240	10	395	500	10000	150	200	570	70000	1.6	69	71
MYE20-271	D25K175	270	10	455	150	2600	175	225	170	20000	1.0	66	70
MYE30-271	D32K175	270	10	455	200	2900	175	225	250	30000	1.2	67	70
MYE40-271	Q34K175	270	10	455	300	5600	175	225	390	40000	1.4	68	71
MYE70-271	D60K175	270	10	455	500	10000	175	225	630	70000	1.6	69	71
MYE20-331	D25K210	330	10	550	150	2200	210	275	180	20000	1.0	66	70
MYE30-331	D32K210	330	10	550	200	2600	210	275	270	30000	1.2	67	70
MYE40-331	Q34K210	330	10	550	300	5000	210	275	430	40000	1.4	68	71
MYE70-331	D60K210	330	10	550	500	8500	210	275	670	70000	1.6	69	71
MYE20-361	D25K230	360	10	595	150	2100	230	300	190	20000	1.0	66	70
MYE30-361	D32K230	360	10	595	200	2300	230	300	300	30000	1.2	67	70
MYE40-361	Q34K230	360	10	595	300	4400	230	300	460	40000	1.4	68	71
MYE70-361	D60K230	360	10	595	500	7700	230	300	730	70000	1.6	69	71
MYE20-391	D25K250	390	10	650	150	1900	250	320	210	20000	1.0	66	70
MYE30-391	D32K250	390	10	650	200	2100	250	320	330	30000	1.2	67	70
MYE40-391	Q34K250	390	10	650	300	4100	250	320	490	40000	1.4	68	71
MYE70-391	D60K250	390	10	650	500	7100	250	320	800	70000	1.6	69	71
MYE20-431	D25K275	430	10	710	150	1800	275	350	230	20000	1.0	66	70
MYE30-431	D32K275	430	10	710	200	2000	275	350	360	30000	1.2	67	70
MYE40-431	Q34K275	430	10	710	300	3800	275	350	550	40000	1.4	68	71
MYE70-431	D60K275	430	10	710	500	6600	275	350	860	70000	1.6	69	71
MYE20-471	D25K300	470	10	775	150	1600	300	385	240	20000	1.0	66	70
MYE30-471	D32K300	470	10	775	200	1700	300	385	380	30000	1.2	67	70
MYE40-471	Q34K300	470	10	775	300	3400	300	385	600	40000	1.4	68	71
MYE70-471	D60K300	470	10	775	500	5900	300	385	910	70000	1.6	69	71
MYE20-511	D25K320	510	10	840	150	1500	320	410	275	20000	1.0	66	70
MYE30-511	D32K320	510	10	840	200	1600	320	410	430	30000	1.2	67	70
MYE40-511	Q34K320	510	10	840	300	3200	320	410	640	40000	1.4	68	71
MYE70-511	D60K320	510	10	840	500	5700	320	410	1000	70000	1.6	69	71
MYE20-561	D25K350	560	10	915	150	1300	350	460	300	20000	1.0	66	70
MYE30-561	D32K350	560	10	915	200	1400	350	460	490	30000	1.2	67	70
MYE40-561	Q34K350	560	10	915	300	2900	350	460	710	40000	1.4	68	71
MYE70-561	D60K350	560	10	915	500	5000	350	460	1045	70000	1.6	69	71
MYE20-621	D25K385	620	10	1025	150	1200	385	505	320	20000	1.0	66	70
MYE30-621	D32K385	620	10	1025	200	1300	385	505	550	30000	1.2	67	70
MYE40-621	Q34K385	620	10	1025	300	2600	385	505	800	40000	1.4	68	71

Type	Material code	Characteristics TA = +25 °C					Maximum ratings T =+85 C					V/I Characteristic curve	Derating Curve
		Varistor voltage	Tolerance	Clamping voltage at Ip (8/20µs)		Capacitance (1kHz)	Max continuous operating voltage		Max energy absorption (2ms)	Peak current (8/20µs)	Max power rating		
				VN (V)	ΔVN (±%)		Vp (V)	Ip (A)				C (pF)	VRMS (V)
MYE70-621	D60K385	620	10	1025	500	4600	385	505	1200	70000	1.6	69	71
MYE20-681	D25K420	680	10	1120	150	1100	420	560	360	20000	1.0	66	70
MYE30-681	D32K420	680	10	1120	200	1300	420	560	600	30000	1.2	67	70
MYE40-681	Q34K420	680	10	1120	300	2400	420	560	910	40000	1.4	68	71
MYE70-681	D60K420	680	10	1120	500	4400	420	560	1500	70000	1.6	69	71
MYE20-751	D25K460	750	10	1240	150	1000	460	615	390	20000	1.0	66	70
MYE30-751	D32K460	750	10	1240	200	1100	460	615	520	30000	1.2	67	70
MYE40-751	Q34K460	750	10	1240	300	2200	460	615	960	40000	1.4	68	71
MYE70-751	D60K460	750	10	1240	500	3900	460	615	1650	70000	1.6	69	71
MYE20-781	D25K485	780	10	1290	150	990	485	640	397	20000	1.0	66	70
MYE30-781	D32K485	780	10	1290	200	1100	485	640	550	30000	1.2	67	70
MYE40-781	Q34K485	780	10	1290	300	2100	485	640	930	40000	1.4	68	71
MYE70-781	D60K485	780	10	1290	500	3800	485	640	1248	70000	1.6	69	71
MYE20-821	D25K510	820	10	1355	150	930	510	670	410	20000	1.0	66	70
MYE30-821	D32K510	820	10	1355	200	1000	510	670	580	30000	1.2	67	70
MYE40-821	Q34K510	820	10	1355	300	2000	510	670	940	40000	1.4	68	71
MYE70-821	D60K510	820	10	1355	500	3500	510	670	1312	70000	1.6	69	71
MYE20-911	D25K550	910	10	1500	150	860	550	745	425	20000	1.0	66	70
MYE30-911	D32K550	910	10	1500	200	950	550	745	620	30000	1.2	67	70
MYE40-911	Q34K550	910	10	1500	300	1800	550	745	960	40000	1.4	68	71
MYE70-911	D60K550	910	10	1500	500	3300	550	745	1500	70000	1.6	69	71
MYE20-951	D25K580	950	10	1500	150	820	580	760	450	20000	1.0	66	70
MYE30-951	D32K580	950	10	1500	200	900	580	760	650	30000	1.2	67	70
MYE40-951	Q34K580	950	10	1500	300	1700	580	760	1000	40000	1.4	68	71
MYE70-951	D60K580	950	10	1500	500	3100	580	760	1548	70000	1.6	69	71
MYE20-102	D25K625	1000	10	1650	150	760	625	825	480	20000	1.0	66	70
MYE30-102	D32K625	1000	10	1650	200	840	625	825	680	30000	1.2	67	70
MYE40-102	Q34K625	1000	10	1650	300	1600	625	825	1040	40000	1.4	68	71
MYE70-102	D60K625	1000	10	1650	500	2900	625	825	1630	70000	1.6	69	71
MYE20-112	D25K680	1100	10	1815	150	690	680	895	525	20000	1.0	66	70
MYE30-112	D32K680	1100	10	1815	200	770	680	895	760	30000	1.2	67	70
MYE40-112	Q34K680	1100	10	1815	300	1500	680	895	1100	40000	1.4	68	71
MYE70-112	D60K680	1100	10	1815	500	2700	680	895	1800	70000	1.6	69	71
MYE70-122	D60K750	1200	10	2000	500	2400	750	970	2600	70000	1.6	69	71
MYE70-142	D60K880	1400	10	2290	500	2100	880	1150	3200	70000	1.6	69	71
MYE70-162	D60K900	1600	10	2700	500	1800	900	1200	3200	70000	1.6	69	71
MYE70-182	D60K1000	1800	10	2940	500	2200	1000	1400	3800	70000	1.6	69	71
MYE70-222	D60K1400	2200	10	3600	500	1800	1400	1750	5000	70000	1.6	69	71
MYE70-272	D60K1700	2700	10	4300	500	1500	1700	2150	6000	70000	1.6	69	71
MYE70-332	D60K2000	3300	10	5200	500	1200	2000	2500	7500	70000	1.6	69	71
MYE70-392	D60K2400	3900	10	6200	500	1000	2400	3000	8600	70000	1.6	69	71
MYE70-472	D60K2800	4700	10	7400	500	800	2800	3500	10000	70000	1.6	69	71



Type	Dimensions (A type module)								Certification			
	A±1.0 (mm)	E±1.0 (mm)	T±1.0 (mm)	C±1.0 (mm)	W±1.0 (mm)	G±1.0 (mm)	H±1.0 (mm)	F±1.0 (mm)	CE	RoHS	VDE	SP
MYE20-201A	48.0	36.0	14.0	4.0	22.5	29.0	39.5	3.5				
MYE30-201A	61.5	52.2	14.0	4.2	25.0	41.5	52.2	3.0	★	★		
MYE40-201A	61.5	52.2	14.0	4.2	25.0	41.5	52.2	3.0	★	★		
MYE20-221A	48.0	36.0	14.0	4.0	22.5	29.0	39.5	3.5				
MYE30-221A	61.5	52.2	14.0	4.2	25.0	41.5	52.2	3.0	★			
MYE40-221A	61.5	52.2	14.0	4.2	25.0	41.5	52.2	3.0	★	★		
MYE20-241A	48.0	36.0	14.0	4.0	22.5	29.0	39.5	3.5				
MYE30-241A	61.5	52.2	14.0	4.2	25.0	41.5	52.2	3.0	★	★		
MYE40-241A	61.5	52.2	14.0	4.2	25.0	41.5	52.2	3.0	★	★		
MYE20-271A	48.0	36.0	14.0	4.0	22.5	29.0	39.5	3.5				
MYE30-271A	61.5	52.2	14.0	4.2	25.0	41.5	52.2	3.0	★	★		
MYE40-271A	61.5	52.2	14.0	4.2	25.0	41.5	52.2	3.0	★	★		
MYE20-331A	48.0	36.0	14.0	4.0	22.5	29.0	39.5	3.5				
MYE30-331A	61.5	52.2	14.0	4.2	25.0	41.5	52.2	3.0	★	★		
MYE40-331A	61.5	52.2	14.0	4.2	25.0	41.5	52.2	3.0	★	★		
MYE20-361A	48.0	36.0	14.0	4.0	22.5	29.0	39.5	3.5				
MYE30-361A	61.5	52.2	14.0	4.2	25.0	41.5	52.2	3.0	★	★		
MYE40-361A	61.5	52.2	14.0	4.2	25.0	41.5	52.2	3.0	★	★		
MYE20-391A	48.0	36.0	14.0	4.0	22.5	29.0	39.5	3.5				
MYE30-391A	61.5	52.2	14.0	4.2	25.0	41.5	52.2	3.0	★	★		
MYE40-391A	61.5	52.2	14.0	4.2	25.0	41.5	52.2	3.0	★	★		
MYE20-431A	48.0	36.0	14.0	4.0	22.5	29.0	39.5	3.5				
MYE30-431A	61.5	52.2	14.0	4.2	25.0	41.5	52.2	3.0	★	★		
MYE40-431A	61.5	52.2	14.0	4.2	25.0	41.5	52.2	3.0	★	★		
MYE20-471A	48.0	36.0	14.0	4.0	22.5	29.0	39.5	3.5				
MYE30-471A	61.5	52.2	14.0	4.2	25.0	41.5	52.2	3.0	★	★		
MYE40-471A	61.5	52.2	14.0	4.2	25.0	41.5	52.2	3.0	★	★		
MYE20-511A	48.0	36.0	14.0	4.0	22.5	29.0	39.5	3.5				
MYE30-511A	61.5	52.2	14.0	4.2	25.0	41.5	52.2	3.0	★	★		
MYE40-511A	61.5	52.2	14.0	4.2	25.0	41.5	52.2	3.0	★	★		
MYE20-561A	48.0	36.0	14.0	4.0	22.5	29.0	39.5	3.5				
MYE30-561A	61.5	52.2	14.0	4.2	25.0	41.5	52.2	3.0	★			
MYE40-561A	61.5	52.2	14.0	4.2	25.0	41.5	52.2	3.0	★	★		
MYE20-621A	48.0	36.0	14.0	4.0	22.5	29.0	39.5	3.5				
MYE30-621A	61.5	52.2	14.0	4.2	25.0	41.5	52.2	3.0	★	★		
MYE40-621A	61.5	52.2	14.0	4.2	25.0	41.5	52.2	3.0	★	★		
MYE20-681A	48.0	36.0	14.0	4.0	22.5	29.0	39.5	3.5				
MYE30-681A	61.5	52.2	14.0	4.2	25.0	41.5	52.2	3.0	★	★		
MYE40-681A	61.5	52.2	14.0	4.2	25.0	41.5	52.2	3.0	★	★		
MYE20-751A	48.0	36.0	14.0	4.0	22.5	29.0	39.5	3.5				
MYE30-751A	61.5	52.2	14.0	4.2	25.0	41.5	52.2	3.0	★	★		
MYE40-751A	61.5	52.2	14.0	4.2	25.0	41.5	52.2	3.0	★	★		
MYE20-781A	48.0	36.0	14.0	4.0	22.5	29.0	39.5	3.5				
MYE30-781A	61.5	52.2	14.0	4.2	25.0	41.5	52.2	3.0	★	★		
MYE40-781A	61.5	52.2	14.0	4.2	25.0	41.5	52.2	3.0	★	★		
MYE20-821A	48.0	36.0	14.0	4.0	22.5	29.0	39.5	3.5				
MYE30-821A	61.5	52.2	14.0	4.2	25.0	41.5	52.2	3.0	★	★		

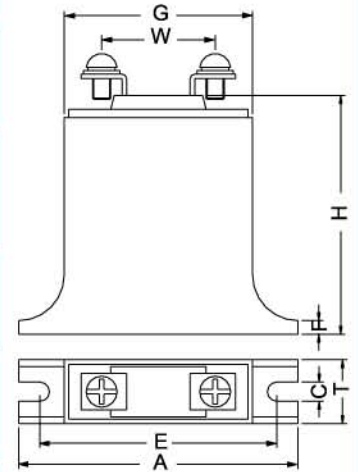

Type	Dimensions (A type module)								Certification			
	A±1.0 (mm)	E±1.0 (mm)	T±1.0 (mm)	C±1.0 (mm)	W±1.0 (mm)	G±1.0 (mm)	H±1.0 (mm)	F±1.0 (mm)	CE	RoHS	VDE	SP
MYE40-821A	61.5	52.2	14.0	4.2	25.0	41.5	52.2	3.0	★	★		
MYE20-911A	48.0	36.0	14.0	4.0	22.5	29.0	39.5	3.5				
MYE30-911A	61.5	52.2	14.0	4.2	25.0	41.5	52.2	3.0	★	★		
MYE40-911A	61.5	52.2	14.0	4.2	25.0	41.5	52.2	3.0	★	★		
MYE20-951A	48.0	36.0	14.0	4.0	22.5	29.0	39.5	3.5				
MYE30-951A	61.5	52.2	14.0	4.2	25.0	41.5	52.2	3.0	★	★		
MYE40-951A	61.5	52.2	14.0	4.2	25.0	41.5	52.2	3.0	★	★		
MYE20-102A	48.0	36.0	14.0	4.0	22.5	29.0	39.5	3.5				
MYE30-102A	61.5	52.2	14.0	4.2	25.0	41.5	52.2	3.0	★	★		
MYE40-102A	61.5	52.2	14.0	4.2	25.0	41.5	52.2	3.0	★	★		
MYE20-112A	48.0	36.0	14.0	4.0	22.5	29.0	39.5	3.5				
MYE30-112A	61.5	52.2	14.0	4.2	25.0	41.5	52.2	3.0	★	★		
MYE40-112A	61.5	52.2	14.0	4.2	25.0	41.5	52.2	3.0	★	★		

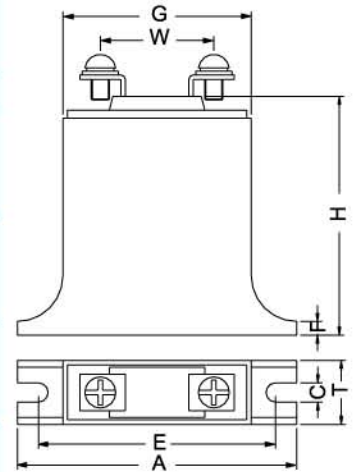



Type	Dimensions (B type moduel)								Certification			
	A±1.0 (mm)	E±1.0 (mm)	T±1.0 (mm)	C±1.0 (mm)	W±1.0 (mm)	G±1.0 (mm)	H±1.0 (mm)	F±1.0 (mm)	CE	UL	VDE	CB
MYE30-201B	61.5	52.2	14.0	4.0	25.0	41.5	52.2	3.0	★	★		
MYE40-201B	61.5	52.2	14.0	4.0	25.0	41.5	52.2	3.0	★	★		
MYE30-221B	61.5	52.2	14.0	4.0	25.0	41.5	52.2	3.0	★			
MYE40-221B	61.5	52.2	14.0	4.0	25.0	41.5	52.2	3.0	★	★		
MYE30-241B	61.5	52.2	14.0	4.0	25.0	41.5	52.2	3.0	★	★		
MYE40-241B	61.5	52.2	14.0	4.0	25.0	41.5	52.2	3.0	★	★		
MYE30-271B	61.5	52.2	14.0	4.0	25.0	41.5	52.2	3.0	★	★		
MYE40-271B	61.5	52.2	14.0	4.0	25.0	41.5	52.2	3.0	★	★		
MYE30-331B	61.5	52.2	14.0	4.0	25.0	41.5	52.2	3.0	★	★		
MYE40-331B	61.5	52.2	14.0	4.0	25.0	41.5	52.2	3.0	★	★		
MYE30-361B	61.5	52.2	14.0	4.0	25.0	41.5	52.2	3.0	★	★		
MYE40-361B	61.5	52.2	14.0	4.0	25.0	41.5	52.2	3.0	★	★		
MYE30-391B	61.5	52.2	14.0	4.0	25.0	41.5	52.2	3.0	★	★		
MYE40-391B	61.5	52.2	14.0	4.0	25.0	41.5	52.2	3.0	★	★		
MYE30-431B	61.5	52.2	14.0	4.0	25.0	41.5	52.2	3.0	★	★		
MYE40-431B	61.5	52.2	14.0	4.0	25.0	41.5	52.2	3.0	★	★		
MYE30-471B	61.5	52.2	14.0	4.0	25.0	41.5	52.2	3.0	★	★		
MYE40-471B	61.5	52.2	14.0	4.0	25.0	41.5	52.2	3.0	★	★		
MYE30-511B	61.5	52.2	14.0	4.0	25.0	41.5	52.2	3.0	★	★		
MYE40-511B	61.5	52.2	14.0	4.0	25.0	41.5	52.2	3.0	★	★		
MYE30-561B	61.5	52.2	14.0	4.0	25.0	41.5	52.2	3.0	★			
MYE40-561B	61.5	52.2	14.0	4.0	25.0	41.5	52.2	3.0	★	★		
MYE30-621B	61.5	52.2	14.0	4.0	25.0	41.5	52.2	3.0	★	★		
MYE40-621B	61.5	52.2	14.0	4.0	25.0	41.5	52.2	3.0	★	★		
MYE30-681B	61.5	52.2	14.0	4.0	25.0	41.5	52.2	3.0	★	★		
MYE40-681B	61.5	52.2	14.0	4.0	25.0	41.5	52.2	3.0	★	★		
MYE30-751B	61.5	52.2	14.0	4.0	25.0	41.5	52.2	3.0	★	★		
MYE40-751B	61.5	52.2	14.0	4.0	25.0	41.5	52.2	3.0	★	★		
MYE30-781B	61.5	52.2	14.0	4.0	25.0	41.5	52.2	3.0	★	★		
MYE40-781B	61.5	52.2	14.0	4.0	25.0	41.5	52.2	3.0	★	★		
MYE30-821B	61.5	52.2	14.0	4.0	25.0	41.5	52.2	3.0	★	★		
MYE40-821B	61.5	52.2	14.0	4.0	25.0	41.5	52.2	3.0	★	★		
MYE30-911B	61.5	52.2	14.0	4.0	25.0	41.5	52.2	3.0	★	★		
MYE40-911B	61.5	52.2	14.0	4.0	25.0	41.5	52.2	3.0	★	★		
MYE30-951B	61.5	52.2	14.0	4.0	25.0	41.5	52.2	3.0	★	★		
MYE40-951B	61.5	52.2	14.0	4.0	25.0	41.5	52.2	3.0	★	★		
MYE30-102B	61.5	52.2	14.0	4.0	25.0	41.5	52.2	3.0	★	★		
MYE40-102B	61.5	52.2	14.0	4.0	25.0	41.5	52.2	3.0	★	★		
MYE30-112B	61.5	52.2	14.0	4.0	25.0	41.5	52.2	3.0	★	★		
MYE40-112B	61.5	52.2	14.0	4.0	25.0	41.5	52.2	3.0	★	★		

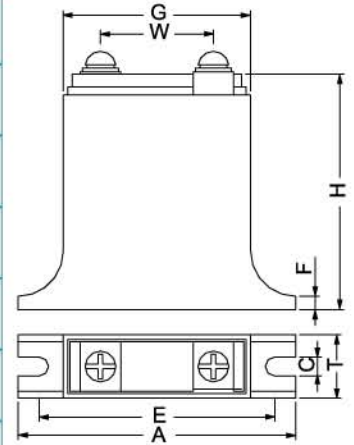

Type	Dimensions (C type module)								Certification			
	A±1.0 (mm)	E±1.0 (mm)	T±1.0 (mm)	C±1.0 (mm)	B±1.0 (mm)	G±1.0 (mm)	H±1.0 (mm)	F±1.0 (mm)	CE	UL	VDE	CCC
MYE30-201C	61.5	52.2	14.0	4.2	1.0	41.5	49.0	4.0	★	★		
MYE40-201C	61.5	52.2	14.0	4.2	1.0	41.5	49.0	4.0	★	★		
MYE30-221C	61.5	52.2	14.0	4.2	1.0	41.5	49.0	4.0	★			
MYE40-221C	61.5	52.2	14.0	4.2	1.0	41.5	49.0	4.0	★	★		
MYE30-241C	61.5	52.2	14.0	4.2	1.0	41.5	49.0	4.0	★	★		
MYE40-241C	61.5	52.2	14.0	4.2	1.0	41.5	49.0	4.0	★	★		
MYE30-271C	61.5	52.2	14.0	4.2	1.0	41.5	49.0	4.0	★	★		
MYE40-271C	61.5	52.2	14.0	4.2	1.0	41.5	49.0	4.0	★	★		
MYE30-331C	61.5	52.2	14.0	4.2	1.0	41.5	49.0	4.0	★	★		
MYE40-331C	61.5	52.2	14.0	4.2	1.0	41.5	49.0	4.0	★	★		
MYE30-361C	61.5	52.2	14.0	4.2	1.0	41.5	49.0	4.0	★	★		
MYE40-361C	61.5	52.2	14.0	4.2	1.0	41.5	49.0	4.0	★	★		
MYE30-391C	61.5	52.2	14.0	4.2	1.0	41.5	49.0	4.0	★	★		
MYE40-391C	61.5	52.2	14.0	4.2	1.0	41.5	49.0	4.0	★	★		
MYE30-431C	61.5	52.2	14.0	4.2	1.0	41.5	49.0	4.0	★	★		
MYE40-431C	61.5	52.2	14.0	4.2	1.0	41.5	49.0	4.0	★	★		
MYE30-471C	61.5	52.2	14.0	4.2	1.0	41.5	49.0	4.0	★	★		
MYE40-471C	61.5	52.2	14.0	4.2	1.0	41.5	49.0	4.0	★	★		
MYE30-511C	61.5	52.2	14.0	4.2	1.0	41.5	49.0	4.0	★	★		
MYE40-511C	61.5	52.2	14.0	4.2	1.0	41.5	49.0	4.0	★	★		
MYE30-561C	61.5	52.2	14.0	4.2	1.0	41.5	49.0	4.0	★			
MYE40-561C	61.5	52.2	14.0	4.2	1.0	41.5	49.0	4.0	★	★		
MYE30-621C	61.5	52.2	14.0	4.2	1.0	41.5	49.0	4.0	★	★		
MYE40-621C	61.5	52.2	14.0	4.2	1.0	41.5	49.0	4.0	★	★		
MYE30-681C	61.5	52.2	14.0	4.2	1.0	41.5	49.0	4.0	★	★		
MYE40-681C	61.5	52.2	14.0	4.2	1.0	41.5	49.0	4.0	★	★		
MYE30-751C	61.5	52.2	14.0	4.2	1.0	41.5	49.0	4.0	★	★		
MYE40-751C	61.5	52.2	14.0	4.2	1.0	41.5	49.0	4.0	★	★		
MYE30-781C	61.5	52.2	14.0	4.2	1.0	41.5	49.0	4.0	★	★		
MYE40-781C	61.5	52.2	14.0	4.2	1.0	41.5	49.0	4.0	★	★		
MYE30-821C	61.5	52.2	14.0	4.2	1.0	41.5	49.0	4.0	★	★		
MYE40-821C	61.5	52.2	14.0	4.2	1.0	41.5	49.0	4.0	★	★		
MYE30-911C	61.5	52.2	14.0	4.2	1.0	41.5	49.0	4.0	★	★		
MYE40-911C	61.5	52.2	14.0	4.2	1.0	41.5	49.0	4.0	★	★		
MYE30-951C	61.5	52.2	14.0	4.2	1.0	41.5	49.0	4.0	★	★		
MYE40-951C	61.5	52.2	14.0	4.2	1.0	41.5	49.0	4.0	★	★		
MYE30-102C	61.5	52.2	14.0	4.2	1.0	41.5	49.0	4.0	★	★		
MYE40-102C	61.5	52.2	14.0	4.2	1.0	41.5	49.0	4.0	★	★		
MYE30-112C	61.5	52.2	14.0	4.2	1.0	41.5	49.0	4.0	★	★		
MYE40-112C	61.5	52.2	14.0	4.2	1.0	41.5	49.0	4.0	★	★		

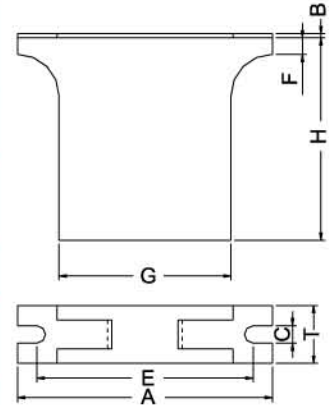



Type	Dimensions (D type module)											Certification			
	A±1.0 (mm)	E±2.0 (mm)	T±1.0 (mm)	B±1.0 (mm)	C±1.0 (mm)	W±1.0 (mm)	G±1.0 (mm)	L±1.0 (mm)	D±0.5 (mm)	H±2.0 (mm)	F±1.0 (mm)	CE	FU	VDE	SG
MYE70-201D	100.0	85.3	23.6	86.0	6.5	40.0	70.0	29.5	7.0	99.0	5.0		★		
MYE70-221D	100.0	85.3	23.6	86.0	6.5	40.0	70.0	29.5	7.0	99.0	5.0				
MYE70-241D	100.0	85.3	23.6	86.0	6.5	40.0	70.0	29.5	7.0	99.0	5.0		★		
MYE70-271D	100.0	85.3	23.6	86.0	6.5	40.0	70.0	29.5	7.0	99.0	5.0		★		
MYE70-331D	100.0	85.3	23.6	86.0	6.5	40.0	70.0	29.5	7.0	99.0	5.0		★		
MYE70-361D	100.0	85.3	23.6	86.0	6.5	40.0	70.0	29.5	7.0	99.0	5.0		★		
MYE70-391D	100.0	85.3	23.6	86.0	6.5	40.0	70.0	29.5	7.0	99.0	5.0		★		
MYE70-431D	100.0	85.3	23.6	86.0	6.5	40.0	70.0	29.5	7.0	99.0	5.0		★		
MYE70-471D	100.0	85.3	23.6	86.0	6.5	40.0	70.0	29.5	7.0	99.0	5.0		★		
MYE70-511D	100.0	85.3	23.6	86.0	6.5	40.0	70.0	29.5	7.0	99.0	5.0		★		
MYE70-561D	100.0	85.3	23.6	86.0	6.5	40.0	70.0	29.5	7.0	99.0	5.0		★		
MYE70-621D	100.0	85.3	23.6	86.0	6.5	40.0	70.0	29.5	7.0	99.0	5.0		★		
MYE70-681D	100.0	85.3	23.6	86.0	6.5	40.0	70.0	29.5	7.0	99.0	5.0		★		
MYE70-751D	100.0	85.3	23.6	86.0	6.5	40.0	70.0	29.5	7.0	99.0	5.0		★		
MYE70-781D	100.0	85.3	23.6	86.0	6.5	40.0	70.0	29.5	7.0	99.0	5.0		★		
MYE70-821D	100.0	85.3	23.6	86.0	6.5	40.0	70.0	29.5	7.0	99.0	5.0		★		
MYE70-911D	100.0	85.3	23.6	86.0	6.5	40.0	70.0	29.5	7.0	99.0	5.0		★		
MYE70-951D	100.0	85.3	23.6	86.0	6.5	40.0	70.0	29.5	7.0	99.0	5.0		★		
MYE70-102D	100.0	85.3	23.6	86.0	6.5	40.0	70.0	29.5	7.0	99.0	5.0		★		
MYE70-112D	100.0	85.3	23.6	86.0	6.5	40.0	70.0	29.5	7.0	99.0	5.0		★		
MYE70-122D	100.0	85.3	23.6	86.0	6.5	40.0	70.0	29.5	7.0	99.0	5.0		★		
MYE70-142D	100.0	85.3	23.6	86.0	6.5	40.0	70.0	29.5	7.0	99.0	5.0		★		
MYE70-162D	100.0	85.3	23.6	86.0	6.5	40.0	70.0	29.5	7.0	99.0	5.0		★		

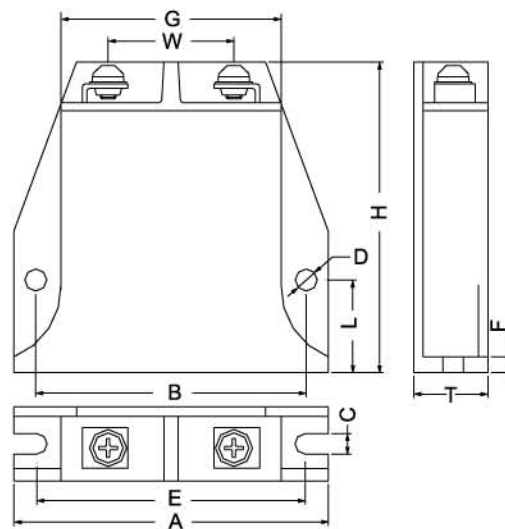

Type	Dimensions (F type module)											Certification			
	A±1.0 (mm)	E±2.0 (mm)	T±1.0 (mm)	B±1.0 (mm)	C±1.0 (mm)	W±1.0 (mm)	G±1.0 (mm)	L±1.0 (mm)	D±0.5 (mm)	H±2.0 (mm)	F±1.0 (mm)	CE	UL	VDE	CS
MYE70-122F	100.0	85.3	44.5	85.0	6.5	40.0	70.0	30.0	7.0	100.0	5.0				
MYE70-142F	100.0	85.3	44.5	85.0	6.5	40.0	70.0	30.0	7.0	100.0	5.0				
MYE70-162F	100.0	85.3	44.5	85.0	6.5	40.0	70.0	30.0	7.0	100.0	5.0				
MYE70-182F	100.0	85.3	44.5	85.0	6.5	40.0	70.0	30.0	7.0	100.0	5.0				
MYE70-222F	100.0	85.3	44.5	85.0	6.5	40.0	70.0	30.0	7.0	100.0	5.0				
MYE70-272F	100.0	85.3	44.5	85.0	6.5	40.0	70.0	30.0	7.0	100.0	5.0				
MYE70-332F	100.0	85.3	44.5	85.0	6.5	40.0	70.0	30.0	7.0	100.0	5.0				
MYE70-392F	100.0	85.3	44.5	85.0	6.5	40.0	70.0	30.0	7.0	100.0	5.0				
MYE70-472F	100.0	85.3	44.5	85.0	6.5	40.0	70.0	30.0	7.0	100.0	5.0				

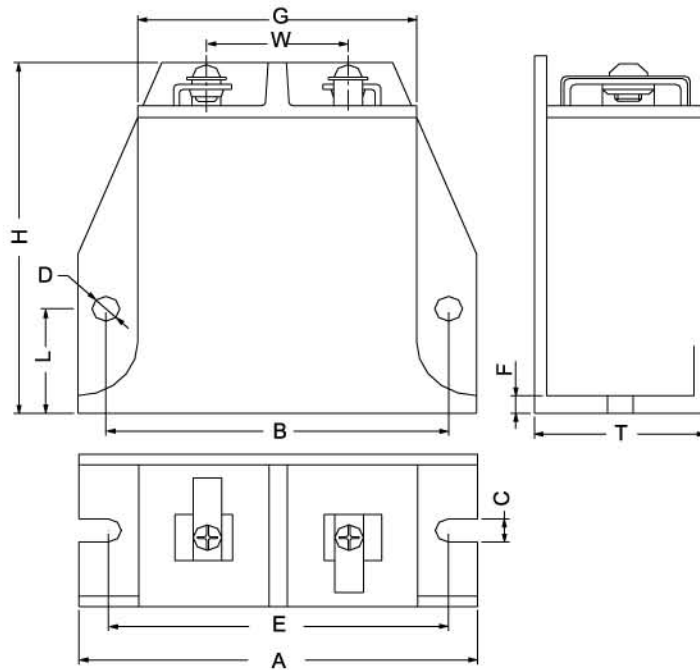



## Products Description:

MYP varistors are designed for extremely high demand on surge withstanding capacity, which would be assembled by the customer themselves. MYP varistors surfaces are screen printed with silver paste. It has good solderability after burn-in. With excellent surge protection performance, It is widely used in various fields of computer, power supply control, power transmission, communication equipments, water supply system, petrolatum equipments, mining equipments, railway signal system, etc.



## Construction and Features:

- Construction: Round or quadrate metallized varistors element;
- Terminals: Silver printed on surfaces, no terminals;
- Package: Box.

## Approvals:

With safety certifications of UL

## Key Characteristic Parameters:

Max AC Operating Voltage	$V_{RMS}(V)$	130~900
Max Energy Absorption	$W_{max}(J)$	320~2278
Peak Current (8/20 $\mu$ s)	$I_{max}(kA)$	25~70
MOV Diameter	D(mm)	32~53

## Technical Data:

Characteristics	Parameters	Standards
Climatic Category	25/85/56	IEC68-2-3
LCT	-25 $^{\circ}C$	
UCT	+85 $^{\circ}C$	
Operating Temperature	-25 $^{\circ}C$ ~+85 $^{\circ}C$	CECC 42 000
Storage Temperature	-25 $^{\circ}C$ ~+110 $^{\circ}C$	
Response Time	<25 ns	

## Type Designation:

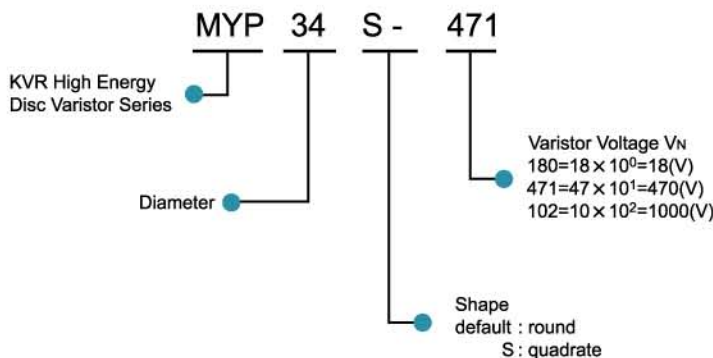

## Material Code Designation:

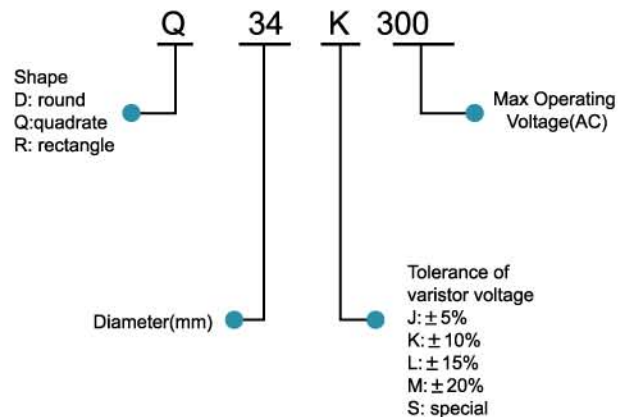

Type	Material code	Characteristics TA = +25 °C					Maximum ratings T =+85 C					V/I Characteristic curve	Derating curve
		Varistor voltage	Tolerance	Clamping voltage at I <sub>p</sub> (8/20µs)		Capacitance (1kHz)	Max continuous operating voltage		Max energy absorption (2ms)	Peak current (8/20µs)	Max power rating		
				V <sub>N</sub> (V)	ΔV <sub>N</sub> (± %)		V <sub>P</sub> (V)	I <sub>p</sub> (A)				C (pF)	V <sub>RMS</sub> (V)
MYP32-201	D32K130	205	10	340	200	4100	130	170	210	25000	1.2	78	81
MYP34S-201	Q34K130	205	10	340	300	7900	130	170	310	40000	1.4	79	81
MYP40-201	D40K130	205	10	340	300	8600	130	170	310	40000	1.4	79	81
MYP53-201	D53K130	205	10	340	500	14000	130	170	490	70000	1.5	80	82
MYP32-221	D32K140	220	10	360	200	3700	140	180	225	25000	1.2	78	81
MYP34S-221	Q34K140	220	10	360	300	7200	140	180	340	40000	1.4	79	81
MYP40-221	D40K140	220	10	360	300	7800	140	180	340	40000	1.4	79	81
MYP53-221	D53K140	220	10	360	500	12000	140	180	500	70000	1.5	80	82
MYP32-241	D32K150	240	10	395	200	3400	150	200	240	25000	1.2	78	81
MYP34S-241	Q34K150	240	10	395	300	6600	150	200	360	40000	1.4	79	81
MYP40-241	D40K150	240	10	395	300	7200	150	200	360	40000	1.4	79	81
MYP53-241	D53K150	240	10	395	500	11000	150	200	570	70000	1.5	80	82
MYP32-271	D32K175	270	10	455	200	2900	175	225	250	25000	1.2	78	81
MYP34S-271	Q34K175	270	10	455	300	5600	175	225	390	40000	1.4	79	81
MYP40-271	D40K175	270	10	455	300	6000	175	225	390	40000	1.4	79	81
MYP53-271	D53K175	270	10	455	500	10000	175	225	630	70000	1.5	80	82
MYP32-331	D32K210	330	10	550	200	2600	210	275	270	25000	1.2	78	81
MYP34S-331	Q34K210	330	10	550	300	5000	210	275	430	40000	1.4	79	81
MYP40-331	D40K210	330	10	550	300	5400	210	275	430	40000	1.4	79	81
MYP53-331	D53K210	330	10	550	500	8500	210	275	670	70000	1.5	80	82
MYP32-361	D32K230	360	10	595	200	2300	230	300	300	25000	1.2	78	81
MYP34S-361	Q34K230	360	10	595	300	4400	230	300	460	40000	1.4	79	81
MYP40-361	D40K230	360	10	595	300	4800	230	300	460	40000	1.4	79	81
MYP53-361	D53K230	360	10	595	500	7700	230	300	730	70000	1.5	80	82
MYP32-391	D32K250	390	10	650	200	2100	250	320	330	25000	1.2	78	81
MYP34S-391	Q34K250	390	10	650	300	4100	250	320	490	40000	1.4	79	81
MYP40-391	D40K250	390	10	650	300	4400	250	320	490	40000	1.4	79	81
MYP53-391	D53K250	390	10	650	500	7100	250	320	800	70000	1.5	80	82
MYP32-431	D32K275	430	10	710	200	2000	275	350	360	25000	1.2	78	81
MYP34S-431	Q34K275	430	10	710	300	3800	275	350	550	40000	1.4	79	81
MYP40-431	D40K275	430	10	710	300	4100	275	350	550	40000	1.4	79	81
MYP53-431	D53K275	430	10	710	500	6600	275	350	860	70000	1.5	80	82
MYP32-471	D32K300	470	10	775	200	1700	300	385	380	25000	1.2	78	81
MYP34S-471	Q34K300	470	10	775	300	3400	300	385	600	40000	1.4	79	81
MYP40-471	D40K300	470	10	775	300	3600	300	385	600	40000	1.4	79	81
MYP53-471	D53K300	470	10	775	500	5900	300	385	910	70000	1.5	80	82
MYP32-511	D32K320	510	10	840	200	1600	320	410	430	25000	1.2	78	81
MYP34S-511	Q34K320	510	10	840	300	3200	320	410	640	40000	1.4	79	81
MYP40-511	D40K320	510	10	840	300	3400	320	410	640	40000	1.4	79	81
MYP53-511	D53K320	510	10	840	500	5700	320	410	1000	70000	1.5	80	82
MYP32-561	D32K350	560	10	915	200	1400	350	460	490	25000	1.2	78	81
MYP34S-561	Q34K350	560	10	915	300	2900	350	460	710	40000	1.4	79	81
MYP40-561	D40K350	560	10	915	300	3100	350	460	710	40000	1.4	79	81
MYP53-561	D53K350	560	10	915	500	5000	350	460	1045	70000	1.5	80	82
MYP32-621	D32K385	620	10	1025	200	1300	385	505	550	25000	1.2	78	81
MYP34S-621	Q34K385	620	10	1025	300	2600	385	505	800	40000	1.4	79	81
MYP40-621	D40K385	620	10	1025	300	2800	385	505	800	40000	1.4	79	81



Type	Dimensions		Certification			
	D $\pm$ 1.0 (mm)	T <sub>max</sub> (mm)	CE	UL	VDE	SF
MYP32-201	32.0	1.5				
MYP34S-201	33.7	1.5				
MYP40-201	40.0	1.5	★			
MYP53-201	53.0	1.5				
MYP32-221	32.0	1.6				
MYP34S-221	33.7	1.6				
MYP40-221	40.0	1.6	★			
MYP53-221	53.0	1.6				
MYP32-241	32.0	1.8				
MYP34S-241	33.7	1.8				
MYP40-241	40.0	1.8	★			
MYP53-241	53.0	1.8				
MYP32-271	32.0	2.2				
MYP34S-271	33.7	2.2				
MYP40-271	40.0	2.2	★			
MYP53-271	53.0	2.2				
MYP32-331	32.0	2.4				
MYP34S-331	33.7	2.4				
MYP40-331	40.0	2.4	★			
MYP53-331	53.0	2.4				
MYP32-361	32.0	2.6				
MYP34S-361	33.7	2.6				
MYP40-361	40.0	2.6	★			
MYP53-361	53.0	2.6				
MYP32-391	32.0	2.9				
MYP34S-391	33.7	2.9				
MYP40-391	40.0	2.9	★			
MYP53-391	53.0	2.9				
MYP32-431	32.0	3.2				
MYP34S-431	33.7	3.2				
MYP40-431	40.0	3.2	★			
MYP53-431	53.0	3.2				
MYP32-471	32.0	3.4				
MYP34S-471	33.7	3.4				
MYP40-471	40.0	3.4	★			
MYP53-471	53.0	3.4				
MYP32-511	32.0	3.8				
MYP34S-511	33.7	3.8				
MYP40-511	40.0	3.8	★			
MYP53-511	53.0	3.8				
MYP32-561	32.0	4.2				
MYP34S-561	33.7	4.2				
MYP40-561	40.0	4.2	★			
MYP53-561	53.0	4.2				
MYP32-621	32.0	4.6				
MYP34S-621	33.7	4.6				
MYP40-621	40.0	4.6	★			

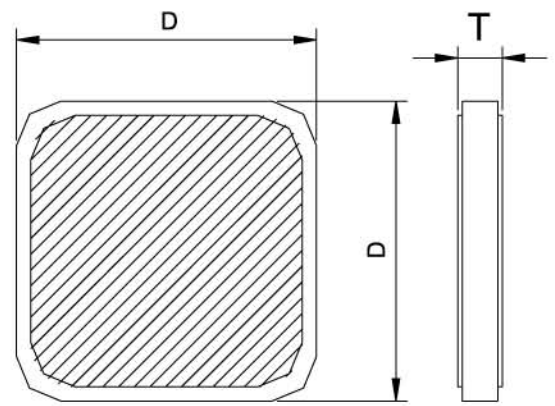
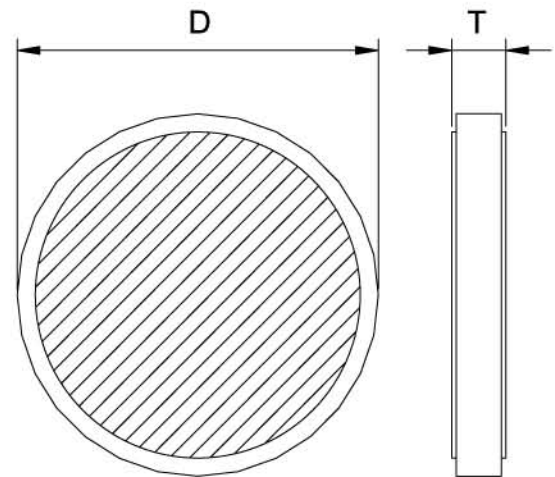

Type	Material code	Characteristics TA = +25 °C					Maximum ratings T =+85 C					V/I Characteristic curve	Derating curve
		Varistor voltage	Tolerance	Clamping voltage at I <sub>p</sub> (8/20µs)		Capacitance (1kHz)	Max continuous operating voltage		Max energy absorption (2ms)	Peak current (8/20µs)	Max power rating		
				V <sub>N</sub> (V)	ΔV <sub>N</sub> (±%)		V <sub>P</sub> (V)	I <sub>p</sub> (A)				C (pF)	V <sub>RMS</sub> (V)
MYP53-621	D53K385	620	10	1025	500	4600	385	505	1200	70000	1.5	80	82
MYP32-681	D32K420	680	10	1120	200	1300	420	560	600	25000	1.2	78	81
MYP34S-681	Q34K420	680	10	1120	300	2400	420	560	910	40000	1.4	79	81
MYP40-681	D40K420	680	10	1120	300	2600	420	560	910	40000	1.4	79	81
MYP53-681	D53K420	680	10	1120	500	4400	420	560	1500	70000	1.5	80	82
MYP32-751	D32K460	750	10	1240	200	1100	460	615	520	25000	1.2	78	81
MYP34S-751	Q34K460	750	10	1240	300	2200	460	615	960	40000	1.4	79	81
MYP40-751	D40K460	750	10	1240	300	2400	460	615	960	40000	1.4	79	81
MYP53-751	D53K460	750	10	1240	500	3900	460	615	1650	70000	1.5	80	82
MYP32-781	D32K485	780	10	1290	200	1100	485	640	550	25000	1.2	78	81
MYP34S-781	Q34K485	780	10	1290	300	2100	485	640	930	40000	1.4	79	81
MYP40-781	D40K485	780	10	1290	300	2270	485	640	930	40000	1.4	79	81
MYP53-781	D53K485	780	10	1290	500	3800	485	640	1248	70000	1.5	80	82
MYP32-821	D32K510	820	10	1355	200	1000	510	670	580	25000	1.2	78	81
MYP34S-821	Q34K510	820	10	1355	300	2000	510	670	940	40000	1.4	79	81
MYP40-821	D40K510	820	10	1355	300	2160	510	670	940	40000	1.4	79	81
MYP53-821	D53K510	820	10	1355	500	3500	510	670	1312	70000	1.5	80	82
MYP32-911	D32K550	910	10	1500	200	950	550	745	620	25000	1.2	78	81
MYP34S-911	Q34K550	910	10	1500	300	1800	550	745	960	40000	1.4	79	81
MYP40-911	D40K550	910	10	1500	300	1940	550	745	960	40000	1.4	79	81
MYP53-911	D53K550	910	10	1500	500	3300	550	745	1500	70000	1.5	80	82
MYP32-951	D32K580	950	10	1500	200	900	580	760	650	25000	1.2	78	81
MYP34S-951	Q34K580	950	10	1500	300	1700	580	760	1000	40000	1.4	79	81
MYP40-951	D40K580	950	10	1500	300	1800	580	760	1000	40000	1.4	79	81
MYP53-951	D53K580	950	10	1500	500	3100	580	760	1548	70000	1.5	80	82
MYP32-102	D32K625	1000	10	1650	200	840	625	825	680	25000	1.2	78	81
MYP34S-102	Q34K625	1000	10	1650	300	1600	625	825	1040	40000	1.4	79	81
MYP40-102	D40K625	1000	10	1650	300	1730	625	825	1040	40000	1.4	79	81
MYP53-102	D53K625	1000	10	1650	500	2900	625	825	1630	70000	1.5	80	82
MYP32-112	D32K680	1100	10	1815	200	770	680	895	760	25000	1.2	78	81
MYP34S-112	Q34K680	1100	10	1815	300	1500	680	895	1100	40000	1.4	79	81
MYP40-112	D40K680	1100	10	1815	300	1620	680	895	1100	40000	1.4	79	81
MYP53-112	D53K680	1100	10	1815	500	2700	680	895	1800	70000	1.5	80	82
MYP32-122	D32K750	1200	10	2000	200	690	750	970	800	25000	1.2	78	81
MYP34S-122	Q34K750	1200	10	2000	300	1300	750	970	1200	40000	1.4	79	81
MYP40-122	D40K750	1200	10	2000	300	1400	750	970	1200	40000	1.4	79	81
MYP53-122	D53K750	1200	10	2000	500	2400	750	970	1963	70000	1.5	80	82
MYP32-142	D32K880	1400	10	2290	200	590	880	1150	850	25000	1.2	78	81
MYP34S-142	Q34K880	1400	10	2290	300	1100	880	1150	1300	40000	1.4	79	81
MYP40-142	D40K880	1400	10	2290	300	1200	880	1150	1300	40000	1.4	79	81
MYP53-142	D53K880	1400	10	2290	500	2100	880	1150	2000	70000	1.5	80	82
MYP32-162	D32K900	1600	10	2550	200	520	900	1200	900	25000	1.2	78	81
MYP34S-162	Q34K900	1600	10	2550	300	1000	900	1200	1400	40000	1.4	79	81
MYP40-162	D40K900	1600	10	2550	300	1080	900	1200	1400	40000	1.4	79	81
MYP53-162	D53K900	1600	10	2550	500	1800	900	1200	2278	70000	1.5	80	82



Type	Dimensions		Certification			
	D $\pm$ 1.0 (mm)	T <sub>max</sub> (mm)	CE	UL	VDE	SF
MYP53-621	53.0	4.6				
MYP32-681	32.0	5.0				
MYP34S-681	33.7	5.0				
MYP40-681	40.0	5.0	★			
MYP53-681	53.0	5.0				
MYP32-751	32.0	5.2				
MYP34S-751	33.7	5.2				
MYP40-751	40.0	5.2	★			
MYP53-751	53.0	5.2				
MYP32-781	32.0	5.5				
MYP34S-781	33.7	5.5				
MYP40-781	40.0	5.5	★			
MYP53-781	53.0	5.5				
MYP32-821	32.0	6.1				
MYP34S-821	33.7	6.1				
MYP40-821	40.0	6.1	★			
MYP53-821	53.0	6.1				
MYP32-911	32.0	6.4				
MYP34S-911	33.7	6.4				
MYP40-911	40.0	6.4	★			
MYP53-911	53.0	6.4				
MYP32-951	32.0	6.7				
MYP34S-951	33.7	6.7				
MYP40-951	40.0	6.7	★			
MYP53-951	53.0	6.7				
MYP32-102	32.0	7.4				
MYP34S-102	33.7	7.4				
MYP40-102	40.0	7.4	★			
MYP53-102	53.0	7.4				
MYP32-112	32.0	8.0				
MYP34S-112	33.7	8.0				
MYP40-112	40.0	8.0	★			
MYP53-112	53.0	8.0				
MYP32-122	32.0	9.4				
MYP34S-122	33.7	9.4				
MYP40-122	40.0	9.4	★			
MYP53-122	53.0	9.4				
MYP32-142	32.0	10.7				
MYP34S-142	33.7	10.7				
MYP40-142	40.0	10.7	★			
MYP53-142	53.0	10.7				
MYP32-162	32.0	12.0				
MYP34S-162	33.7	12.0				
MYP40-162	40.0	12.0	★			
MYP53-162	53.0	12.0				

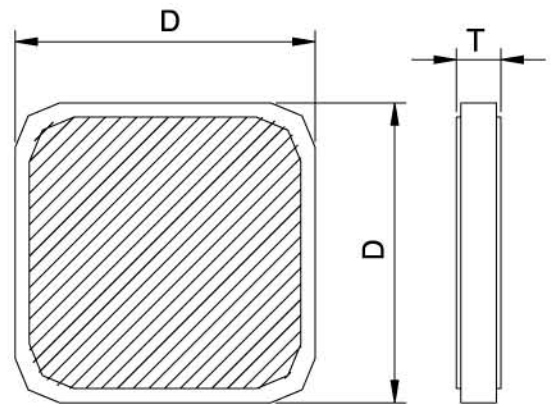
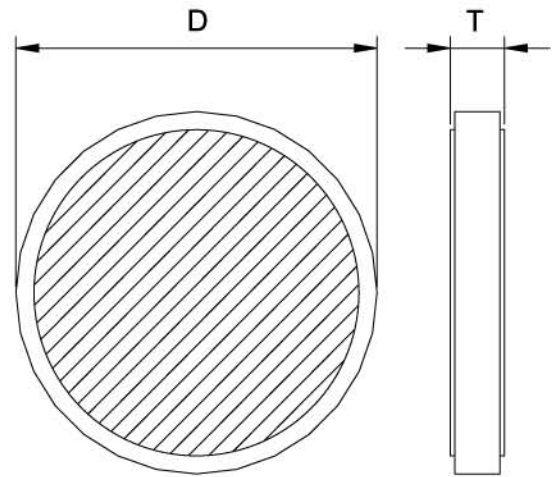

## Products Description:

Designed with reliable installation and flat electrodes of good heat exchange, PA varistor can be installed in situations with strong vibration or industrial electronic products with high power consumption. Flat electrodes are soldered with metallized disc, and potted in bakelite housing with non-flammable and insulating material. It is widely used in industrial automatic control equipment, power supply control, water supply system, petrolatum equipments, mining equipments, railway signal system, etc.



## Construction and Features:

- Construction: Flat electrode soldered with metallized disc potted and potting in bakelite housing;
- Potting materials: Potting with non-flammable, insulation and explosion protection potting resin-retardant to UL 94 V-0;
- Terminals: Tinned copper plate;
- Package: Box.

## Approvals:

With safety certifications of UL.

## Key Characteristic Parameters:

Max AC Operating Voltage	$V_{RMS}(V)$	50~1000
Max Energy Absorption	$W_{max}(J)$	40~720
Peak Current (8/20 $\mu$ s)	$I_{max}(kA)$	10
MOV Diameter	D(mm)	20

## Technical Data:

Characteristics	Parameters	Standards
Climatic Category	40/85/56	IEC68-2-3
LCT	-40 $^{\circ}C$	
UCT	+85 $^{\circ}C$	
Operating Temperature	-40 $^{\circ}C$ ~+85 $^{\circ}C$	CECC 42 000
Storage Temperature	-40 $^{\circ}C$ ~+110 $^{\circ}C$	
Electric Strength	$\geq 2500V(AC)$	CECC 42 000
Insulation Resistance	$\geq 10M\Omega$	CECC 42 000
Response Time	<25 ns	

## Type Designation:

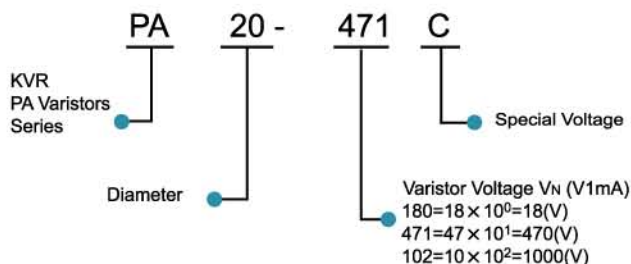

## Material Code Designation:

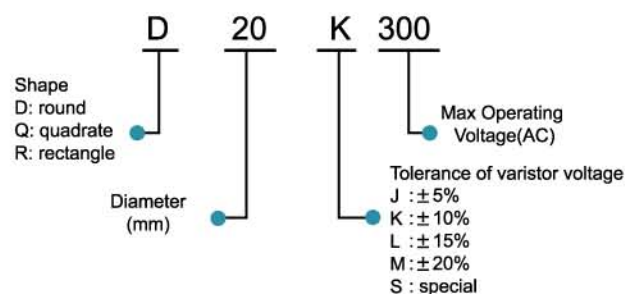



Type	Material code	Characteristics TA = +25 °C					Maximum ratings T =+85 C					V/I Characteristic curve	Derating curve
		Varistor voltage	Tolerance	Clamping voltage at Ip (8/20µs)		Capacitance (1kHz)	Max continuous operating voltage		Max energy absorption (2ms)	Peak current (8/20µs)	Max power rating		
				VN (V)	ΔVN (±%)		VP (V)	IP (A)				C (pF)	VRMS (V)
PA20-820	D20K50	82	10	140	100	8200	50	65	40	10000	1.0	86	87
PA20-101	D20K60	100	10	165	100	8000	60	81	50	10000	1.0	86	87
PA20-121	D20K75	120	10	200	100	5500	75	100	60	10000	1.0	86	87
PA20-151	D20K95	150	10	250	100	4200	95	125	75	10000	1.0	86	87
PA20-181	D20K115	180	10	300	100	2500	115	150	84	10000	1.0	86	87
PA20-201	D20K130	205	10	340	100	2300	130	170	100	10000	1.0	86	87
PA20-221	D20K140	220	10	360	100	2200	140	180	110	10000	1.0	86	87
PA20-241	D20K150	240	10	395	100	2200	150	200	120	10000	1.0	86	87
PA20-271	D20K175	270	10	455	100	2100	175	225	135	10000	1.0	86	87
PA20-301	D20K195	300	10	500	100	1800	195	250	148	10000	1.0	86	87
PA20-331	D20K210	330	10	550	100	1750	210	275	160	10000	1.0	86	87
PA20-361	D20K230	360	10	595	100	1700	230	300	180	10000	1.0	86	87
PA20-391	D20K250	390	10	650	100	1400	250	320	195	10000	1.0	86	87
PA20-431	D20K275	430	10	710	100	1350	275	350	215	10000	1.0	86	87
PA20-471	D20K300	470	10	775	100	1200	300	385	250	10000	1.0	86	87
PA20-511	D20K320	510	10	850	100	1050	320	410	273	10000	1.0	86	87
PA20-561	D20K350	560	10	915	100	850	350	460	273	10000	1.0	86	87
PA20-621	D20K385	620	10	1025	100	570	385	505	273	10000	1.0	86	87
PA20-681	D20K420	680	10	1120	100	550	420	560	273	10000	1.0	86	87
PA20-751	D20K460	750	10	1240	100	530	460	615	300	10000	1.0	86	87
PA20-821	D20K510	820	10	1355	100	530	510	670	325	10000	1.0	86	87
PA20-911	D20K550	910	10	1500	100	480	550	745	360	10000	1.0	86	87
PA20-102	D20K625	1000	10	1650	100	480	625	825	400	10000	1.0	86	87
PA20-112	D20K680	1100	10	1815	100	400	680	895	440	10000	1.0	86	87
PA20-182	D20K1000	1800	10	2970	100	250	1000	1465	720	10000	1.0	86	87

Type	Dimensions															Certification			
	A ±1.0 (mm)	B ±0.5 (mm)	b ±0.2 (mm)	b2 ±0.5 (mm)	C ±0.2 (mm)	D ±0.5 (mm)	D1 max (mm)	d ±0.5 (mm)	H max (mm)	h ±0.2 (mm)	J ±0.5 (mm)	P ±0.5 (mm)	Q ±0.5 (mm)	S ±0.5 (mm)	T ±0.2 (mm)	CE	FU	VDE	SB
PA20-820	13.9	8.8	6.5	4.0	12.8	63.5	33.5	2.8	24.7	1.0	8.0	5.8	50.8	18.5	1.0	★			
PA20-101	13.9	8.8	6.5	4.0	12.8	63.5	33.5	2.8	24.8	1.0	8.0	5.8	50.8	18.5	1.0	★			
PA20-121	13.9	8.8	6.5	4.0	12.8	63.5	33.5	2.8	24.9	1.0	8.0	5.8	50.8	18.5	1.0	★			
PA20-151	13.9	8.8	6.5	4.0	12.8	63.5	33.5	2.8	25.0	1.0	8.0	5.8	50.8	18.5	1.0	★			
PA20-181	13.9	8.8	6.5	4.0	12.8	63.5	33.5	2.8	25.2	1.0	8.0	5.8	50.8	18.5	1.0	★			
PA20-201	13.9	8.8	6.5	4.0	12.8	63.5	33.5	2.8	25.3	1.0	8.0	5.8	50.8	18.5	1.0	★			
PA20-221	13.9	8.8	6.5	4.0	12.8	63.5	33.5	2.8	25.4	1.0	8.0	5.8	50.8	18.5	1.0	★			
PA20-241	13.9	8.8	6.5	4.0	12.8	63.5	33.5	2.8	25.5	1.0	8.0	5.8	50.8	18.5	1.0	★			
PA20-271	13.9	8.8	6.5	4.0	12.8	63.5	33.5	2.8	25.7	1.0	8.0	5.8	50.8	18.5	1.0	★			
PA20-301	13.9	8.8	6.5	4.0	12.8	63.5	33.5	2.8	25.8	1.0	8.0	5.8	50.8	18.5	1.0	★			
PA20-331	13.9	8.8	6.5	4.0	12.8	63.5	33.5	2.8	26.0	1.0	8.0	5.8	50.8	18.5	1.0	★			
PA20-361	13.9	8.8	6.5	4.0	12.8	63.5	33.5	2.8	26.1	1.0	8.0	5.8	50.8	18.5	1.0	★			
PA20-391	13.9	8.8	6.5	4.0	12.8	63.5	33.5	2.8	26.3	1.0	8.0	5.8	50.8	18.5	1.0	★			
PA20-431	13.9	8.8	6.5	4.0	12.8	63.5	33.5	2.8	26.4	1.0	8.0	5.8	50.8	18.5	1.0	★			
PA20-471	13.9	8.8	6.5	4.0	12.8	63.5	33.5	2.8	26.6	1.0	8.0	5.8	50.8	18.5	1.0	★			
PA20-511	13.9	8.8	6.5	4.0	12.8	63.5	33.5	2.8	26.8	1.0	8.0	5.8	50.8	18.5	1.0	★			
PA20-561	13.9	8.8	6.5	4.0	12.8	63.5	33.5	2.8	27.0	1.0	8.0	5.8	50.8	18.5	1.0	★			
PA20-621	13.9	8.8	6.5	4.0	12.8	63.5	33.5	2.8	27.3	1.0	8.0	5.8	50.8	18.5	1.0	★			
PA20-681	13.9	8.8	6.5	4.0	12.8	63.5	33.5	2.8	27.6	1.0	8.0	5.8	50.8	18.5	1.0	★			
PA20-751	13.9	8.8	6.5	4.0	12.8	63.5	33.5	2.8	27.9	1.0	8.0	5.8	50.8	18.5	1.0	★			
PA20-821	13.9	8.8	6.5	4.0	12.8	63.5	33.5	2.8	28.3	1.0	8.0	5.8	50.8	18.5	1.0	★			
PA20-911	13.9	8.8	6.5	4.0	12.8	63.5	33.5	2.8	28.7	1.0	8.0	5.8	50.8	18.5	1.0	★			
PA20-102	13.9	8.8	6.5	4.0	12.8	63.5	33.5	2.8	29.1	1.0	8.0	5.8	50.8	18.5	1.0	★			
PA20-112	13.9	8.8	6.5	4.0	12.8	63.5	33.5	2.8	29.6	1.0	8.0	5.8	50.8	18.5	1.0	★			
PA20-182	13.9	8.8	6.5	4.0	12.8	63.5	33.5	2.8	32.9	1.0	8.0	5.8	50.8	18.5	1.0	★			

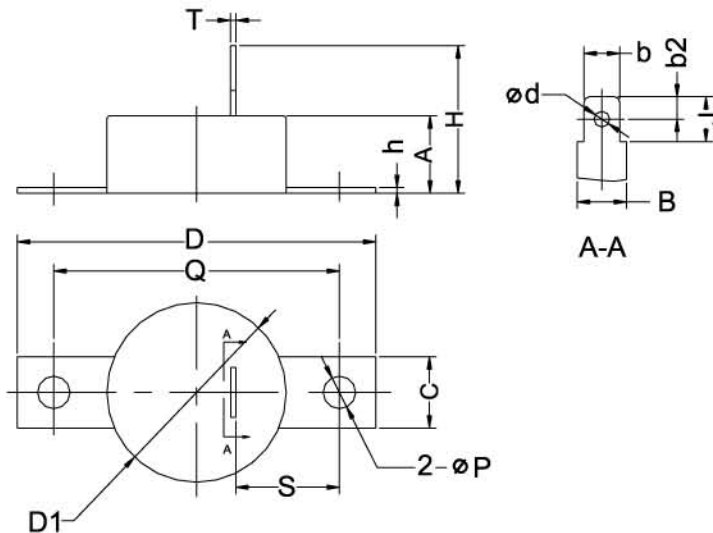



## Products Description:

TMOV temperature fuse varistor is a type with over temperature cut-off functions. A temperature fuse is connected with MOV in serie. When the operating current increasing continuously or MOV failuer, the temperature fuse will be cut-off because of temperatuer over the limit. Which make the current to MOV cut-off, and the temperature of MOV would not increase further, thereby prevent from fires caused by MOV failure. It adopts standard leads as outlet terminals, very suitable to be installed on PCBs. TMOV can be widely used in computer switching power supply, Power socket, UPS, telecommunication, network, railway, etc.



## Construction and Features:

- Construction: Round varistors element,connected with a temperature fuse, leaded and coated;
- Coating materials: Epoxy resin, flame retardant to UL94V-0;
- Terminals: Tinned copper wire;
- Package : Bulk.

## Key Characteristic Parameters:

Max AC Operating Voltage	$V_{RMS}(V)$	50~680
Max Energy Absorption	$W_{max}(J)$	40~760
Peak Current (8/20 $\mu$ s)	$I_{max}(kA)$	8~20
MOV Diameter	D(mm)	20~32

## Technical Data:

Characteristics	Parameters	Standards
Climatic Category	40/85/56	
LCT	-40 $^{\circ}C$	
UCT	+85 $^{\circ}C$	IEC68-2-3
Operating Temperature	-40 $^{\circ}C$ ~+85 $^{\circ}C$	CECC 42 000
Storage Temperature	-40 $^{\circ}C$ ~+100 $^{\circ}C$	
Electric Strength	$\geq 2500V(AC)$	CECC 42 000
Insulation Resistance	$\geq 10M\Omega$	CECC 42 000
Response Time	<25 ns	

## Type Designation:

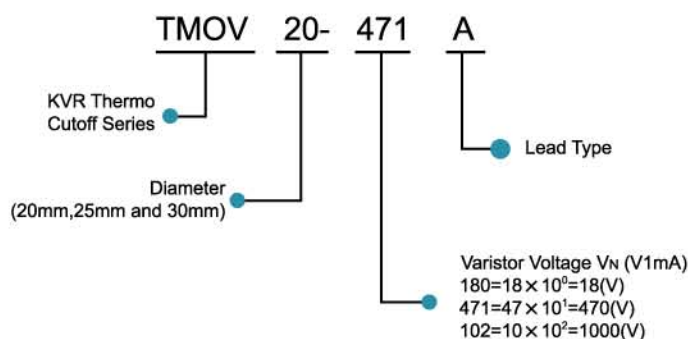

## Material Code Designation:

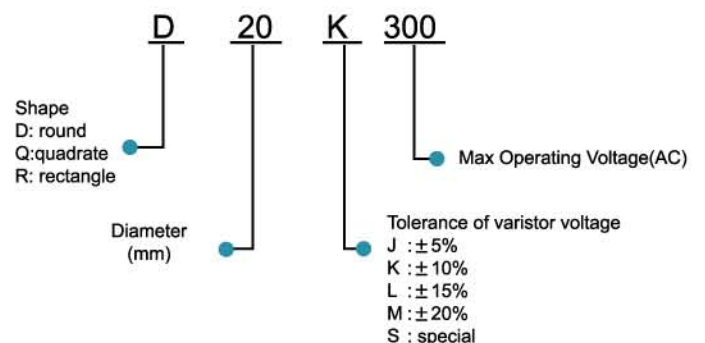

# TMOV Series

Catalogue Album of product



Type	Material code	Characteristics TA=+25°C					Maximum ratings T =+85 C					V/I Characteristic curve	Derating curve
		Varistor voltage	Tolerance	Clamping voltage at I <sub>p</sub> (8/20μs)		Capacitance (1kHz)	Max continuous operating voltage		Max energy absorption (2ms)	Peak current (8/20μs)	Max power rating		
				V <sub>N</sub> (V)	ΔV <sub>N</sub> (±%)		V <sub>P</sub> (V)	I <sub>p</sub> (A)				C (pF)	V <sub>RMS</sub> (V)
TMOV20-820	D20K50	82	10	135	100	8200	50	65	40	10000	1.0	93	96
TMOV20-101	D20K60	100	10	165	100	8000	60	81	50	10000	1.0	93	96
TMOV20-121	D20K75	120	10	200	100	5500	75	100	60	10000	1.0	93	96
TMOV20-151	D20K95	150	10	250	100	4200	95	125	75	10000	1.0	93	96
TMOV20-181	D20K115	180	10	300	100	2500	115	150	84	10000	1.0	93	96
TMOV20-201	D20K130	205	10	340	100	2300	130	170	100	10000	1.0	93	96
TMOV25-201	D25K130	205	10	340	150	3700	130	170	150	15000	1.0	94	96
TMOV32-201	D32K130	205	10	340	200	4100	130	170	210	25000	1.2	95	97
TMOV20-221	D20K140	220	10	360	100	2200	140	180	110	10000	1.0	93	96
TMOV25-221	D25K140	220	10	360	150	3400	140	180	155	15000	1.0	94	96
TMOV32-221	D32K140	220	10	360	200	3700	140	180	225	25000	1.2	95	97
TMOV20-241	D20K150	240	10	395	100	2200	150	200	120	10000	1.0	93	96
TMOV25-241	D25K150	240	10	395	150	3100	150	200	160	15000	1.0	94	96
TMOV32-241	D32K150	240	10	395	200	3400	150	200	240	25000	1.2	95	97
TMOV20-271	D20K175	270	10	455	100	2100	175	225	135	10000	1.0	93	96
TMOV25-271	D25K175	270	10	455	150	2600	175	225	170	15000	1.0	94	96
TMOV32-271	D32K175	270	10	455	200	2900	175	225	250	25000	1.2	95	97
TMOV20-331	D20K210	330	10	550	100	1750	210	275	160	10000	1.0	93	96
TMOV25-331	D25K210	330	10	550	150	2200	210	275	180	15000	1.0	94	96
TMOV32-331	D32K210	330	10	550	200	2600	210	275	270	25000	1.2	95	97
TMOV20-361	D20K230	360	10	595	100	1700	230	300	180	10000	1.0	93	96
TMOV25-361	D25K230	360	10	595	150	2100	230	300	190	15000	1.0	94	96
TMOV32-361	D32K230	360	10	595	200	2300	230	300	300	25000	1.2	95	97
TMOV20-391	D20K250	390	10	650	100	1400	250	320	195	10000	1.0	93	96
TMOV25-391	D25K250	390	10	650	150	1900	250	320	210	15000	1.0	94	96
TMOV32-391	D32K250	390	10	650	200	2100	250	320	330	25000	1.2	95	97
TMOV20-431	D20K275	430	10	710	100	1350	275	350	215	10000	1.0	93	96
TMOV25-431	D25K275	430	10	710	150	1800	275	350	230	15000	1.0	94	96
TMOV32-431	D32K275	430	10	710	200	2000	275	350	360	25000	1.2	95	97
TMOV20-471	D20K300	470	10	775	100	1200	300	385	250	10000	1.0	93	96
TMOV25-471	D25K300	470	10	775	150	1600	300	385	240	15000	1.0	94	96
TMOV32-471	D32K300	470	10	775	200	1700	300	385	380	25000	1.2	95	97
TMOV20-511	D20K320	510	10	845	100	1050	320	410	273	10000	1.0	93	96
TMOV25-511	D25K320	510	10	840	150	1500	320	410	275	15000	1.0	94	96
TMOV32-511	D32K320	510	10	840	200	1600	320	410	430	25000	1.2	95	97
TMOV20-561	D20K350	560	10	915	100	850	350	460	273	10000	1.0	93	96
TMOV25-561	D25K350	560	10	915	150	1300	350	460	300	15000	1.0	94	96
TMOV32-561	D32K350	560	10	915	200	1400	350	460	490	25000	1.2	95	97
TMOV20-621	D20K385	620	10	1025	100	570	385	505	273	10000	1.0	93	96
TMOV25-621	D25K385	620	10	1025	150	1200	385	505	320	15000	1.0	94	96
TMOV32-621	D32K385	620	10	1025	200	1300	385	505	550	25000	1.2	95	97
TMOV20-681	D20K420	680	10	1120	100	550	420	560	273	10000	1.0	93	96
TMOV25-681	D25K420	680	10	1120	150	1100	420	560	360	15000	1.0	94	96
TMOV32-681	D32K420	680	10	1120	200	1300	420	560	600	25000	1.2	95	97
TMOV20-751	D20K460	750	10	1240	100	530	460	615	300	10000	1.0	93	96
TMOV25-751	D25K460	750	10	1240	150	1000	460	615	390	15000	1.0	94	96
TMOV32-751	D32K460	750	10	1240	200	1100	460	615	520	25000	1.2	95	97



Type	Dimensions											Certification			
	D <sub>max</sub> (mm)	H <sub>2max</sub> (mm)	T <sub>max</sub> (mm)	W1±1.0 (mm)	W2±1.0 (mm)	L <sub>min</sub> (mm)	l <sub>min</sub> (mm)	e1 <sub>max</sub> (mm)	e2 <sub>max</sub> (mm)	d1±0.1 (mm)	d2±0.1 (mm)	CE	UL	VDE	CCC
TMOV20-820	25.0	29.0	8.6	7.5	4.0	20.0	15.0	1.8	3.3	1.0	0.8				
TMOV20-101	25.0	29.0	8.6	7.5	4.0	20.0	15.0	1.8	3.3	1.0	0.8				
TMOV20-121	25.0	29.0	8.6	7.5	4.0	20.0	15.0	1.9	3.4	1.0	0.8				
TMOV20-151	25.0	29.0	8.6	7.5	4.0	20.0	15.0	1.9	3.4	1.0	0.8				
TMOV20-181	25.0	29.0	8.6	7.5	4.0	20.0	15.0	1.9	3.4	1.0	0.8				
TMOV20-201	25.0	29.0	8.9	7.5	4.0	20.0	15.0	2.0	3.6	1.0	0.8				
TMOV25-201	29.0	33.0	8.9	10.0	5.0	20.0	15.0	2.1	3.7	1.0	1.0				
TMOV32-201	36.0	41.0	8.9	12.0	6.0	20.0	15.0	2.6	4.1	1.2	1.5				
TMOV20-221	25.0	29.0	9.1	7.5	4.0	20.0	15.0	2.1	3.7	1.0	0.8				
TMOV25-221	29.0	33.0	9.2	10.0	5.0	20.0	15.0	2.2	3.8	1.0	1.0				
TMOV32-221	36.0	41.0	9.2	12.0	6.0	20.0	15.0	2.7	4.2	1.2	1.5				
TMOV20-241	25.0	29.0	9.2	7.5	4.0	20.0	15.0	2.2	3.8	1.0	0.8				
TMOV25-241	29.0	33.0	9.3	10.0	5.0	20.0	15.0	2.3	3.9	1.0	1.0				
TMOV32-241	36.0	41.0	9.3	12.0	6.0	20.0	15.0	2.8	4.3	1.2	1.5				
TMOV20-271	25.0	29.0	9.3	7.5	4.0	20.0	15.0	2.3	3.9	1.0	0.8				
TMOV25-271	29.0	33.0	9.4	10.0	5.0	20.0	15.0	2.4	4.0	1.0	1.0				
TMOV32-271	36.0	41.0	9.5	12.0	6.0	20.0	15.0	2.9	4.4	1.2	1.6				
TMOV20-331	25.0	29.0	9.5	7.5	4.0	20.0	15.0	2.7	4.3	1.0	0.8				
TMOV25-331	29.0	33.0	9.8	10.0	5.0	20.0	15.0	2.8	4.4	1.0	1.0				
TMOV32-331	36.0	41.0	10.0	12.0	6.0	20.0	15.0	3.3	4.8	1.2	1.5				
TMOV20-361	25.0	29.0	9.6	7.5	4.0	20.0	15.0	2.8	4.4	1.0	0.8				
TMOV25-361	29.0	33.0	9.9	10.0	5.0	20.0	15.0	2.9	4.5	1.0	1.0				
TMOV32-361	36.0	41.0	10.0	12.0	6.0	20.0	15.0	3.5	5.0	1.2	1.5				
TMOV20-391	25.0	29.0	9.7	7.5	4.0	20.0	15.0	3.0	4.6	1.0	0.8				
TMOV25-391	29.0	33.0	10.0	10.0	5.0	20.0	15.0	3.1	4.7	1.0	1.0				
TMOV32-391	36.0	41.0	10.0	12.0	6.0	20.0	15.0	3.6	5.1	1.2	1.5				
TMOV20-431	25.0	29.0	9.8	7.5	4.0	20.0	15.0	3.2	4.8	1.0	0.8				
TMOV25-431	29.0	33.0	10.2	10.0	5.0	20.0	15.0	3.3	4.9	1.0	1.0				
TMOV32-431	36.0	41.0	10.2	12.0	6.0	20.0	15.0	3.8	5.3	1.2	1.5				
TMOV20-471	25.0	29.0	10.1	7.5	4.0	20.0	15.0	3.4	5.1	1.0	0.8				
TMOV25-471	29.0	33.0	10.5	10.0	5.0	20.0	15.0	3.5	5.2	1.0	1.0				
TMOV32-471	36.0	41.0	10.7	12.0	6.0	20.0	15.0	4.0	5.5	1.2	1.5				
TMOV20-511	25.0	29.0	10.5	7.5	4.0	20.0	15.0	3.6	5.4	1.0	0.8				
TMOV25-511	29.0	33.0	10.9	10.0	5.0	20.0	15.0	3.7	5.5	1.0	1.0				
TMOV32-511	36.0	41.0	10.9	12.0	6.0	20.0	15.0	4.3	5.8	1.2	1.5				
TMOV20-561	25.0	29.0	10.7	7.5	4.0	20.0	15.0	3.8	5.6	1.0	0.8				
TMOV25-561	29.0	33.0	11.1	10.0	5.0	20.0	15.0	3.9	5.7	1.0	1.0				
TMOV32-561	36.0	41.0	11.3	12.0	6.0	20.0	15.0	4.9	6.4	1.2	1.5				
TMOV20-621	25.0	29.0	11.1	7.5	4.0	20.0	15.0	4.1	5.9	1.0	0.8				
TMOV25-621	29.0	33.0	11.4	10.0	5.0	20.0	15.0	4.2	6.0	1.0	1.0				
TMOV32-621	36.0	41.0	11.4	12.0	6.0	20.0	15.0	4.9	6.4	1.2	1.5				
TMOV20-681	25.0	29.0	11.4	7.5	4.0	20.0	15.0	4.4	6.2	1.0	0.8				
TMOV25-681	29.0	33.0	11.7	10.0	5.0	20.0	15.0	4.5	6.3	1.0	1.0				
TMOV32-681	36.0	41.0	11.7	12.0	6.0	20.0	15.0	5.1	6.6	1.2	1.5				
TMOV20-751	25.0	29.0	11.7	7.5	4.0	20.0	15.0	4.7	6.6	1.0	0.8				
TMOV25-751	29.0	33.0	12.2	10.0	5.0	20.0	15.0	4.8	6.7	1.0	1.0				
TMOV32-751	36.0	41.0	12.1	12.0	6.0	20.0	15.0	5.5	7.0	1.2	1.5				

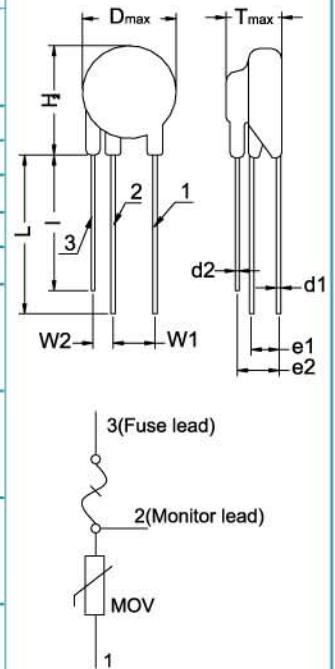

Type	Material code	Characteristics TA = +25 °C					Maximum ratings T =+85 C					V/I Characteristic curve	Derating curve
		Varistor voltage	Tolerance	Clamping voltage at Ip (8/20µs)		Capacitance (1kHz)	Max continuous operating voltage		Max energy absorption (2ms)	Peak current (8/20µs)	Max power rating		
				VN (V)	ΔVN (±%)		Vp (V)	Ip (A)				C (pF)	V <sub>RMS</sub> (V)
TMOV20-781	D20K485	780	10	1290	100	530	485	640	315	10000	1.0	93	96
TMOV25-781	D25K485	780	10	1290	150	990	485	640	397	15000	1.0	94	96
TMOV32-781	D32K485	780	10	1290	200	1100	485	640	550	25000	1.2	95	97
TMOV20-821	D20K510	820	10	1355	100	530	510	670	325	10000	1.0	93	96
TMOV25-821	D25K510	820	10	1355	150	930	510	670	410	15000	1.0	94	96
TMOV32-821	D32K510	820	10	1355	200	1000	510	670	580	25000	1.2	95	97
TMOV20-911	D20K550	910	10	1500	100	480	550	745	360	10000	1.0	93	96
TMOV25-911	D25K550	910	10	1500	150	860	550	745	425	15000	1.0	94	96
TMOV32-911	D32K550	910	10	1500	200	950	550	745	620	25000	1.2	95	97
TMOV20-102	D20K625	1000	10	1650	100	480	625	825	400	7500	1.0	93	96
TMOV25-102	D25K625	1000	10	1650	150	760	625	825	480	15000	1.0	94	96
TMOV32-102	D32K625	1000	10	1650	200	840	625	825	680	25000	1.2	95	97
TMOV20-112	D20K680	1100	10	1815	100	400	680	895	440	7500	1.0	93	96
TMOV25-112	D25K680	1100	10	1815	150	690	680	895	525	15000	1.0	94	96
TMOV32-112	D32K680	1100	10	1815	200	770	680	895	760	25000	1.2	95	97

Type	Dimensions											Certification				
	D <sub>max</sub> (mm)	H <sub>2max</sub> (mm)	T <sub>max</sub> (mm)	W <sub>1</sub> ±1.0 (mm)	W <sub>2</sub> ±1.0 (mm)	L <sub>min</sub> (mm)	l <sub>min</sub> (mm)	e <sub>1max</sub> (mm)	e <sub>2max</sub> (mm)	d <sub>1</sub> ±0.1 (mm)	d <sub>2</sub> ±0.1 (mm)	CE	UL	VDE	SP	
TMOV20-781	25.0	29.0	11.9	7.5	4.0	20.0	15.0	4.9	6.8	1.0	0.8					
TMOV25-781	29.0	33.0	12.3	10.0	5.0	20.0	15.0	5.0	6.9	1.0	1.0					
TMOV32-781	36.0	41.0	12.3	12.0	6.0	20.0	15.0	5.7	7.2	1.2	1.5					
TMOV20-821	25.0	29.0	12.0	7.5	4.0	20.0	15.0	5.1	7.0	1.0	0.8					
TMOV25-821	29.0	33.0	12.4	10.0	5.0	20.0	15.0	5.2	7.1	1.0	1.0					
TMOV32-821	36.0	41.0	12.4	12.0	6.0	20.0	15.0	6.0	7.5	1.2	1.5					
TMOV20-911	25.0	29.0	12.5	7.5	4.0	20.0	15.0	5.5	7.5	1.0	0.8					
TMOV25-911	29.0	33.0	12.8	10.0	5.0	20.0	15.0	5.6	7.6	1.0	1.0					
TMOV32-911	36.0	41.0	12.8	12.0	6.0	20.0	15.0	6.5	8.0	1.2	1.5					
TMOV20-102	25.0	29.0	13.0	7.5	4.0	20.0	15.0	6.0	8.0	1.0	0.8					
TMOV25-102	29.0	33.0	13.4	10.0	5.0	20.0	15.0	6.1	8.1	1.0	1.0					
TMOV32-102	36.0	41.0	13.4	12.0	6.0	20.0	15.0	7.0	8.5	1.2	1.5					
TMOV20-112	25.0	29.0	13.2	7.5	4.0	20.0	15.0	6.5	8.6	1.0	0.8					
TMOV25-112	29.0	33.0	13.6	10.0	5.0	20.0	15.0	6.6	8.7	1.0	1.0					
TMOV32-112	36.0	41.0	13.6	12.0	6.0	20.0	15.0	7.1	8.6	1.2	1.5					